



FULLER STREET, HENDON, LONDON, NW4  
**£535,000 FREEHOLD**

## BRIGHT AND SPACIOUS 3-BEDROOM FAMILY HOME IN HENDON - CHAIN FREE!

Hendon | 020 8202 1031 | [hendon@winkworth.co.uk](mailto:hendon@winkworth.co.uk)

**Winkworth**

for every step...

[winkworth.co.uk](http://winkworth.co.uk)



## DESCRIPTION:

Welcome to this bright and inviting 3-bedroom property, offering a fantastic opportunity for minor updates to make it your own. Spread across two levels, this home boasts ample space for families looking to create their dream residences.

The spacious kitchen features a charming side dining area, perfect for family meals and entertaining guests. Step outside to discover a large garden, complete with stunning views and serene surroundings—an ideal retreat for relaxation and outdoor activities.

Located in Hendon, you'll find an array of shops, cafés, and restaurants just a short stroll away, ensuring convenience at your fingertips. Hendon Central Underground Station (Northern Line) is also nearby, providing easy access to the city.

This property is chain-free, making it a seamless option for buyers. It's a wonderful canvas for those looking to add a personal touch while enjoying the comforts of a well-maintained home. Don't miss out on this exceptional opportunity!



**Winkworth**

for every step...



**Winkworth**

for every step...

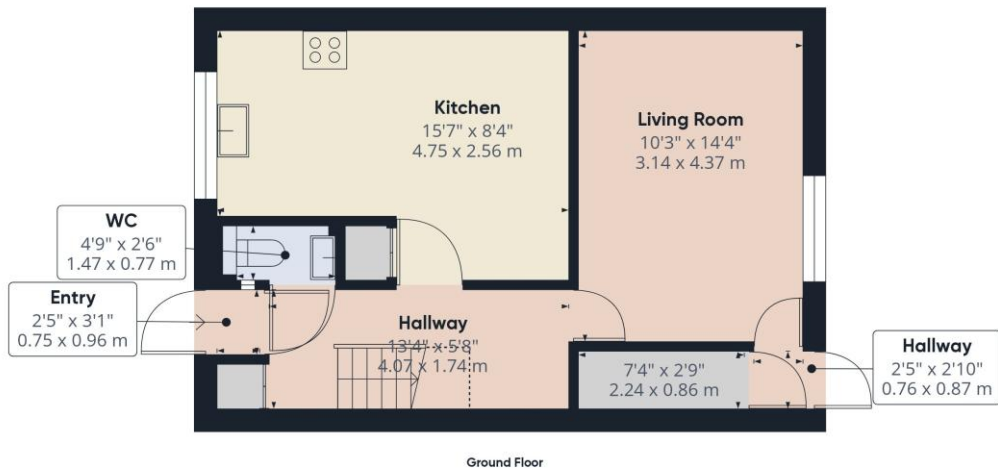

Ground Floor

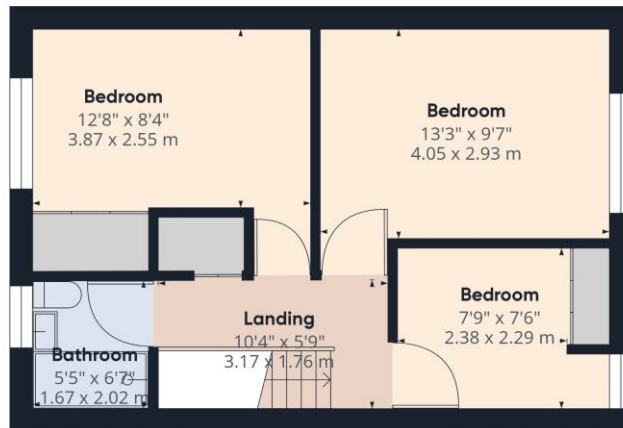

Floor 1

**Approximate total area<sup>(1)</sup>**  
 865.85 ft<sup>2</sup>  
 80.44 m<sup>2</sup>

**Reduced headroom**  
 16.04 ft<sup>2</sup>  
 1.49 m<sup>2</sup>

(1) Excluding balconies and terraces

Reduced headroom  
 ..... Below 5 ft/1.5 m

While every attempt has been made to ensure accuracy, all measurements are approximate, not to scale. This floor plan is for illustrative purposes only.  
 Calculations are based on RICS IPMS 3C standard.

GIRAFFE360

This floorplan is for illustration purposes only and is not to scale. The position and size of doors, windows, appliances and other features are approximate.

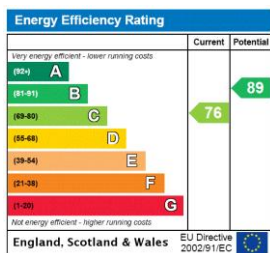

**Tenure:** Freehold

**Council Tax Band:** D

Where no figures are shown, we have been unable to ascertain the information. All figures that are shown were correct at the time of printing.

Hendon | 020 8202 1031 | hendon@winkworth.co.uk

**Winkworth**

for every step...

winkworth.co.uk

Winkworth wishes to inform prospective buyers and tenants that these particulars are a guide and act as information only. All our details are given in good faith and believed to be correct at the time of printing but they don't form part of an offer or contract. No Winkworth employee has authority to make or give any representation or warranty in relation to this property. All fixtures and fittings, whether fitted or not are deemed removable by the vendor unless stated otherwise and room sizes are measured between internal wall surfaces, including furnishings.