



CANONBURY COURT, HAWES STREET, LONDON, N1
£375,000 LEASEHOLD

A SPACIOUS 586 SQ.FT. ONE DOUBLE BEDROOM FLAT 0.3 MILES FROM ESSEX ROAD STATION

Islington | 0207 354 2480 | islington@winkworth.co.uk

Winkworth



DESCRIPTION:

Standing at 586 sq. ft. the flat provides a comfortable living space in a well-connected area, with shops, cafes, and restaurants nearby. The flat is located on the third floor in a small purpose built block the comprises of a large reception room which receives lots of natural light, spacious bedroom, separate kitchen, bathroom with a bathtub and extra storage.

The property is situated on a quiet residential street that is conveniently located 0.1 from Upper Street, offering easy access to a variety of local amenities and transport links. Highbury & Islington station is nearby, and the property is offered mostly furnished it is ideal for a professional couple due to its excellent size and finish.

Winkworth



Winkworth

Canonbury Court, Hawes Street, N1
 Approx. Gross Internal Floor Area 586 sq. ft / 54.46 sq. m

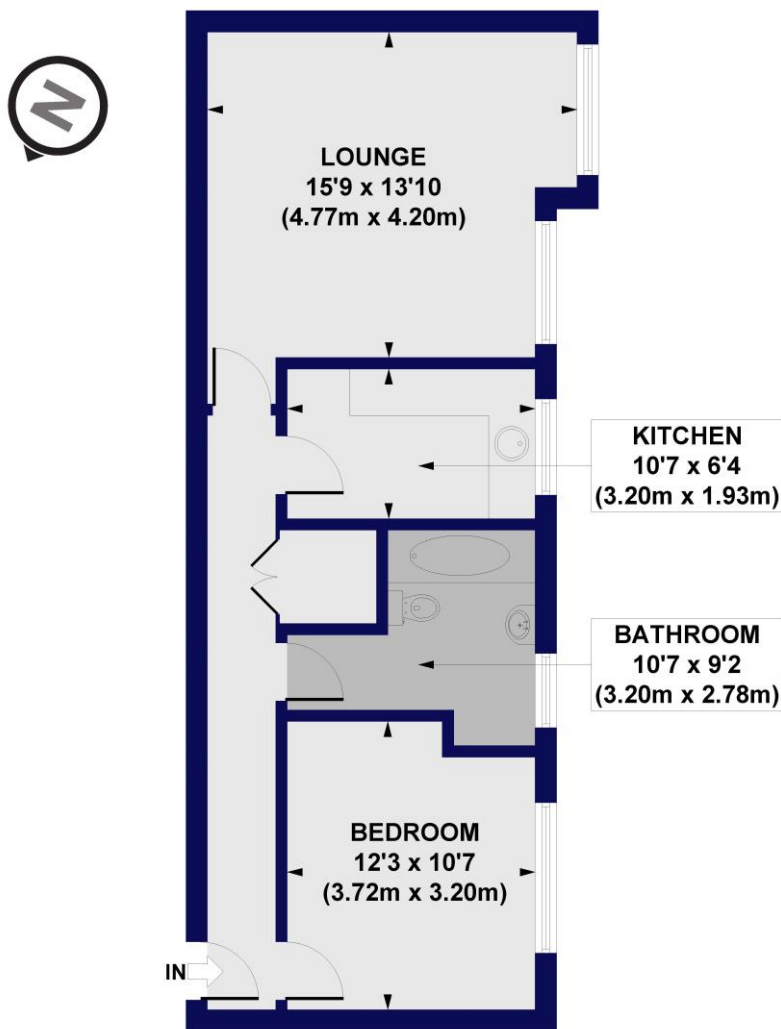

THIRD FLOOR

All measurements of walls, doors, windows, fittings and appliances, including their size and location, are shown as standard sizes and do not constitute any warranty or representation by the seller, their agent or CP Creative. Any intending purchaser must satisfy himself by inspection or otherwise as to the correctness of the information contained in these plans. This plan is for illustrative purposes only and should be used as such by any prospective purchasers.



This floorplan is for illustration purposes only and is not to scale. The position and size of doors, windows, appliances and other features are approximate.

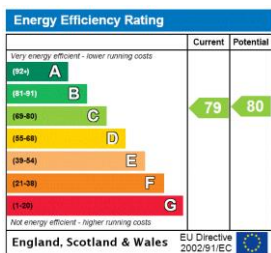

Islington | 0207 354 2480 | islington@winkworth.co.uk



winkworth.co.uk

See things differently

Winkworth wishes to inform prospective buyers and tenants that these particulars are a guide and act as information only. All our details are given in good faith and believed to be correct at the time of printing but they don't form part of an offer or contract. No Winkworth employee has authority to make or give any representation or warranty in relation to this property. All fixtures and fittings, whether fitted or not are deemed removable by the vendor unless stated otherwise and room sizes are measured between internal wall surfaces, including furnishings.