



TOTTENHALL ROAD, N13
£600,000 FREEHOLD

A SPACIOUS THREE BEDROOM PERIOD
HOUSE IN A CONVENIENT LOCATION.

Palmers Green | 020 8920 9900 | palmersgreen@winkworth.co.uk

Winkworth

for every step...

winkworth.co.uk



DESCRIPTION:

A charming three-bedroom period house in a convenient location, a short stroll to the vibrant Green Lanes, with easy access to a bus service to Wood Green tube station (Piccadilly line) and the shopping centre, as well as Palmers Green rail station (to Moorgate). The location is also close to the popular Tottenham Infant school and St. Michael at Bowes Church of England school. Offered for sale chain-free, the property enjoys 1130 Sq.ft of well-proportioned living accommodation with high ceilings.

The ground floor provides a spacious front reception room with a feature fireplace, a dining room with a character fireplace, and an opening leading to the kitchen fitted with contemporary units. There is also a useful bathroom at the rear of the house. A spacious landing on the first floor guides to a shower room and three generously sized bedrooms, each with fitted wardrobes. Outside, the property benefits from a low-maintenance rear garden with decking, plus a front garden.

Council Tax: London Borough of Enfield - Band E



Tottenham Road, N13
Approx. Gross Internal Floor Area 1130 sq. ft / 105.03 sq. m

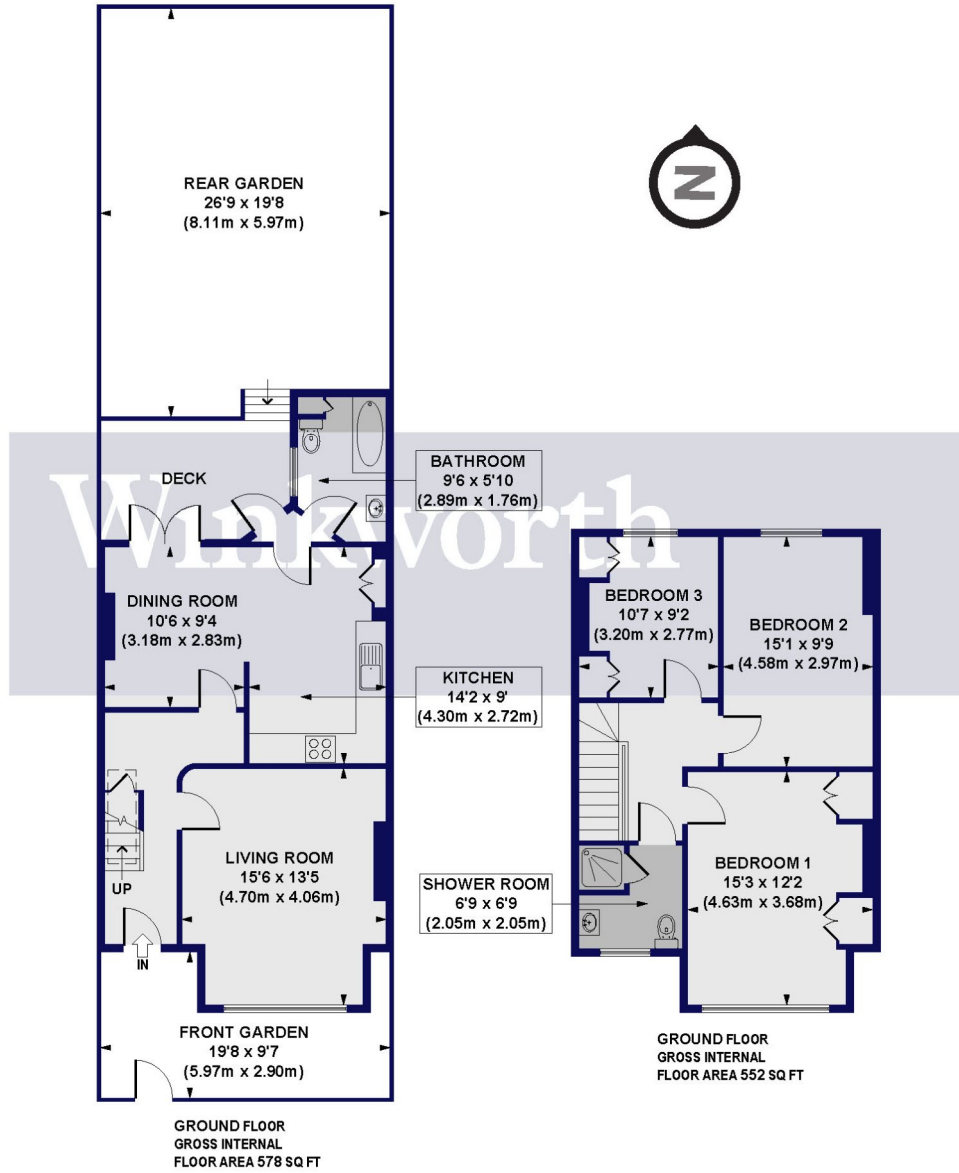

All measurements of walls, doors, windows, fittings and appliances, including their size and location, are shown as standard sizes and do not constitute any warranty or representation by the seller, their agent or CP Creative. Any intending purchaser must satisfy himself by inspection or otherwise as to the correctness of the information contained in these plans.

This floorplan is for illustration purposes only and is not to scale. The position and size of doors, windows, appliances and other features are approximate.

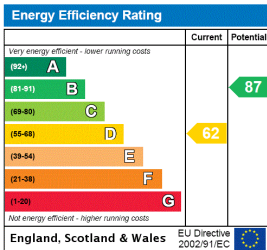

Palmer's Green | 020 8920 9900 | palmer'sgreen@winkworth.co.uk

for every step...

winkworth.co.uk

Winkworth wishes to inform prospective buyers and tenants that these particulars are a guide and act as information only. All our details are given in good faith and believed to be correct at the time of printing but they don't form part of an offer or contract. No Winkworth employee has authority to make or give any representation or warranty in relation to this property. All fixtures and fittings, whether fitted or not are deemed removable by the vendor unless stated otherwise and room sizes are measured between internal wall surfaces, including furnishings.