



Flat 8, The Grove, 12 Beaufoys Avenue
Ferndown BH22 9FZ
GUIDE PRICE £270,000





GUIDE PRICE £270,000
SHARE OF FREEHOLD

Immaculate two double bedroom, two bathroom first floor apartment (with lift) located on the popular Beaufoys Avenue in Ferndown. Further benefits to the property include underfloor heating to all rooms which have individual thermostatic controls. There is a Juliette balcony overlooking picturesque well maintained communal grounds, an allocated off road parking space and outside storage shed for each flat along with communal bike and bin stores.

Two Double Bedrooms
First Floor Flat With Lift
Two Bathrooms
Underfloor Heating
Allocated Off Road Parking
External Storage Unit
Sought After Location
Communal Garden
Lounge/Diner Separate Kitchen
Share Of Freehold (999 yrs lease)
£189 pm Maintenance Charge

EPC TBC | Council Tax Band D

01202 434365

ferndown@winkworth.co.uk



The Grove

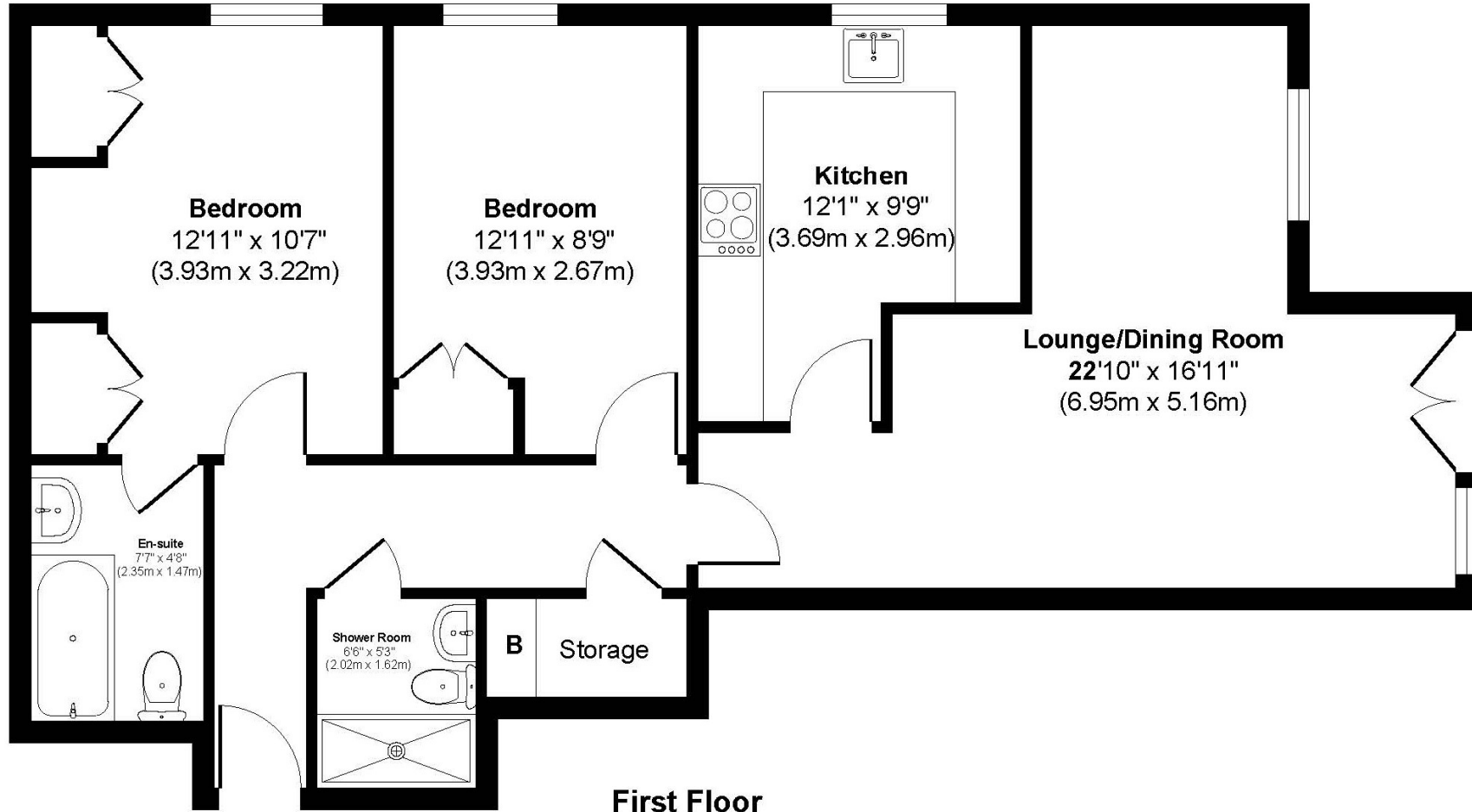

First Floor

Approx. Gross Internal Floor Area 771 sq. ft / 71.67 sq. m
Illustration for identification purposes only, measurements approximate, not to scale.



LOCATION

Beaufoy's Avenue is a very desirable residential location just a short walk from Ferndown town centre, within catchment of Ferndown Schools and close to a range of amenities including an M&S Food Hall. There are bus routes within a short walk giving you easy access to Bournemouth, Poole and Wimborne, all of which have an excellent range of shops, bars, restaurants and leisure facilities. Award winning sandy beaches are just twenty minutes away and the nearby A31 provides quick access to the New Forest, Southampton, London and beyond for the commuter by car.

Winkworth Ferndown

406 Ringwood Road, Ferndown, Dorset, BH22 9AU

01202 434365 | ferndown@winkworth.co.uk

winkworth.co.uk/ferndown

Winkworth