



BEALE CLOSE, N13
£265,000 LEASEHOLD

IDEAL BUY-TO-LET OPPORTUNITY – SPACIOUS TWO-BEDROOM FLAT IN A POPULAR LOCATION IN EASY REACH OF PUBLIC TRANSPORT LINKS, SCHOOLS, AND SHOPPING AMENITIES.

Palmers Green | 020 8920 9900 | palmersgreen@winkworth.co.uk

Winkworth

for every step...

winkworth.co.uk



DESCRIPTION:

Buy-to-let investors only. A realistically priced two-double-bedroom flat set on the first floor of a purpose-built ex-local authority block just off Tottenham Road, within easy reach of bus services to Wood Green and shopping amenities along Green Lanes. You will also find several popular schools nearby, including Oakthorpe and St Michael at Bowes Primary Schools.

The property boasts just over 760 sq.ft of accommodation featuring an impressive 18' wide reception/dining room, a contemporary-style kitchen, a bathroom with a fitted suite, and two spacious bedrooms, one of which has a fitted wardrobe. Additional benefits include double glazing throughout, an intercom entry phone system, and communal grounds.

We understand the property is currently let on an Assured Shorthold Tenancy, which is due to be renewed in March 2025 for £1,400 per calendar month, yielding just over 6% per annum. The property is therefore offered for sale with the tenant in situ.



Beale Close, N13
 Approx. Gross Internal Floor Area 763 sq. ft / 70.85 sq. m

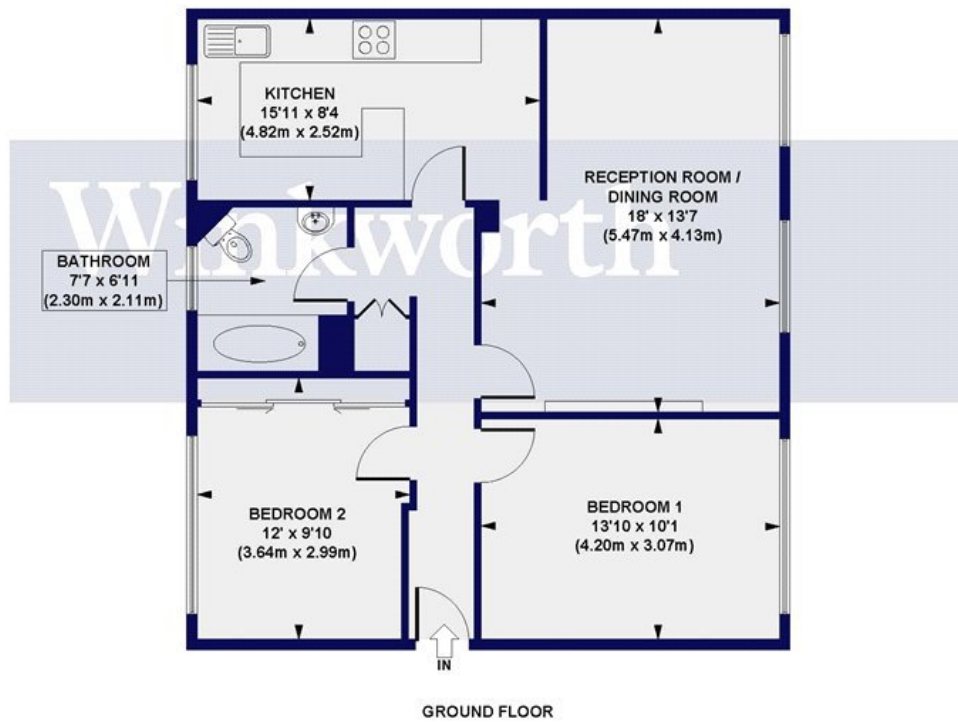

All measurements of walls, doors, windows, fittings and appliances, including their size and location, are shown as standard sizes and do not constitute any warranty or representation by the seller, their agent or CP Creative. Any intending purchaser must satisfy himself by inspection or otherwise as to the correctness of the information contained in these plans.

This floorplan is for illustration purposes only and is not to scale. The position and size of doors, windows, appliances and other features are approximate.

- Tenure:** Leasehold
- Term:** 86 year and 1 months
- Service Charge:** £TBC
- Ground Rent:** £10 Annually (subject to increase)
- Council Tax:** London Borough of Enfield – Band B

All figures that are shown were correct at the time of listing.

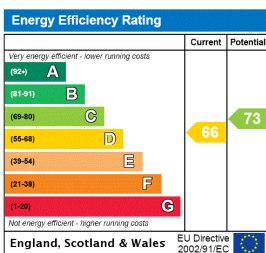

Palmer's Green | 020 8920 9900 | palmer'sgreen@winkworth.co.uk



for every step...

winkworth.co.uk

Winkworth wishes to inform prospective buyers and tenants that these particulars are a guide and act as information only. All our details are given in good faith and believed to be correct at the time of printing but they don't form part of an offer or contract. No Winkworth employee has authority to make or give any representation or warranty in relation to this property. All fixtures and fittings, whether fitted or not are deemed removable by the vendor unless stated otherwise and room sizes are measured between internal wall surfaces, including furnishings.