



TRENMAR GARDENS, LONDON, NW10
£975,000 FREEHOLD

**A LOVELY FOUR BEDROOM FAMILY HOME CLOSE TO
AMENITIES AND TRANSPORT AT KENSAL GREEN STATION ON
THE BAKERLOO AND LONDON OVERGROUND LINES.**

Kensal Rise & Queens Park | 0208 960 4947 | kensalrise@winkworth.co.uk

Winkworth

winkworth.co.uk

See things differently



LOCATION:

Trenmar Gardens is a more affordable alternative to the expensive Kensal Rise houses and we believe offers that last opportunity to secure a freehold family house for this sort of budget within the area. Transport links are excellent with Kensal Green station having the Bakerloo and London Overground lines into town. This location also gives easy access to the A40 in and out of London. Most locals will gravitate towards College Road or Chamberlayne Road which both have a fantastic gastro pub and shopping facilities but there is also a range of local shops on Harrow Road if a pint of milk is needed including a Co-op and a wonderful Persian restaurant called Behesht which is a true hidden gem. If it's green spaces you're looking for then there are three fantastic parks frequented by locals. Roundwood Park, King Edwards and Queens Park are all easily accessed from this location.





DESCRIPTION:

This wonderful family home has accommodation arranged over three floors including a loft conversion which houses a guest double bedroom, serviced by its own separate bathroom. On the first floor buyers will find two further double bedrooms, a smaller single room (making four bedrooms in total) and a family bathroom. Downstairs, leading in from the hallway the original two reception rooms have been opened up to create a lovely entertaining space all leading to the west facing garden at the rear. A modern fitted kitchen is located just off the rear of this room and the layout works really well for entertaining and family days at home. The property is in excellent condition throughout having been renovated and very well maintained by the current owners.



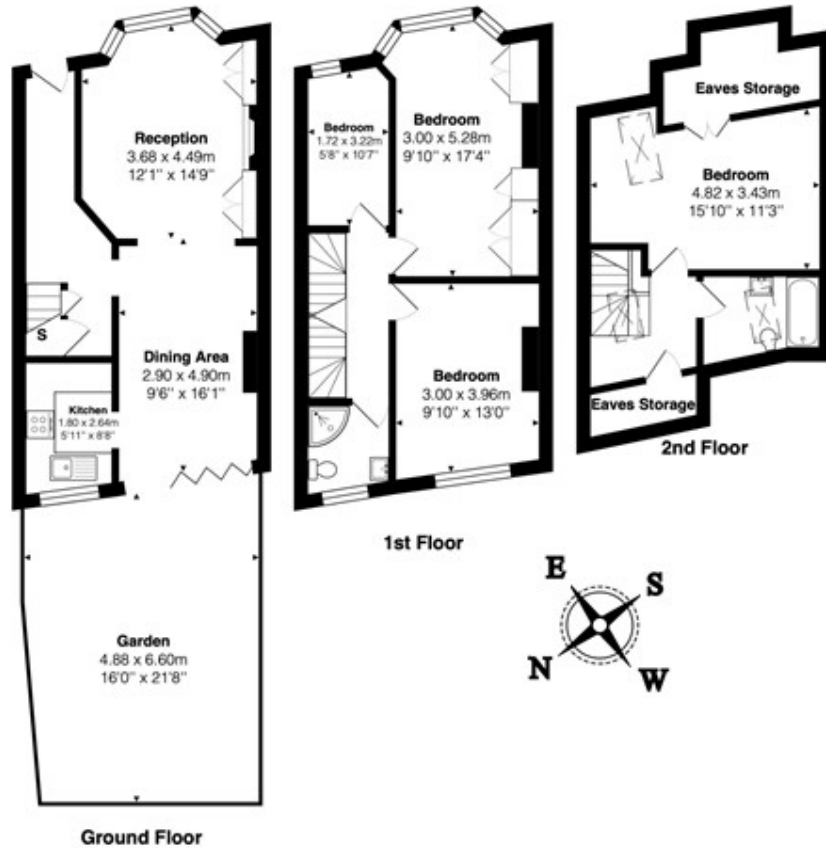

Total Area: 120.4 m² ... 1296 ft² (excluding garden)
 All measurements are approximate and for display purposes only

This floorplan is for illustration purposes only and is not to scale. The position and size of doors, windows, appliances and other features are approximate.

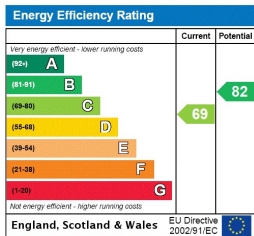

Kensal Rise & Queens Park | 0208 960 4947 | kensalrise@winkworth.co.uk

Winkworth

winkworth.co.uk

See things differently

winkworth wishes to inform prospective buyers and tenants that these particulars are a guide and act as information only. All our details are given in good faith and believed to be correct at the time of printing but they don't form part of an offer or contract. No Winkworth employee has authority to make or give any representation or warranty in relation to this property. All fixtures and fittings, whether fitted or not are deemed removable by the vendor unless stated otherwise and room sizes are measured between internal wall surfaces, including furnishings.