



Courtfield Gardens

London, SW5

A beautiful one double bedroom flat with large south west facing private terrace.

This bright and beautifully presented top floor apartment comprises of a spacious double bedroom, large family bathroom, open plan kitchen and sitting room which leads onto a south west facing private terrace.

The apartment is situated in a Period building with a share in the freehold. Courtfield Gardens is conveniently located between Earls Court and Gloucester Road and enjoys easy access to all the local amenities.

Asking Price: £520,000 Subject to Contract

Tenure: Share of Freehold (956yrs remaining)

Local Authority: The Royal Borough of Kensington & Chelsea

Council tax band: D

Service Charge: Circa £2,000pa

Ground Rent: peppercorn





Private Roof Terrace | Share of Freehold | Communal Gardens

COURTFIELD GARDENS, SW5

APPROXIMATE GROSS INTERNAL AREA
 363 Ft² - 33.72 M²

Illustration For Identification Only. Not To Scale.
 All Calculations include Any/All Areas Under 1.5m Head Height.
 * As Defined by RICS - Code of Measuring Practice.

Key :
 CH - Ceiling Height

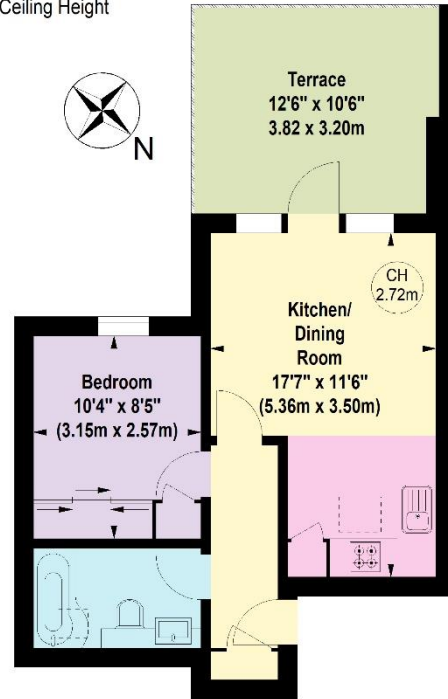

Winkworth

FOURTH FLOOR

Energy Efficiency Rating		Current	Potential
Very energy efficient - lower running costs			
(92+)	A		
(81-91)	B		
(69-80)	C		79
(55-68)	D		
(39-54)	E	39	
(21-38)	F		
(1-20)	G		
Not energy efficient - higher running costs			
England, Scotland & Wales		EU Directive 2002/91/EC	