



**ONE TREE CLOSE, LONDON, SE23**  
**£450,000 SHARE OF FREEHOLD**

Well positioned for stunning views across London, this split-level maisonette is set back from the road within a quiet cul-de-sac just off Honor Oak Rise and within the local nature reserve, One Tree Hill.

Forest Hill | | [foresthill@winkworth.co.uk](mailto:foresthill@winkworth.co.uk)





## DESCRIPTION:

**Boasting Unparalleled Views Across the London Skyline – A Truly Exceptional Split-Level Maisonette**

Nestled in a peaceful cul-de-sac just off Honor Oak Rise and surrounded by the tranquil beauty of One Tree Hill nature reserve, this impeccably finished split-level maisonette offers the kind of panoramic views of the London skyline that are nothing short of spectacular. With its elevated position, the property captures sweeping vistas of the city's iconic landmarks and skyline, providing an ever-changing backdrop that feels both serene and vibrant. Whether enjoying a morning coffee or unwinding in the evening, the view serves as a constant reminder of how truly special this home is.







# Tree Close, SE23

Approximate Gross Internal Area 57.8 sq m / 623 sq ft

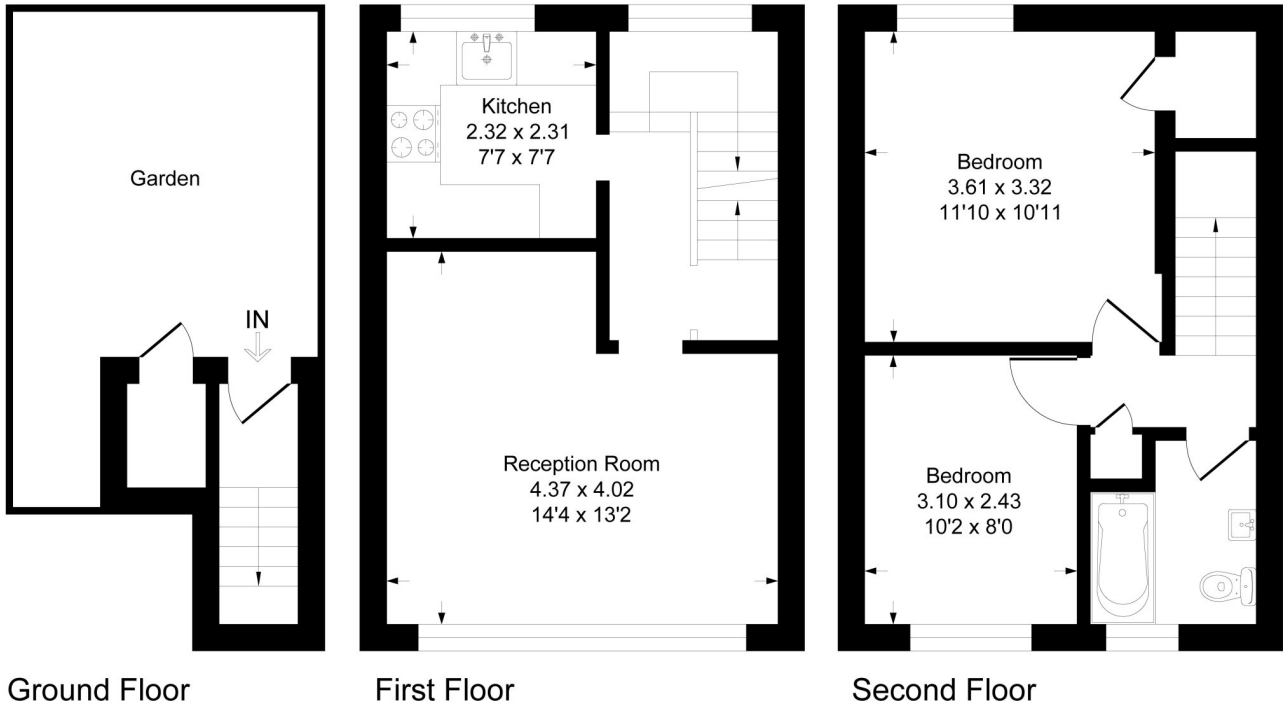

This Plan is for layout guidance only. Not drawn to scale unless stated. Windows and door openings are approximate. Whilst every care is taken in the preparation of this plan, please check all dimensions shapes and compass bearings before making any decisions reliant upon them. Produced by Squarefootphoto.co.uk



This floorplan is for illustration purposes only and is not to scale. The position and size of doors, windows, appliances and other features are approximate.

**Tenure:** Share of Freehold

