



ELVIN HOUSE, MORNING LANE, LONDON, E9  
£475,000 LEASEHOLD

## STUNNING 2-BED RENOVATED FLAT IN ELVIN HOUSE, E9 – PARKING, GARDEN & PRIME LOCATION!

Hackney | 020 8986 4216 | [hackney@winkworth.co.uk](mailto:hackney@winkworth.co.uk)

**Winkworth**

[winkworth.co.uk](http://winkworth.co.uk)

See things differently



## DESCRIPTION:

This beautifully renovated two-bedroom flat in Elvin House offers a perfect combination of modern living and unbeatable convenience. Featuring two genuine double bedrooms and a spacious kitchen, the flat boasts a bright living area that looks directly onto a private garden, providing a peaceful retreat. Located just moments from Hackney Central and Homerton stations, the property also includes parking, offering everything you need for comfortable living.

### Key Features:

- Recently renovated two-bedroom flat with contemporary finishes
  - Bright living area with plenty of natural light, looking directly onto the private garden
  - Spacious kitchen with high-end appliances and ample storage
  - Two generously sized genuine double bedrooms, filled with natural light
  - Modern bathroom with walk-in shower and sleek finishes
  - Private garden – perfect for relaxing or entertaining
  - Parking – a valuable addition for those with a vehicle
  - Excellent storage throughout
- ### Location Highlights:

**Transport Links:** Just a short walk to both Hackney Central and Homerton stations, offering direct connections into Central London, making commuting easy and quick.

**Supermarkets:** Two Tesco stores are within easy reach, providing convenience for all your grocery needs.

**Local Favourites:** Explore the charming Broadway Market and the trendy Chatsworth Road, both offering a variety of independent shops and eateries. Well Street, with its eclectic selection of cafes and boutiques, is also nearby.

**Dining & Shopping:** Indulge in a delicious meal at Paulie's Bagel Shop or Well Street Pizza, both local favourites, or enjoy a flavourful small plate at Dalla, a popular Italian spot. Victoria Park Village is just around the corner, offering a selection of boutique shops and cafes.

**Victoria Park:** A short stroll away, the iconic Victoria Park offers scenic green spaces, lakes, and a relaxing atmosphere.

This flat is perfect for anyone looking to enjoy the vibrant Hackney lifestyle while benefiting from the peaceful retreat of a renovated home with a garden and parking.

**Winkworth**



Winkworth

**Elvin House, Morning Lane, E9**  
 Approx. Gross Internal Floor Area 599 sq. ft / 55.61 sq. m

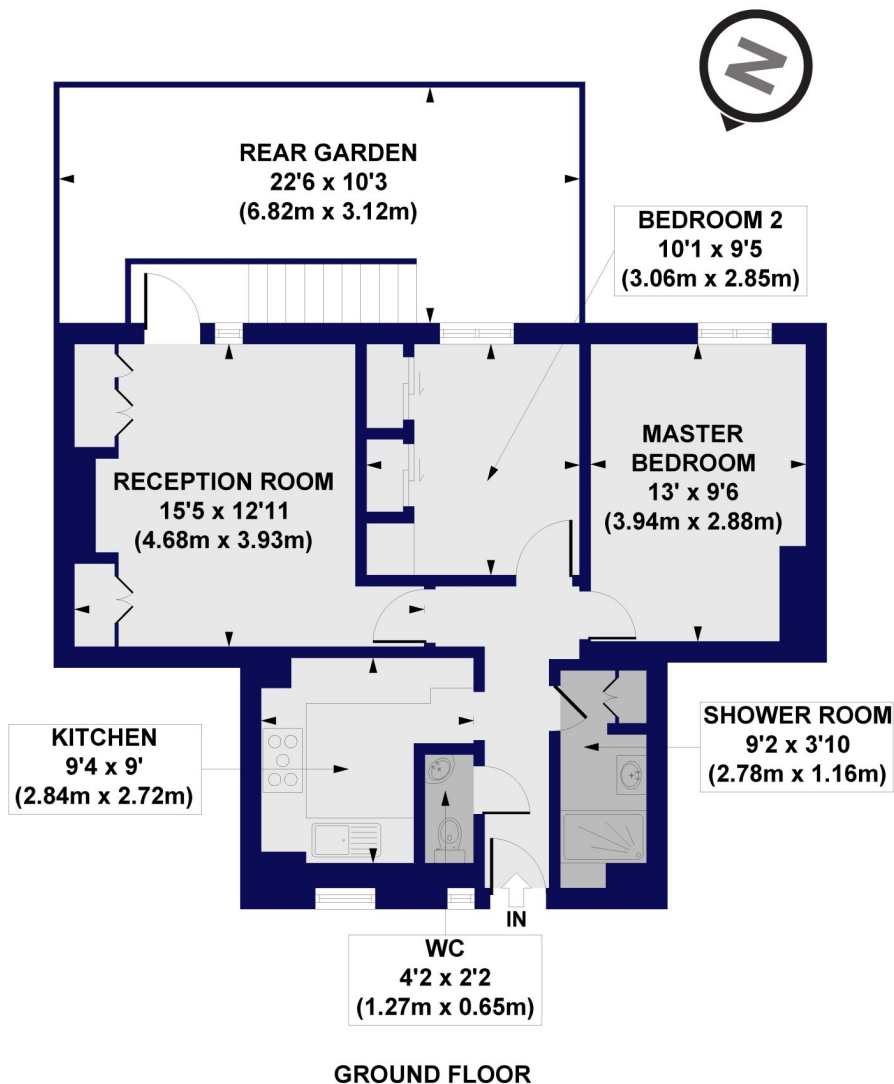

All measurements of walls, doors, windows, fittings and appliances, including their size and location, are shown as standard sizes and do not constitute any warranty or representation by the seller, their agent or CP Creative. Any intending purchaser must satisfy himself by inspection or otherwise as to the correctness of the information contained in these plans. This plan is for illustrative purposes only and should be used as such by any prospective purchasers.

**Winkworth**

This floorplan is for illustration purposes only and is not to scale. The position and size of doors, windows, appliances and other features are approximate.

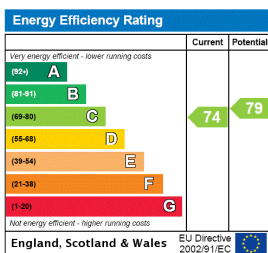

Hackney | 020 8986 4216 | [hackney@winkworth.co.uk](mailto:hackney@winkworth.co.uk)

**Winkworth**

[winkworth.co.uk](http://winkworth.co.uk)

See things differently

Winkworth wishes to inform prospective buyers and tenants that these particulars are a guide and act as information only. All our details are given in good faith and believed to be correct at the time of printing but they don't form part of an offer or contract. No Winkworth employee has authority to make or give any representation or warranty in relation to this property. All fixtures and fittings, whether fitted or not are deemed removable by the vendor unless stated otherwise and room sizes are measured between internal wall surfaces, including furnishings.