



MYDDLETON AVENUE, LONDON, N4
£950,000 FREEHOLD

**A BEAUTIFULLY PRESENTED, FOUR BEDROOM,
TWO BATHROOM FAMILY HOME WITH PRIVATE
DRIVEWAY IN N4**

Highbury | 0207 989 7000 | highbury@winkworth.co.uk

Winkworth



DESCRIPTION:

A substantial, four bedroom, two bathroom freehold house with off street parking positioned on a quiet cul-de-sac in N4. Standing at 1,452 sqft, the property is set across three separate floors and offers a wealth of natural light from a north to south facing aspect. The ground floor occupies a wonderfully spacious, extended kitchen which is large enough for a dining table, while French doors lead out from the conservatory into a sizeable, mature private garden creating the perfect entertaining space. The first floor features a well-proportioned reception room and separate bathroom, and rear double bedroom not forgetting ample storage throughout. All four bedrooms are genuine doubles, the master benefitting from an ensuite on the top floor with the other three double bedrooms individually split across each floor.

This superb house is located on a fantastically quiet section of Myddleton Avenue yet offers exceptionally easy access to zone 1 via Manor House underground (Piccadilly Line) with Finsbury Park (Piccadilly, Victoria and National Rail) also a short distance away. The 141 and 341 bus routes provide further options for effortless commuting to the City and West End. Stoke Newington, Highbury and Stroud Green with their vast array of restaurants, gastro pubs and coffee shops are a short walk as are the green open spaces of Finsbury Park and Clerkenwell Park.

Winkworth



Winkworth

Myddleton Avenue, N4

Approx. Gross Internal Floor Area 1452 sq. ft / 134.93 sq. m

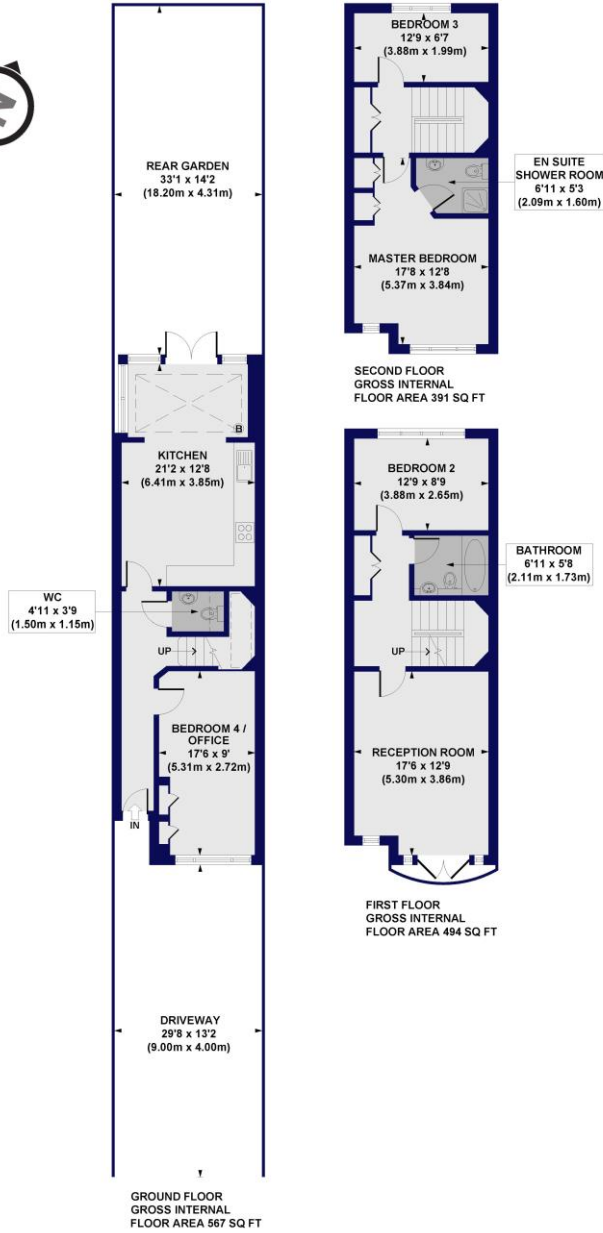

All measurements of walls, doors, windows, fittings and appliances, including their size and location, are shown as standard sizes and do not constitute any warranty or representation by the seller, their agent or CP Creative. Any intending purchaser must satisfy himself by inspection or otherwise as to the correctness of the information contained in these plans. This plan is for illustrative purposes only and should be used as such by any prospective purchasers.

Winkworth

This floorplan is for illustration purposes only and is not to scale. The position and size of doors, windows, appliances and other features are approximate.

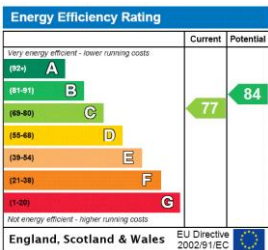

Highbury | 0207 989 7000 | highbury@winkworth.co.uk



winkworth.co.uk

See things differently

Winkworth wishes to inform prospective buyers and tenants that these particulars are a guide and act as information only. All our details are given in good faith and believed to be correct at the time of printing but they don't form part of an offer or contract. No Winkworth employee has authority to make or give any representation or warranty in relation to this property. All fixtures and fittings, whether fitted or not are deemed removable by the vendor unless stated otherwise and room sizes are measured between internal wall surfaces, including furnishings.