



ELM PARK ROAD, LONDON, N3
£795,000 FREEHOLD

A FOUR BEDROOM PERIOD STYLE FAMILY HOME WITH POTENTIAL TO EXPAND STPP

Finchley | 020 8349 3388 | finchley@winkworth.co.uk

Winkworth

for every step...

winkworth.co.uk



DESCRIPTION:

Situated in a popular turning off Nether Street, within easy access to both West Finchley and Finchley Central underground stations, local schools and recreational parkland, such as Dollis Brook, we are pleased to offer this four bedroom Terraced house. The property is in need of complete modernisation, but offers a great opportunity to create a wonderful family home with potential to expand further, stpp.

Offered on a chain free basis an internal viewing is highly recommended.

AT A GLANCE

- Set on a quiet residential turning
- Period style terraced house
- Potential to expand stpp
- Four bedrooms
- Two bathrooms
- Chain Free

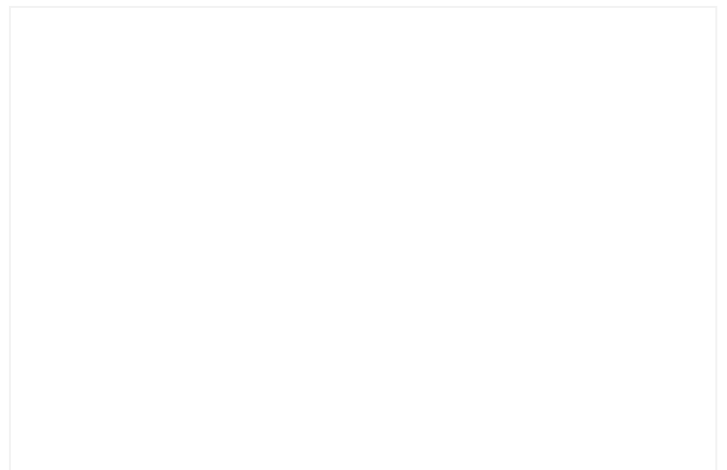
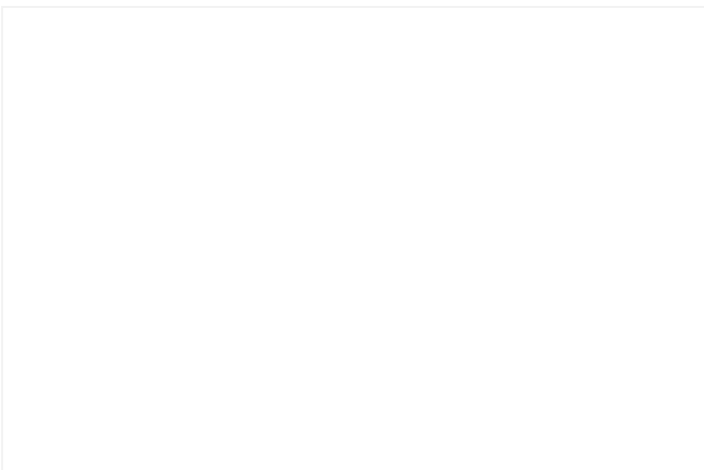

Elm Park Road, N3
Approx. Gross Internal Floor Area 1323 sq. ft / 122.91 sq. m

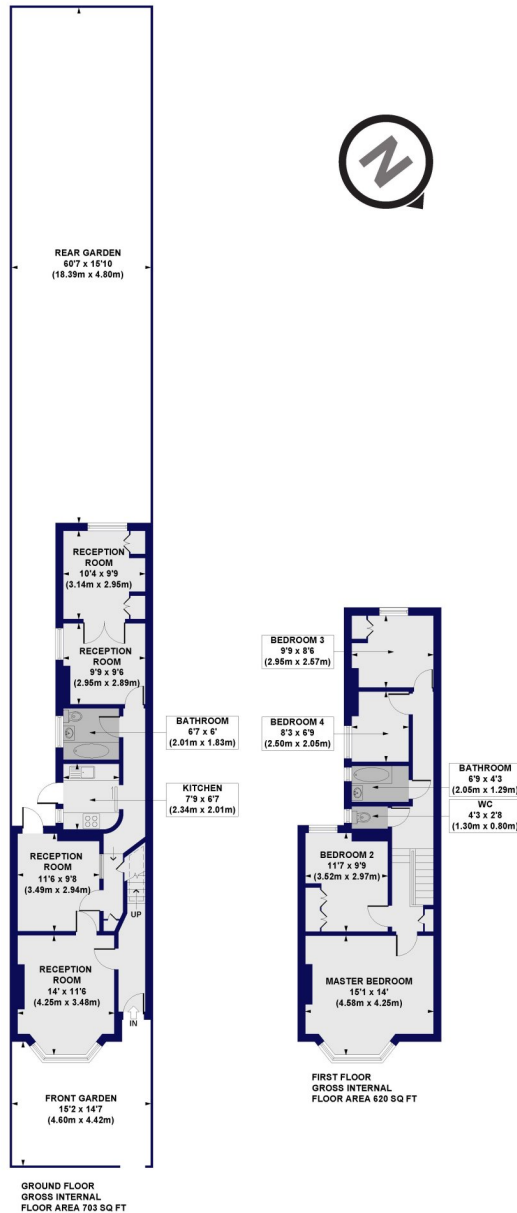

All measurements of walls, doors, windows, fittings and appliances, including their size and location, are shown as standard sizes and do not constitute any warranty or representation by the seller, their agent or CP Creative. Any intending purchaser must satisfy himself by inspection or otherwise as to the correctness of the information contained in these plans. This plan is for illustrative purposes only and should be used as such by any prospective purchasers.

Winkworth

This floorplan is for illustration purposes only and is not to scale. The position and size of doors, windows, appliances and other features are approximate.

Tenure: Freehold

Where no figures are shown, we have been unable to ascertain the information. All figures that are shown were correct at the time of printing.

Finchley | 020 8349 3388 | finchley@winkworth.co.uk

Winkworth

for every step...

winkworth.co.uk

Winkworth wishes to inform prospective buyers and tenants that these particulars are a guide and act as information only. All our details are given in good faith and believed to be correct at the time of printing but they don't form part of an offer or contract. No Winkworth employee has authority to make or give any representation or warranty in relation to this property. All fixtures and fittings, whether fitted or not are deemed removable by the vendor unless stated otherwise and room sizes are measured between internal wall surfaces, including furnishings.