



Southwell Gardens, South Kensington, London, SW7

£692.31 per week* / £3,000 per month – Furnished or Part-Furnished

A wonderfully light, well-proportioned two bedroom flat on the Third Floor (walk-up) of this attractive period building.

2 Bedrooms | 1 Reception Room | 1 Bathroom | Third Floor Flat | 670 Approx sq ft | EPC: C

APPLICANT FEES MAY BE APPLICABLE
HOLDING DEPOSIT OF 1 WEEK'S RENT
SECURITY DEPOSIT OF 5 WEEKS' RENT

Winkworth



DESCRIPTION

This charming property offers excellent living accommodation, comprising of a South-facing reception/dining room, fully-fitted kitchen, two bedrooms (one double and one single) and a separate bathroom. Southwell Gardens is in an ideal location with close proximity to Gloucester Road tube station. The property is available from the beginning of August on a furnished or part-furnished basis.



ACCOMMODATION

2 Bedrooms, 1 Reception Room,
1 Bathroom, Third Floor Flat,
Furnished or Part-Furnished,
670 Approx Sq ft

NEAREST PUBLIC TRANSPORT

Gloucester Road Tube Station
South Kensington Tube Station



COUNCIL TAX BAND DEPOSIT

Band G

DEPOSIT

5 Weeks Rent

Energy Efficiency Rating		Current	Potential
Very energy efficient - lower running costs			
(92+)	A		
(81-91)	B		
(69-80)	C	73	81
(55-68)	D		
(39-54)	E		
(21-38)	F		
(1-20)	G		
Not energy efficient - higher running costs			
England, Scotland & Wales		EU Directive 2002/91/EC	

Flat 6,
2 Southwell Gardens, SW7
Approx. Gross Internal Area *
670 Ft² - 62.24 M²

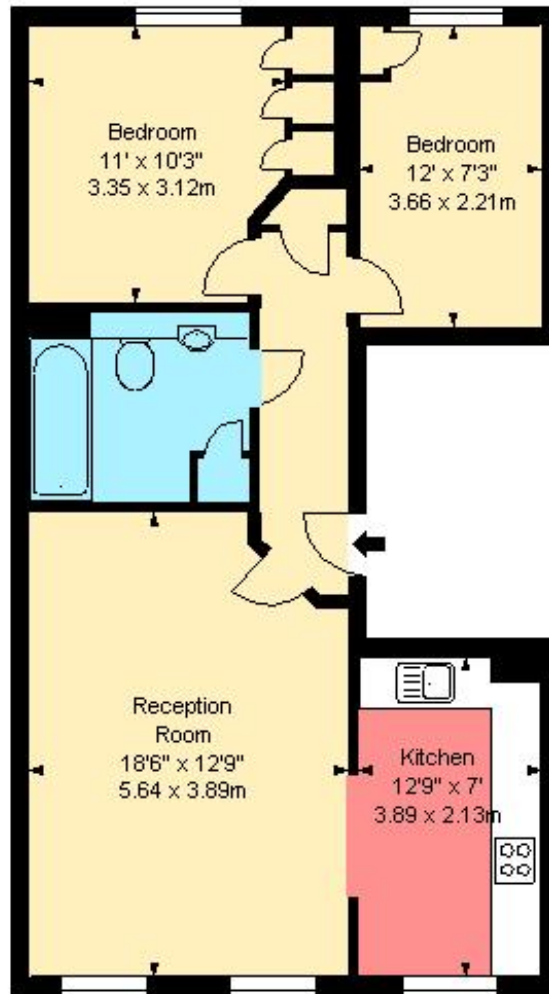

Third Floor

Illustration For Identification Purposes Only. Not to Scale

*A1 Defined by RICS - Code of Measuring Practice

B K R

FLOORPLANS

(OFFICES THROUGHOUT THE UK)

T: 0845 257 2823
WWW.BKRFLOORPLANS.CO.UK
7887

This floorplan is for illustration purposes only and is not to scale. The position and size of doors, windows, appliances and other features are approximate.

**Please note, rent cannot be paid on a weekly basis*

South Kensington Lettings | 020 7370 6767 | lettings.southken@winkworth.co.uk

winkworth.co.uk

Winkworth

for every step...

Winkworth wishes to inform prospective buyers and tenants that these particulars are a guide and act as information only. All our details are given in good faith and believed to be correct at the time of printing but they don't form part of an offer or contract. No Winkworth employee has authority to make or give any representation or warranty in relation to this property. All fixtures and fittings, whether fitted or not are deemed removable by the vendor unless stated otherwise and room sizes are measured between internal wall surfaces, including furnishings.