



## REGENCY STREET, SW1P

£499,950

LEASEHOLD

### At a glance...

- Double Bedroom
- Large Reception
- Lift Access
- Secure Entry System
- No Onward Chain
- Council Tax Band: E

**Winkworth**

for every step...



| Energy Efficiency Rating                             |                         |           |
|--|-------------------------|-----------|
|  | Current                 | Potential |
| Very energy efficient - lower running costs<br>(92+) |                         |           |
| A  |                         |           |
| (81-91)  |                         |           |
| B  | 83                      | 83        |
| (69-80)  |                         |           |
| C  |                         |           |
| (55-68)  |                         |           |
| D  |                         |           |
| (39-54)  |                         |           |
| E  |                         |           |
| (21-38)  |                         |           |
| F  |                         |           |
| (1-20)   |                         |           |
| G  |                         |           |
| Not energy efficient - higher running costs          |                         |           |
| England, Scotland & Wales                            | EU Directive 2002/91/EC |           |

## REGENCY STREET, SW1P

£499,950

LEASEHOLD

Accommodation comprises a spacious reception with room to dine and entertain, a modern kitchen, generous double bedroom with built-in storage and a smart family bathroom.

Peel House is located on Regency Street and perfectly positioned for the local amenities on Marsham Street, Horseferry Road, and Vauxhall Bridge Road. Elizabeth Street Victoria Street, with their plethora of retail outlets and a theatre, are also close by.

The property is well positioned for transport links and within easy walking distance of Pimlico Underground Station, Victoria's mainline, bus and underground as well as nearby St James's Park tube.

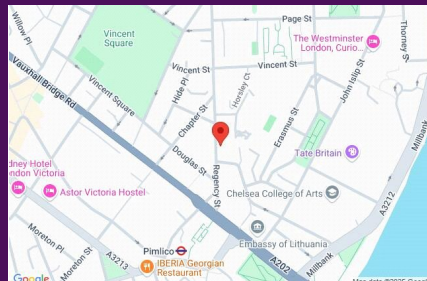

winkworth wishes to inform prospective buyers and tenants that these particulars are a guide and act as information only. All our details are given in good faith and believed to be correct at the time of printing but they don't form part of an offer or contract. No winkworth employee has authority to make or give any representation or warranty in relation to this property. All fixtures and fittings, whether fitted or not are deemed removable by the vendor unless stated otherwise and room sizes are measured between internal wall surfaces - including fireplaces.

## Peel House, SW1



Approx. Gross Internal Area  
479 Sq Ft - 44.50 Sq M

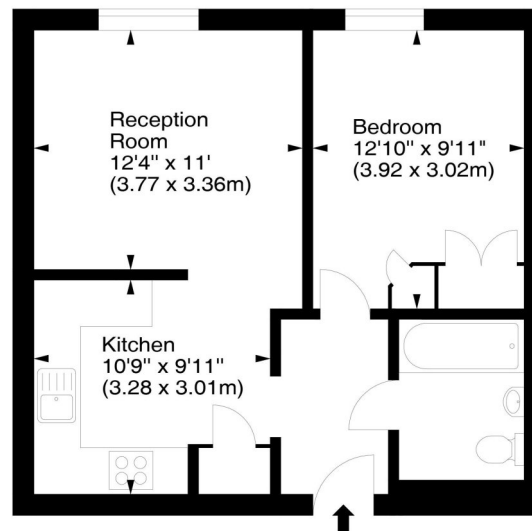

Fourth Floor

For illustration purposes only. Not to scale.  
All measurements are taken and shown at floor level.  
www.r3photography.co.uk © Photography / Floor Plans / Lease Plans / EPCs



Pimlico & Westminster

020 7828 1786

pimlico@winkworth.co.uk

winkworth.co.uk/pimlico-westminster

**Winkworth**

for every step...