



**FLAT 30, BARTHOLOMEW HOUSE, 4 SOUTHERN ROW, LONDON, W10  
£1,600 PER MONTH FURNISHED**

## **A WONDERFUL FURNISHED ONE BEDROOM APARTMENT TO RENT IN W10**

North Kensington | 020 7792 5000 | northkensington@winkworth.co.uk

**Winkworth**

for every step...

*winkworth.co.uk*



**DESCRIPTION:**

A spacious modern one bedroom flat set within a modern purpose built building just off the trendy Golborne Road. The property comes furnished with all neutral settings, benefits from an abundance of natural light from floor to ceiling windows.



**Winkworth**

for every step...

# Bartholomew House, W10

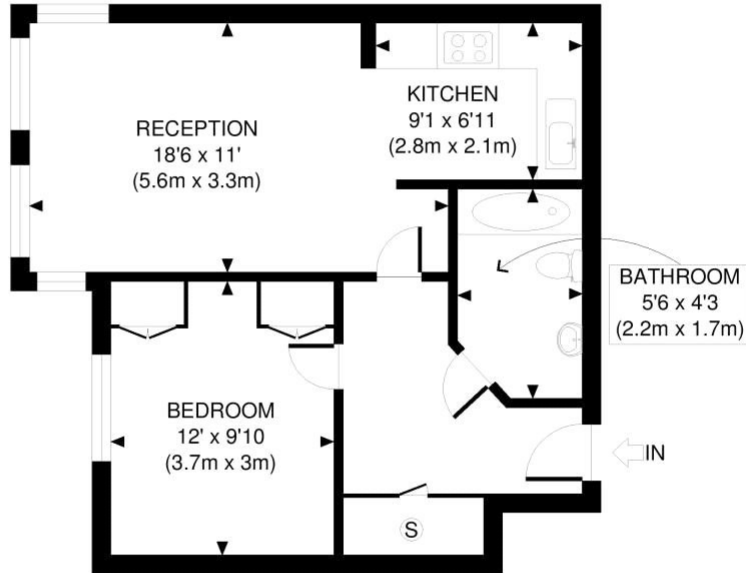

THIRD FLOOR  
GROSS INTERNAL  
FLOOR AREA 516 SQ FT

APPROX. GROSS INTERNAL FLOOR AREA 516 SQ FT / 47 SQM

Ref: Copyright **Lumiere**digital

Disclaimer: Floor plan measurements are approximate and are for illustrative purposes only. While we do not doubt the floor plan accuracy and completeness, you or your advisors should conduct a careful, independent investigation of the property in respect of monetary valuation

This floorplan is for illustration purposes only and is not to scale. The position and size of doors, windows, appliances and other features are approximate.

Energy Efficiency Rating		Current	Potential
Very energy efficient - lower running costs			
(92-100) A			
(81-91) B			
(69-80) C			
(55-68) D		65	65
(39-54) E			
(21-38) F			
(1-20) G			
Not energy efficient - higher running costs			
England, Scotland & Wales		EU Directive 2002/91/EC	

Environmental Impact (CO <sub>2</sub> ) Rating		Current	Potential
Very environmentally friendly - lower CO <sub>2</sub> emissions			
(92-100) A			
(81-91) B			
(69-80) C		75	75
(55-68) D			
(39-54) E			
(21-38) F			
(1-20) G			
Not environmentally friendly - higher CO <sub>2</sub> emissions			
England, Scotland & Wales		EU Directive 2002/91/EC	

North Kensington | 020 7792 5000 | northkensington@winkworth.co.uk

**Winkworth**

for every step...

winkworth.co.uk

Winkworth wishes to inform prospective buyers and tenants that these particulars are a guide and act as information only. All our details are given in good faith and believed to be correct at the time of printing but they don't form part of an offer or contract. No Winkworth employee has authority to make or give any representation or warranty in relation to this property. All fixtures and fittings, whether fitted or not are deemed removable by the vendor unless stated otherwise and room sizes are measured between internal wall surfaces, including furnishings.