



ALDRIDGE ROAD VILLAS, W11

£595 PER WEEK (£2,578.33 PCM) Part Furnished

A WONDERFUL OPPORTUNITY TO RENT THIS BEAUTIFUL AND WELL-PROPORTIONED TWO BEDROOM PROPERTY ON THE RAISED GROUND FLOOR OF A PRETTY PERIOD CONVERSION

2 Bedrooms, 1 Reception Room, 1 Bathroom, Ground Floor, Period, Part Furnished, 594 Approx Sq Ft

Winkworth



DESCRIPTION:

The property boasts high ceilings, large windows, and original features such as the fireplace and exposed brick wall that integrate flawlessly with the modern aspects of the property. The flat is immaculate throughout and boasts newly refurbished bathroom and kitchen. The flat comprises two large double bedrooms of equal size which both offer ample built in storage, a bathroom with bath and shower, and an open plan kitchen living space. Available part furnished for 6 months only.

LOCATION:

Aldridge Road Villas is a peaceful, tree lined residential street running north from Westbourne Park Road, a short walk from the shops and restaurants of Ledbury Road. Westbourne Park underground is just a moment away.

LOCAL AUTHORITY:

City of Westminster (Band E)



ALDRIDGE ROAD VILLAS, W11

Approx. gross internal area
 583 Sq.Ft. / 54.2 Sq.M.
 594 Sq.Ft. / 55.2 Sq.M. Inc. Restricted Height Area

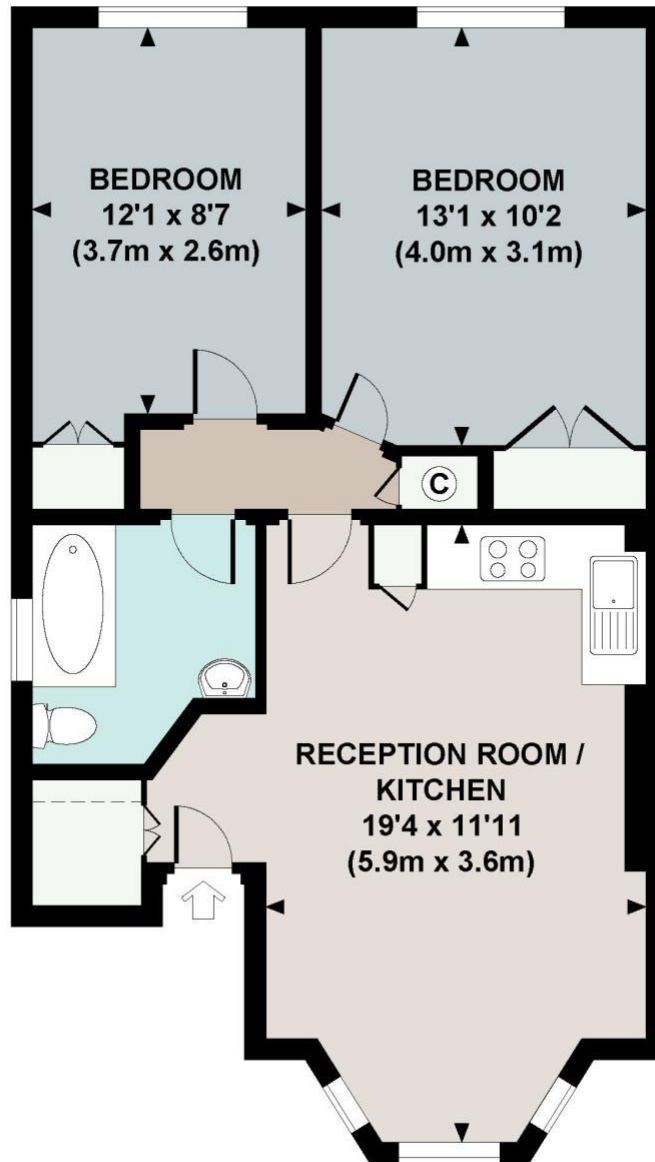

All measurements are approximate and for illustration purposes only as defined by the RICS Code of Measuring Practice © 2014 Dowling Jones Design www.dowlingjones.com 020 7610 9933

This floorplan is for illustration purposes only and is not to scale. The position and size of doors, windows, appliances and other features are approximate.

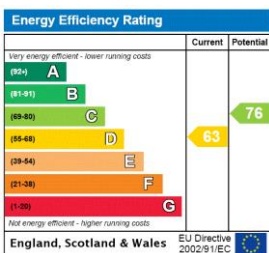

Notting Hill Lettings | 0207 727 3227 | nottinghill@winkworth.co.uk



winkworth.co.uk

See things differently

winkworth wishes to inform prospective buyers and tenants that these particulars are a guide and act as information only. All our details are given in good faith and believed to be correct at the time of printing but they don't form part of an offer or contract. No Winkworth employee has authority to make or give any representation or warranty in relation to this property. All fixtures and fittings, whether fitted or not are deemed removable by the vendor unless stated otherwise and room sizes are measured between internal wall surfaces, including furnishings.