



## Courtfield Road, South Kensington, London, SW7

£400 per week\* / £1,733.33 per month – Furnished

A well-proportioned, wonderfully light studio flat on the raised ground floor of a handsome red brick Victorian conversion.

Studio Room | 1 Bathroom | Kitchen | Ground Floor Flat | 290 Approx sq ft | EPC: D

APPLICANT FEES MAY BE APPLICABLE  
HOLDING DEPOSIT OF 1 WEEK'S RENT  
DEPOSIT OF 5 WEEKS' RENT

**Winkworth**

[winkworth.co.uk](http://winkworth.co.uk)

for every step...

## DESCRIPTION

The property benefits from exceptionally high ceilings and large windows. With a separate kitchen and bathroom with power-shower, wooden floors throughout and pull-down Murphy bed, this studio is the perfect bolthole in central London.

Courtfield Road is ideally located for all the shopping and transport facilities of Gloucester Road. The flat is available from the beginning of July on a furnished basis.

## ACCOMMODATION

Studio Room, 1 Bathroom, Kitchen,  
Ground Floor Flat, Furnished,  
290 Approx Sq ft

## NEAREST PUBLIC TRANSPORT

Gloucester Road Tube Station  
South Kensington Tube Station

## COUNCIL TAX BAND

Band D

**Courtfield Road, SW7**  
**Approx. Gross Internal Area \***  
**290 Ft<sup>2</sup> - 26.94 M<sup>2</sup>**

Illustration For Identification Purposes Only. Not to Scale  
\* As Defined by RICS - Code of Measuring Practice

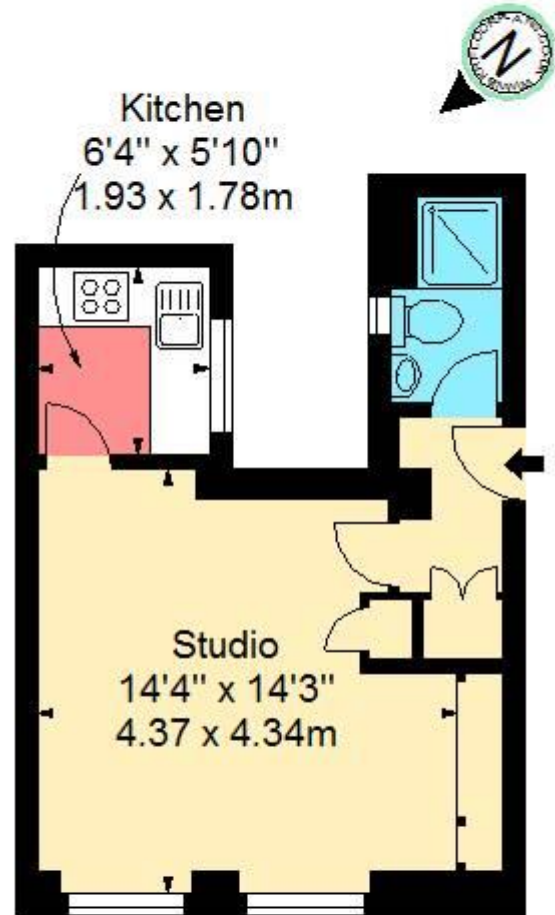

GROUND FLOOR

**BKR**  
FLOORPLANS

www.bkrfloorplans.co.uk  
T: 0845 257 2023  
2009

*This floorplan is for illustration purposes only and is not to scale. The position and size of doors, windows, appliances and other features are approximate.*

Energy Efficiency Rating		Current	Potential
Very energy efficient - lower running costs			
(92-)	<b>A</b>		
(81-91)	<b>B</b>		
(69-80)	<b>C</b>		<b>77</b>
(55-68)	<b>D</b>	<b>66</b>	
(39-54)	<b>E</b>		
(21-38)	<b>F</b>		
(1-20)	<b>G</b>		
Not energy efficient - higher running costs			
England, Scotland & Wales		EU Directive 2002/91/EC	

South Kensington Lettings | 020 7370 6767 | lettings.southken@winkworth.co.uk

\*Please note, rent cannot be paid on a weekly basis.

[winkworth.co.uk](http://winkworth.co.uk)

Winkworth wishes to inform prospective buyers and tenants that these particulars are a guide and act as information only. All our details are given in good faith and believed to be correct at the time of printing but they don't form part of an offer or contract. No Winkworth employee has authority to make or give any representation or warranty in relation to this property. All fixtures and fittings, whether fitted or not are deemed removable by the vendor unless stated otherwise and room sizes are measured between internal wall surfaces, including furnishings.

**Winkworth**

for every step...