



LIGHTCLIFFE ROAD, N13  
**£350,000 LEASEHOLD**

**A SPACIOUS FIRST FLOOR FLAT LOCATED CLOSE TO AMENITIES.**

Palmers Green | 020 8920 9900 | [palmersgreen@winkworth.co.uk](mailto:palmersgreen@winkworth.co.uk)

**Winkworth**

for every step...

[winkworth.co.uk](http://winkworth.co.uk)





## DESCRIPTION:

A light and airy flat arranged on the entire first floor of an Edwardian conversion, situated on a sought-after road close to Hazelwood Primary school, and within easy reach of Palmers Green BR station (to Moorgate) and shopping amenities on Green Lanes.

You will find a spacious reception room (currently used as a bedroom), an eat-in kitchen, two bedrooms, and a good-sized bathroom. There is also a handy storage area in entrance hall. This lovely flat would make an ideal first-time purchase or buy-to-let investment. Offered for sale with no onward chain and a long lease.

- Council Tax: London Borough of Enfield – Band C
- Service Charge: N/A
- Ground Rent: Peppercorn
- Remaining Lease Term: Currently just over 157 years

## SUMMARY:

- First Floor Period Conversion
- Easy Reach Palmers Green BR Station (Moorgate)
- Short Walk to Hazelwood Primary School
- Two Bedrooms
- Spacious Reception Room
- Eat-in Kitchen
- High Ceilings, Stripped Wood Doors and Flooring
- No Onward Chain
- Long Lease Term



**Lightcliffe Road, N13**  
 Approx. Gross Internal Floor Area 656 sq. ft / 60.95 sq. m

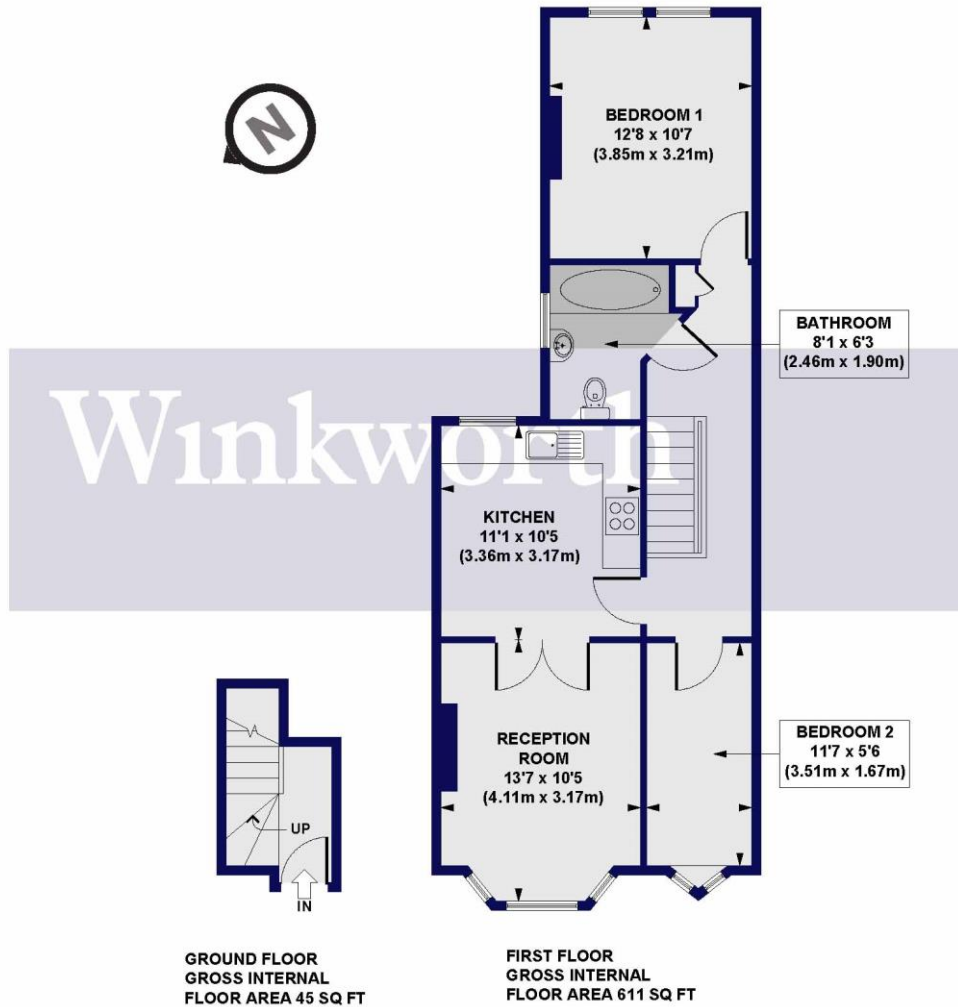

All measurements of walls, doors, windows, fittings and appliances, including their size and location, are shown as standard sizes and do not constitute any warranty or representation by the seller, their agent or CP Creative. Any intending purchaser must satisfy himself by inspection or otherwise as to the correctness of the information contained in these plans.

This floorplan is for illustration purposes only and is not to scale. The position and size of doors, windows, appliances and other features are approximate.

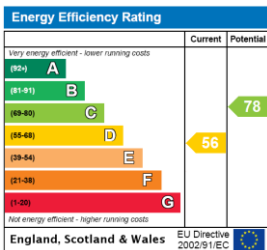

Palmers Green | 020 8920 9900 | palmersgreen@winkworth.co.uk



for every step...

winkworth.co.uk

Winkworth wishes to inform prospective buyers and tenants that these particulars are a guide and act as information only. All our details are given in good faith and believed to be correct at the time of printing but they don't form part of an offer or contract. No Winkworth employee has authority to make or give any representation or warranty in relation to this property. All fixtures and fittings, whether fitted or not are deemed removable by the vendor unless stated otherwise and room sizes are measured between internal wall surfaces, including furnishings.