



**BAKER STREET, WEYBRIDGE, SURREY, KT13**  
**£1,250 PER MONTH**

**DESCRIPTION:**

A beautifully presented 1 bedroom apartment which is situated on the First Floor of this attractive and well maintained small apartment block. Located in Weybridge town centre, the property is close to all of the local amenities as well as Weybridge mainline train station with about an 35 minutes commute to London Waterloo. EPC D.

Weybridge | 01932 854400 | [weybridge@winkworth.co.uk](mailto:weybridge@winkworth.co.uk)

**Winkworth**

for every step...

[winkworth.co.uk](http://winkworth.co.uk)

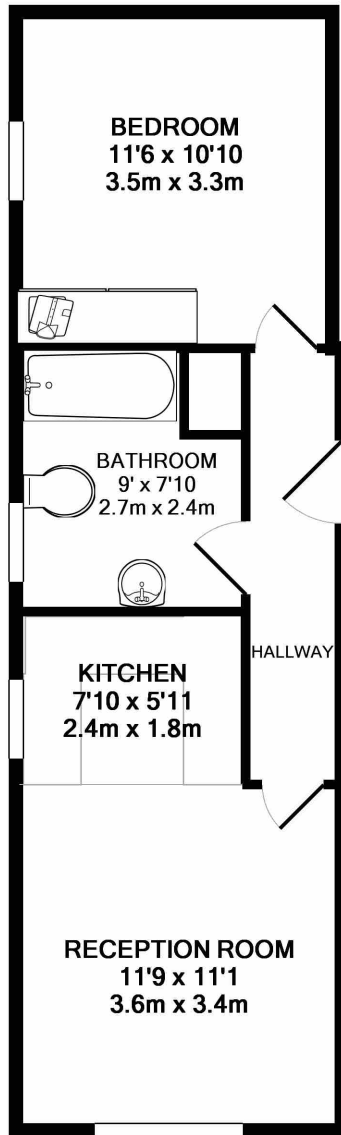

**MULBERRY HOUSE**  
**TOTAL APPROX. FLOOR AREA 421 SQ.FT. (39.1 SQ.M.)**

Whilst every attempt has been made to ensure the accuracy of the floor plan contained here, measurements of doors, windows, rooms and any other items are approximate and no responsibility is taken for any error, omission, or mis-statement. This plan is for illustrative purposes only and should be used as such by any prospective purchaser. The services, systems and appliances shown have not been tested and no guarantee as to their operability or efficiency can be given  
 Made with Metropix ©2014

This floorplan is for illustration purposes only and is not to scale. The position and size of doors, windows, appliances and other features are approximate.

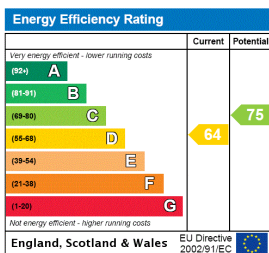

**Deposit: £1,442.31**

**Holding Deposit:**

**Council Tax Band:**

Where no figures are shown, we have been unable to ascertain the information. All figures that are shown were correct at the time of printing.

Weybridge | 01932 854400 | weybridge@winkworth.co.uk



for every step...

winkworth.co.uk

Winkworth wishes to inform prospective buyers and tenants that these particulars are a guide and act as information only. All our details are given in good faith and believed to be correct at the time of printing but they don't form part of an offer or contract. No Winkworth employee has authority to make or give any representation or warranty in relation to this property. All fixtures and fittings, whether fitted or not are deemed removable by the vendor unless stated otherwise and room sizes are measured between internal wall surfaces, including furnishings.