



LEIGHAM COURT ROAD, SW16
£325,000 LEASEHOLD

MODERN LIVING IN A SECURE GATED DEVELOPMENT: BRIGHT AND SPACIOUS TWO-BEDROOM GROUND FLOOR FLAT WITH EXCEPTIONAL TRANSPORT LINKS AND AMENITIES

Streatham | 0208 769 6699 | streatham@winkworth.co.uk

Winkworth

for every step...

winkworth.co.uk



DESCRIPTION:

Set within a secure gated development, this fantastic two-bedroom ground floor maisonette is part of a Grade-II listed building, offering bright and spacious accommodation with beautiful communal gardens. The flat features a spacious reception room and an open-plan kitchen with space to dine, perfect for modern living. The main bedroom is generously sized, providing ample comfort and storage.

Situated within walking distance to the high street, the property offers a superb selection of shops, pubs, and eateries. Transport links are exceptional, with Streatham Hill Station just a short distance away, providing direct trains into Clapham Junction, Victoria, and London Bridge, with Brixton only a bus ride away. This bright and airy flat is ideal for anyone looking for a comfortable and convenient living space within a vibrant community.





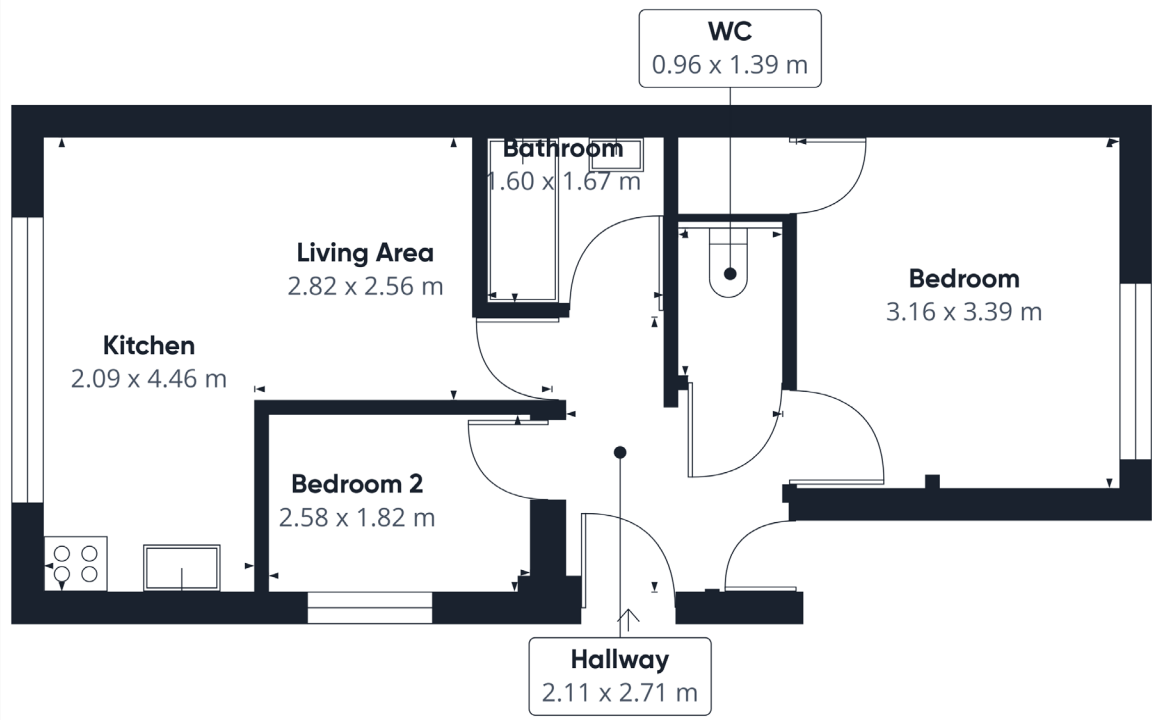

Approximate total area⁽¹⁾
41.53 m²

(1) Excluding balconies and terraces

While every attempt has been made to ensure accuracy, all measurements are approximate, not to scale. This floor plan is for illustrative purposes only.

GIRAFFE360

This floorplan is for illustration purposes only and is not to scale. The position and size of doors, windows, appliances and other features are approximate.

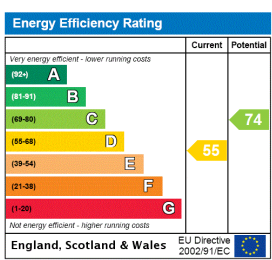

Tenure: Leasehold
Term: 980 year and 0 months
Service Charge: £5000 per annum
Ground Rent: £250 Annually (subject to increase)
Council Tax Band: B

Where no figures are shown, we have been unable to ascertain the information. All figures that are shown were correct at the time of printing.

Streatham | 0208 769 6699 | streatham@winkworth.co.uk



for every step...

winkworth.co.uk

Winkworth wishes to inform prospective buyers and tenants that these particulars are a guide and act as information only. All our details are given in good faith and believed to be correct at the time of printing but they don't form part of an offer or contract. No Winkworth employee has authority to make or give any representation or warranty in relation to this property. All fixtures and fittings, whether fitted or not are deemed removable by the vendor unless stated otherwise and room sizes are measured between internal wall surfaces, including furnishings.