



STREATHBOURNE ROAD, LONDON, SW17
£800,000 FREEHOLD

**LOCATED ON THE SOUGHT-AFTER
STREATHBOURNE ROAD IS THIS SPACIOUS THREE
BEDROOM HOUSE.**

Tooting | 020 8767 5221 | tooting@winkworth.co.uk

Winkworth

for every step...

winkworth.co.uk



DESCRIPTION:

Located on the sought-after Streathbourne Road is this three-bedroom house which has been extended on the ground floor. Boasting in excess of 950 sq ft of spacious accommodation across two floors. This property benefits from a private garden as well as being end of terrace.

Streathbourne Road is located in a popular residential area known locally as the Heaver Estate. The open spaces of both Tooting Common and Wandsworth Common are within easy walking distance as are the amenities of Balham High Road. Transport can be found at either Tooting Bec tube station or the overland/underground of Balham. This property is also in the catchment area for St Anselms primary school.



Streathbourne Road, SW17

Approx. Gross Internal Floor Area 959 sq. ft / 89.12 sq. m

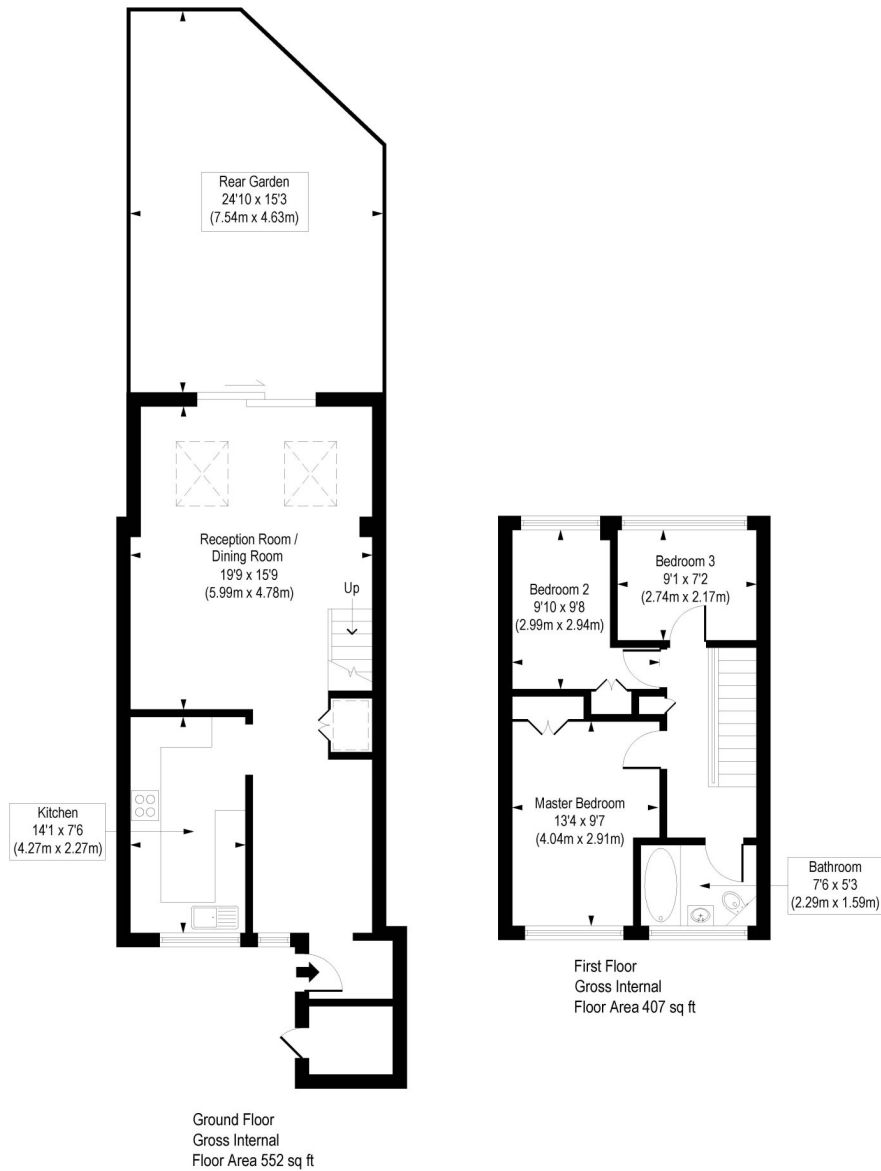

COMPLIANT WITH RICS CODE OF MEASURING PRACTICE. Floorplan is for illustrative purposes only and is not to scale. Every attempt has been made to ensure the accuracy of the floorplan shown, however all measurements, fixtures, fittings and data shown are an approximate interpretation for illustrative purposes only. Liability for errors, omissions or mis-statement through negligence or otherwise is hereby excluded.

This floorplan is for illustration purposes only and is not to scale. The position and size of doors, windows, appliances and other features are approximate.

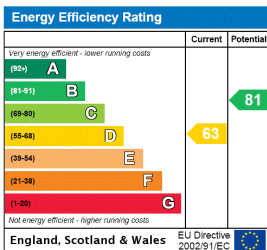

Tooting | 020 8767 5221 | tooting@winkworth.co.uk

for every step...

winkworth.co.uk

Winkworth wishes to inform prospective buyers and tenants that these particulars are a guide and act as information only. All our details are given in good faith and believed to be correct at the time of printing but they don't form part of an offer or contract. No Winkworth employee has authority to make or give any representation or warranty in relation to this property. All fixtures and fittings, whether fitted or not are deemed removable by the vendor unless stated otherwise and room sizes are measured between internal wall surfaces, including furnishings.