



MITCHAM LANE, LONDON, SW16
£1,850 PER MONTH

A STUNNING 3 BEDROOM MAISONETTE

Tooting | 020 8767 5221 | tooting@winkworth.co.uk

Winkworth

winkworth.co.uk

See things differently



DESCRIPTION:

A well presented three bedroom maisonette within an imposing Edwardian property on Mitcham Lane. The property is conveniently located for the amenities of Streatham Common including Streatham Common mainline station and is also walking distance from Tooting and Streatham mainline stations.



Winkworth

MITCHAM LANE, SW16

Approx. Gross Internal Floor Area
933 Sq. ft/86.73 Sq. m
 (incl eaves)

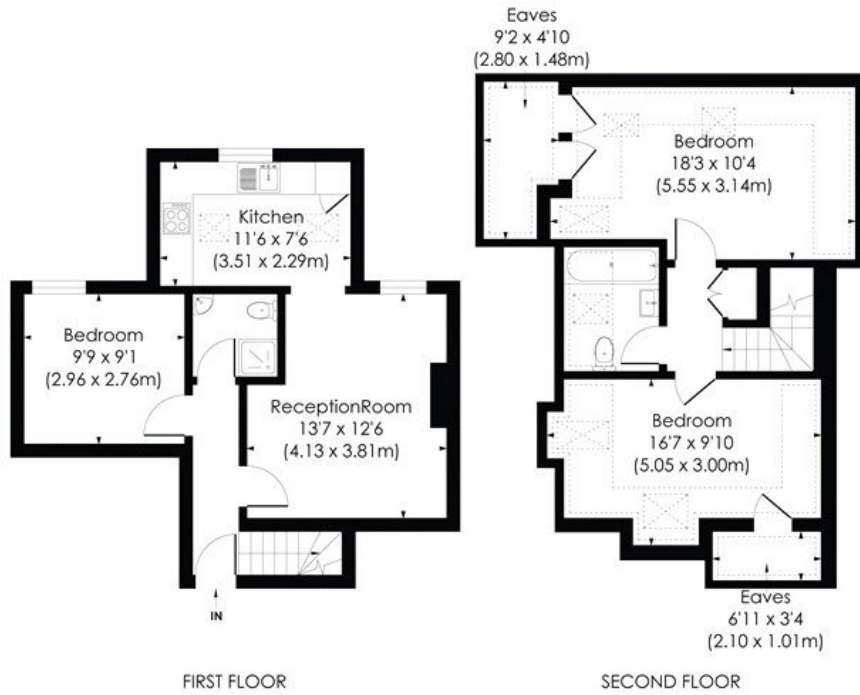

© Pixangle Property Marketing Ltd. info@pixangle.com Tel: 0208 870 2118



This floor plan has been prepared for the purpose of illustration only in accordance with the latest RICS code of measuring practice and is not to scale. All measurements and areas are approximate and whilst every effort has been made to ensure the accuracy of the plan contained here, no responsibility is taken for any error, omission or misstatement.

This floorplan is for illustration purposes only and is not to scale. The position and size of doors, windows, appliances and other features are approximate.

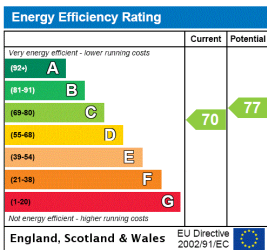

Tooting | 020 8767 5221 | tooting@winkworth.co.uk



winkworth.co.uk

See things differently

Winkworth wishes to inform prospective buyers and tenants that these particulars are a guide and act as information only. All our details are given in good faith and believed to be correct at the time of printing but they don't form part of an offer or contract. No Winkworth employee has authority to make or give any representation or warranty in relation to this property. All fixtures and fittings, whether fitted or not are deemed removable by the vendor unless stated otherwise and room sizes are measured between internal wall surfaces, including furnishings.