



GROUND FLOOR, CAVENDISH AVENUE, FINCHLEY, LONDON, N3
£325,000 LEASEHOLD

A WELL PRESENTED, TWO BEDROOM, GROUND FLOOR GARDEN FLAT.

DESCRIPTION:

CASH BUYERS ONLY

A spacious, two bedroom, ground floor, Edwardian, converted garden flat. Situated on this desirable road, within the catchment area of Akiva and St Theresa's primary Schools, and a short walk to Finchley Central Underground, and local shopping amenities.

The property comprises of two bedrooms, spacious reception room, kitchen, bathroom and private rear garden.

Offered on a chain free basis an internal viewing is highly recommended.

AT A GLANCE

- Set in a popular residential turning
- Period style building
- Ground Floor
- Two bedrooms
- Spacious Kitchen & Reception Room
- Private Garden
- Chain free

Finchley | 020 8349 3388 | finchley@winkworth.co.uk

Winkworth

for every step...

winkworth.co.uk





Winkworth



Cavendish Avenue, N3
Approx. Gross Internal Floor Area 770 sq. ft / 71.50 sq. m

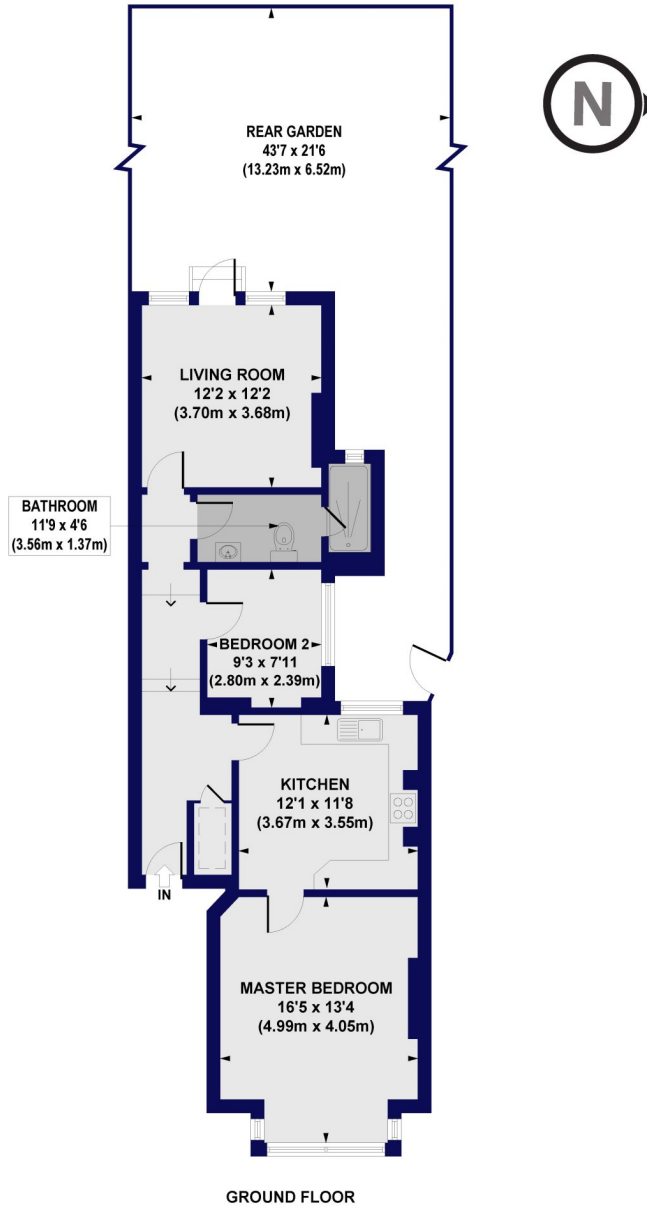

All measurements of walls, doors, windows, fittings and appliances, including their size and location, are shown as standard sizes and do not constitute any warranty or representation by the seller, their agent or CP Creative. Any intending purchaser must satisfy himself by inspection or otherwise as to the correctness of the information contained in these plans. This plan is for illustrative purposes only and should be used as such by any prospective purchasers.

Winkworth

This floorplan is for illustration purposes only and is not to scale. The position and size of doors, windows, appliances and other features are approximate.

Tenure: Leasehold

Where no figures are shown, we have been unable to ascertain the information. All figures that are shown were correct at the time of printing.

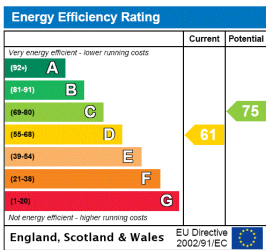

Finchley | 020 8349 3388 | finchley@winkworth.co.uk

Winkworth

for every step...

winkworth.co.uk

Winkworth wishes to inform prospective buyers and tenants that these particulars are a guide and act as information only. All our details are given in good faith and believed to be correct at the time of printing but they don't form part of an offer or contract. No Winkworth employee has authority to make or give any representation or warranty in relation to this property. All fixtures and fittings, whether fitted or not are deemed removable by the vendor unless stated otherwise and room sizes are measured between internal wall surfaces, including furnishings.