



Glenmoor Road
Ferndown BH22 8QE
Guide Price £475,000





**GUIDE PRICE £475,000
FREEHOLD**

This immaculate three bedroom detached bungalow is positioned on a south west facing plot of approx 1/5 of an acre and is perfect for buyers looking to downsize to a spacious property or those wanting to extend their next home, due to this properties size of plot and layout there is a huge amount of scope to do this.

Located in a sought after area of West Parley, close to local amenities and further benefitting from off road parking for multiple vehicles and an oversized garage with workshop space.

**Three Bedrooms
South West Facing Plot
Detached Bungalow
Guest Cloakroom
Overside Garage With Workshop Space,
Light & Power
Driveway For Several Vehicles
Sought After Location
Lots Of Scope For Extension
Positioned On Approx 1/5 Of An Acre**

EPC TBC | Council Tax Band E

**01202 434365
ferndown@winkworth.co.uk**





Glenmoor Road

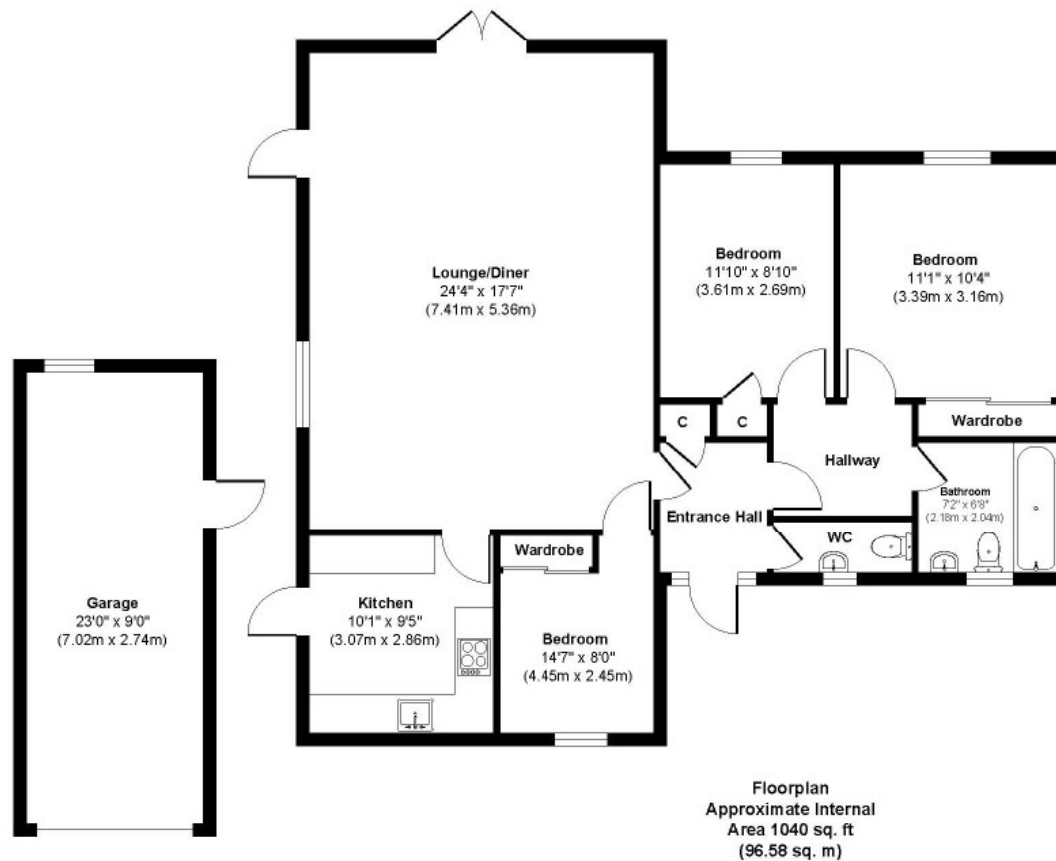

Garage
Approximate Internal
Area 207 sq. ft
(19.23 sq. m)

Approx. Gross Internal Floor Area 1247 sq. ft / 115.81 sq. m
Illustration for identification purposes only, measurements approximate and not to scale.



LOCATION

Positioned in a sought after residential area of West Parley just a short distance from Ferndown town centre, within catchment of Ferndown Schools and close to a range of amenities including an M&S Foodhall. There are bus routes within a short walk giving you easy access to Wimborne, as well as Bournemouth & Poole, all of which have an excellent range of shops, bars, restaurants and leisure facilities. Award winning sandy beaches are just twenty minutes away and the A31 provides quick access to the New Forest, Southampton, London and beyond for the commuter by car.

Winkworth Ferndown

406 Ringwood Road, Ferndown, Dorset, BH22 9AU

01202 434365 | ferndown@winkworth.co.uk

winkworth.co.uk/ferndown

Winkworth