



WESTCOTE ROAD, BERKSHIRE, RG30 2DJ
£1,300 PER MONTH UNFURNISHED

**TWO BEDROOM SECOND FLOOR APARTMENT
CLOSE TO READING TOWN CENTRE.
AVAILABLE 27TH JULY.**

Reading | 0118 4022 300 | reading@winkworth.co.uk

Winkworth

for every step...

winkworth.co.uk



DESCRIPTION:

Well presented first floor two bedroom apartment located to the West of Reading just off the A4 Bath Road. The property comprises open plan living/dining room with a private balcony, kitchen, three piece bathroom and two double bedrooms. On road parking available. Available 27th July 2024. Unfurnished.

Please note the bedroom carpets and the built in wardrobe doors are being replaced before the commencement of a new tenancy.

AT A GLANCE

- Close to Reading town centre
- Two double bedrooms
- Private balcony
- On road parking
- Council tax band B
- Available 27th July
- Unfurnished



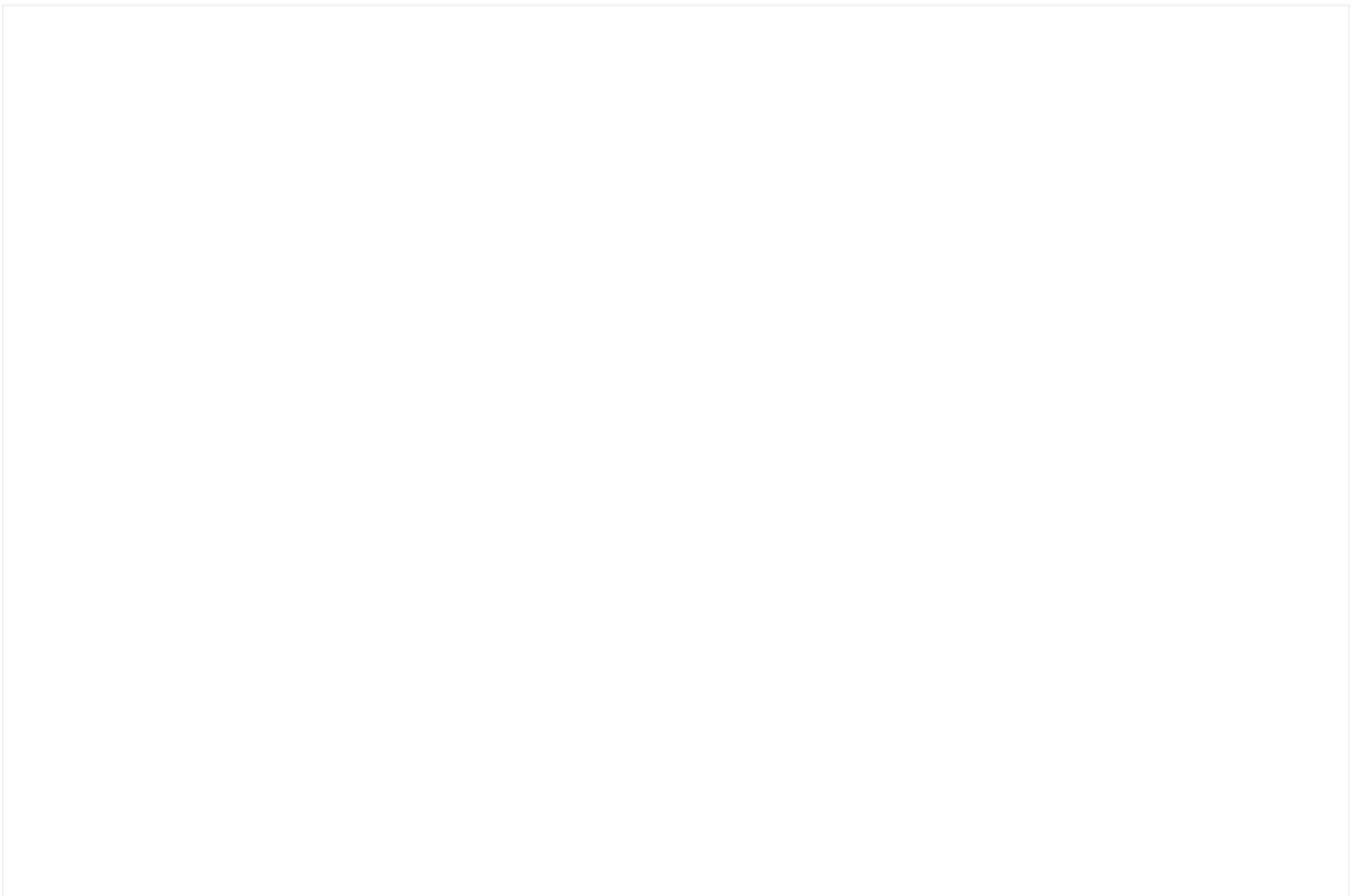
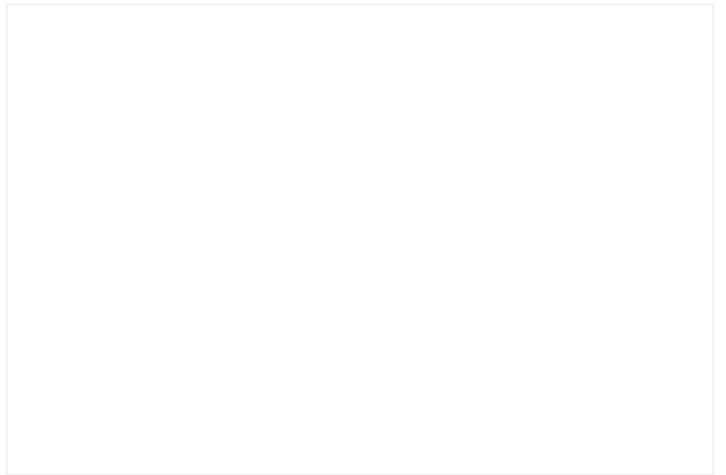
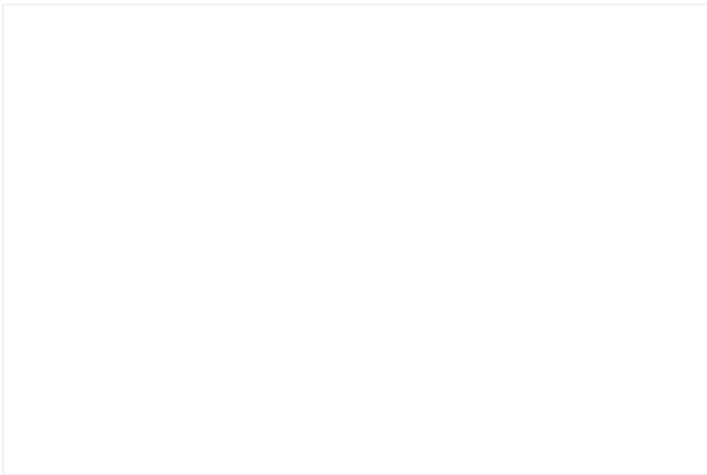

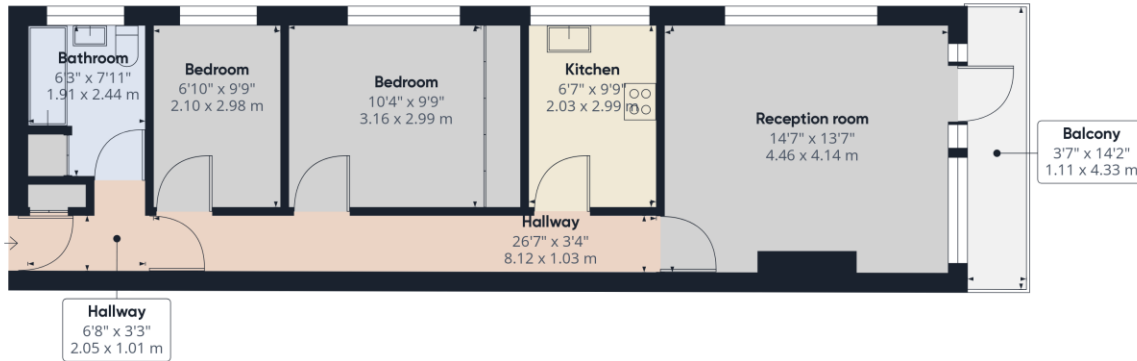

Approximate total area⁽¹⁾
628.72 ft²
58.41 m²

(1) Excluding balconies and terraces

While every attempt has been made to ensure accuracy, all measurements are approximate, not to scale. This floor plan is for illustrative purposes only.

GIRAFFE360

This floorplan is for illustration purposes only and is not to scale. The position and size of doors, windows, appliances and other features are approximate.

Deposit: £1,500.00

Holding Deposit: £300

Council Tax Band: B

Where no figures are shown, we have been unable to ascertain the information. All figures that are shown were correct at the time of printing.

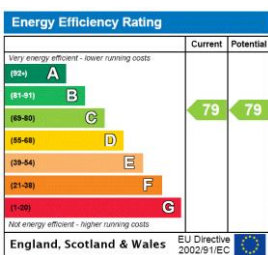

Reading | 0118 4022 300 | reading@winkworth.co.uk

Winkworth

for every step...

winkworth.co.uk

Winkworth wishes to inform prospective buyers and tenants that these particulars are a guide and act as information only. All our details are given in good faith and believed to be correct at the time of printing but they don't form part of an offer or contract. No Winkworth employee has authority to make or give any representation or warranty in relation to this property. All fixtures and fittings, whether fitted or not are deemed removable by the vendor unless stated otherwise and room sizes are measured between internal wall surfaces, including furnishings.