



ST. BENEDICTS CLOSE, SW17
OIEO £350,000 LEASEHOLD 983 YEARS (APPROX)

A WELL PRESENTED TWO BEDROOM GROUND FLOOR FLAT WITH OFF STREET RESIDENTS PARKING.

Tooting | 020 8767 5221 | tooting@winkworth.co.uk

Winkworth

for every step...

winkworth.co.uk



DESCRIPTION:

This ground floor property features two bedrooms, with the master bedroom offering a walk-in wardrobe/storage space with wash hand basin. The second bedroom also includes built-in wardrobe/storage. The home boasts a bright reception room, a modern kitchen, and a bathroom with a storage cupboard. Additionally, the property provides ample storage throughout and benefits from communal gardens and allocated off-street residents' parking.

St. Benedicts Close, is a residential area in Tooting, South London, known for its modern flats and family-friendly environment. The area has good transport links, with Tooting station just (0.5 miles) away and Tooting Broadway underground nearby (0.6 miles), providing easy access to central London. Residents benefit from a range of amenities, including supermarkets like Sainsbury's and Tesco, as well as local cafes and restaurants. Schools in the area, such as Graveney School and Tooting Primary School, have strong ratings. The neighbourhood is diverse, attracting young professionals and families alike.

Wandsworth Council Tax Band: C

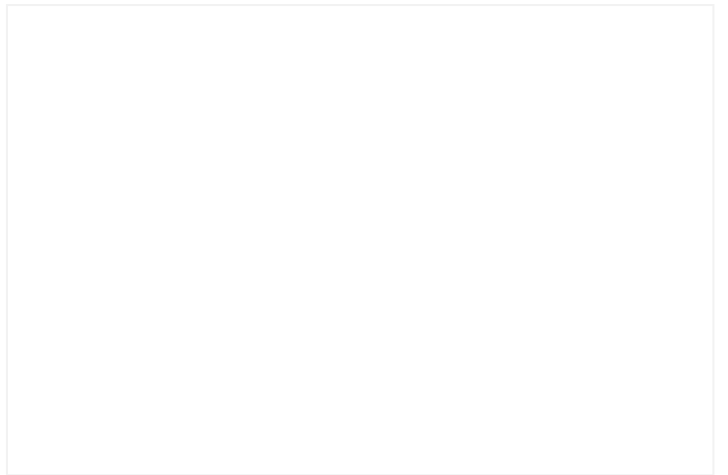

St. Benedicts Close, SW17

Approx. Gross Internal Floor Area 581 sq. ft / 53.96 sq. m

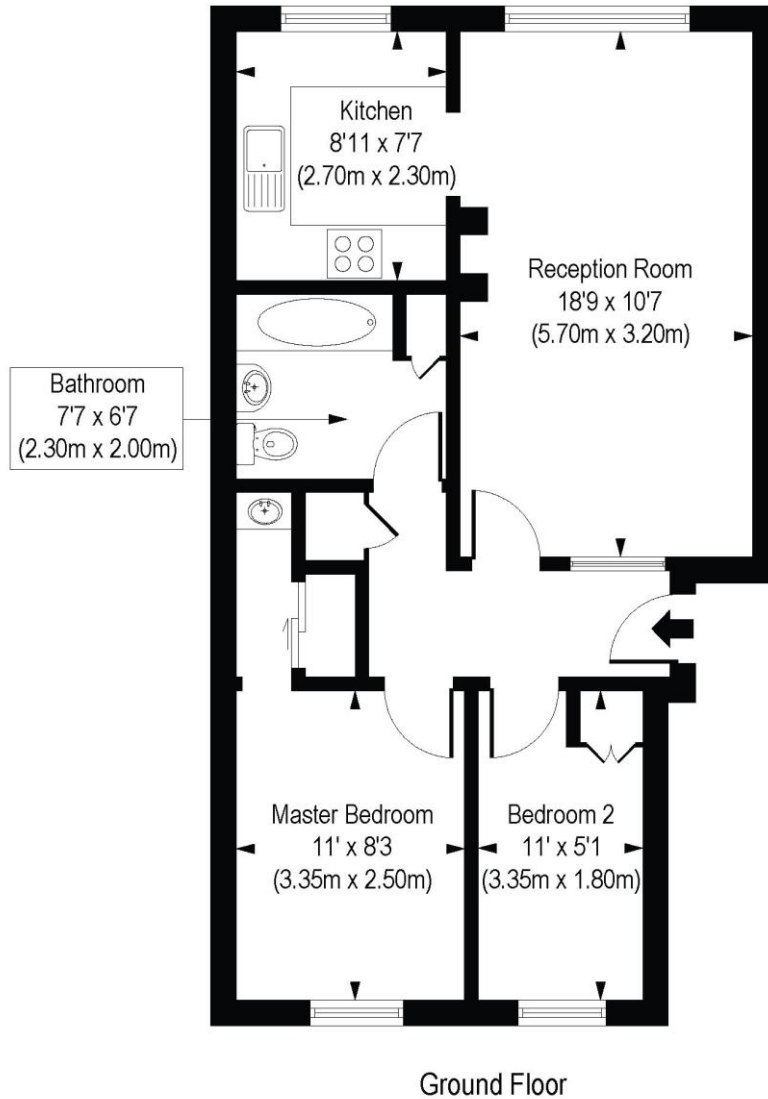

COMPLIANT WITH RICS CODE OF MEASURING PRACTICE. Floorplan is for illustrative purposes only and is not to scale. Every attempt has been made to ensure the accuracy of the floorplan shown, however all measurements, fixtures, fittings and data shown are an approximate interpretation for illustrative purposes only. Liability for errors, omissions or mis-statement through negligence or otherwise is hereby excluded.

This floorplan is for illustration purposes only and is not to scale. The position and size of doors, windows, appliances and other features are approximate.

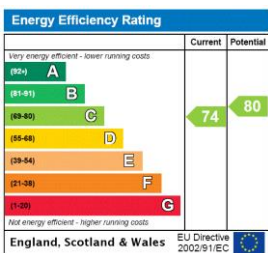

Tooting | 020 8767 5221 | tooting@winkworth.co.uk

for every step...

winkworth.co.uk

Winkworth wishes to inform prospective buyers and tenants that these particulars are a guide and act as information only. All our details are given in good faith and believed to be correct at the time of printing but they don't form part of an offer or contract. No Winkworth employee has authority to make or give any representation or warranty in relation to this property. All fixtures and fittings, whether fitted or not are deemed removable by the vendor unless stated otherwise and room sizes are measured between internal wall surfaces, including furnishings.