



TAYSIDE COURT, BASINGDON WAY, CAMBERWELL, LONDON, SE5
£275,000 LEASEHOLD

OFFERED TO THE MARKET CHAIN FREE IS THIS GROUND FLOOR ONE DOUBLE BEDROOM FLAT, SITUATED IN A POPULAR LOCATION CLOSE TO DENMARK HILL STATION.

DESCRIPTION:

The property offers a large open plan kitchen/reception, double bedroom and bathroom. The property is excellently located close to Denmark Hill Station for access on to the overground line and also easy access to both Camberwell and East Dulwich.

AT A GLANCE

- One Double Bedroom
- Ground Floor Flat
- Open Plan Kitchen/Reception
- Modern Bathroom
- Easy Access to Denmark Hill Station

Dulwich | 020 8299 2722 | dulwich@winkworth.co.uk

Tenure Leasehold approx 100 yrs remaining | Council Tax Band A – London Borough of Southwark | Service Charge TBC | Ground Rent TBC

Winkworth





Tayside Court

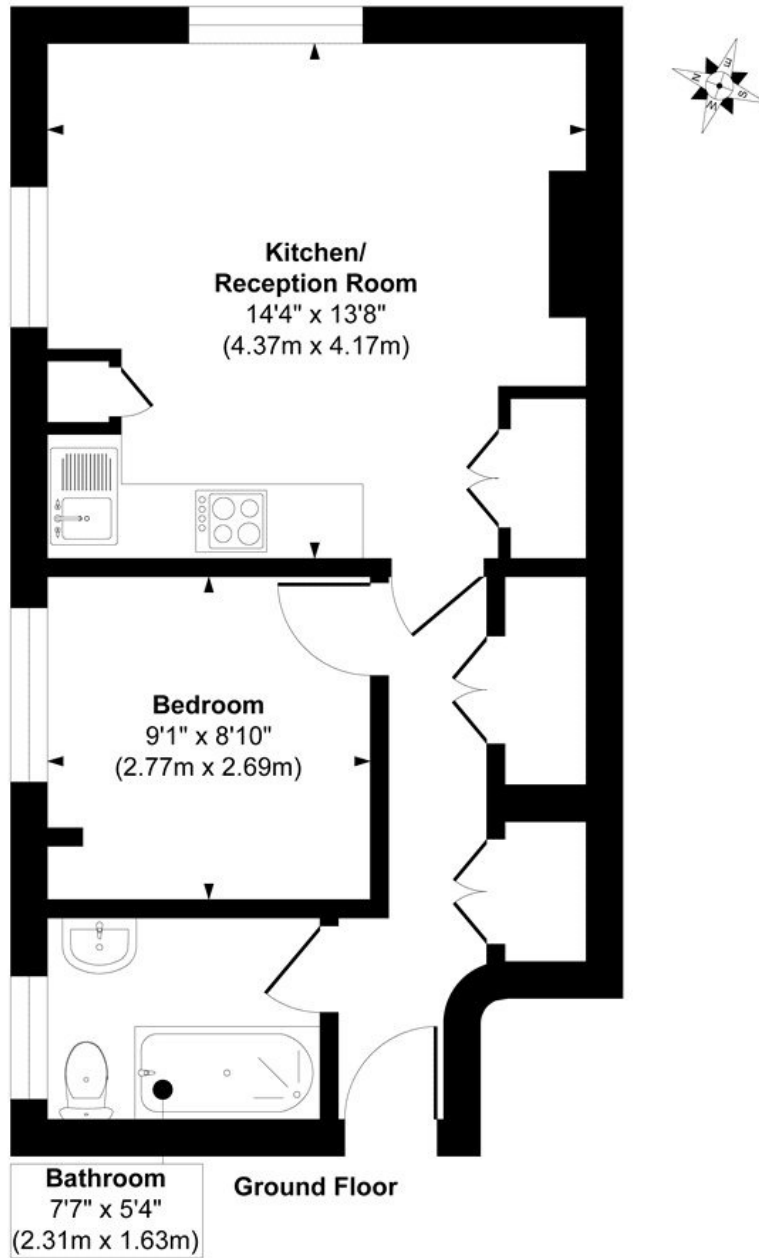

Approx. Gross Internal Floor Area 403 sq. ft / 37.40 sq. m

Illustration for identification purposes only, measurements are approximate, not to scale.

Produced by Elements Property

This floorplan is for illustration purposes only and is not to scale. The position and size of doors, windows, appliances and other features are approximate.

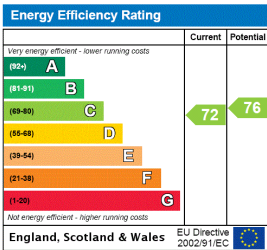

Dulwich | 020 8299 2722 | dulwich@winkworth.co.uk



winkworth.co.uk

See things differently

Winkworth wishes to inform prospective buyers and tenants that these particulars are a guide and act as information only. All our details are given in good faith and believed to be correct at the time of printing but they don't form part of an offer or contract. No Winkworth employee has authority to make or give any representation or warranty in relation to this property. All fixtures and fittings, whether fitted or not are deemed removable by the vendor unless stated otherwise and room sizes are measured between internal wall surfaces, including furnishings.