



Winkworth



Winkworth



Winkworth

REDWOOD RISE, HERTFORDSHIRE, WD6
£540,000 FREEHOLD

A WELL PRESENTED THREE BEDROOM TWO RECEPTION SEMI DETACHED FAMILY HOUSE

Borehamwood | 020 8953 8899 | borehamwood@winkworth.co.uk



DESCRIPTION:

Located in a quiet sought after turning just off Stanborough Avenue is this three bedroom, two reception semi-detached family house.

Having been meticulously maintained, the accommodation totals in excess of 900 square feet and is both well-proportioned and well-presented throughout.

Externally there is a mature rear garden approaching 40' in length and off street parking to the front.

AT A GLANCE

- 3 Bedrooms
- Two Receptions
- 932 Square Feet
- Double Glazed
- Gas Central Heating
- Off Street Parking
- Quiet Cul de Sac





Approximate Gross Internal Area = 86.6 sq m / 932 sq ft

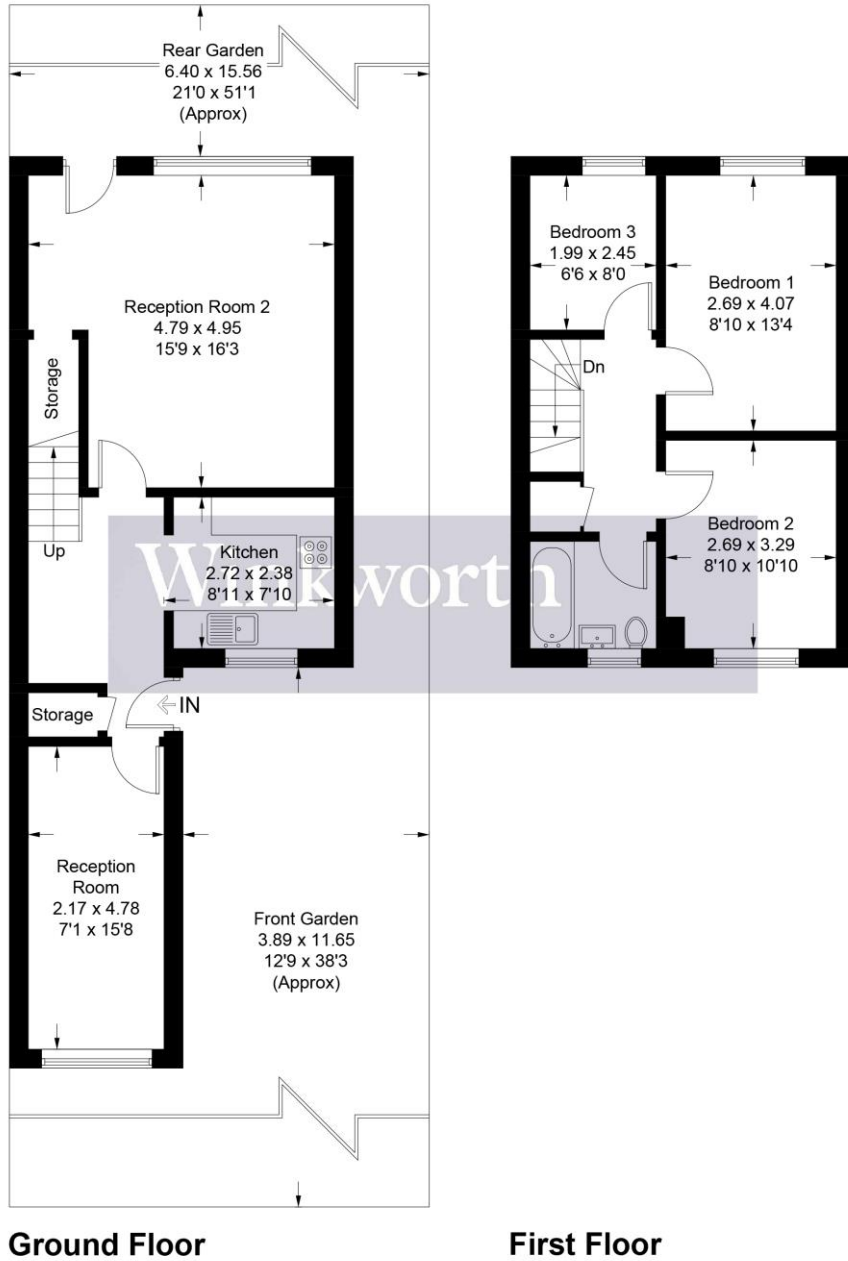
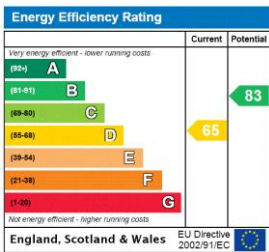

Illustration for identification purposes only, measurements are approximate, not to scale. Winkworth © 2024 (ID1149946)

This floorplan is for illustration purposes only and is not to scale. The position and size of doors, windows, appliances and other features are approximate.



Tenure: Freehold

Term: 0 year and 0 months

Service Charge: £0 per annum

Ground Rent: £ 0 Annually (subject to increase)

Council Tax Band: D

Where no figures are shown, we have been unable to ascertain the information. All figures that are shown were correct at the time of printing.