



ASTRAL HOUSE, MIDDLESEX STREET, LONDON, E1
£575,000 LEASEHOLD

A UNIQUE ONE BEDROOM APARTMENT IN A PERIOD CONVERSION IN THE HEART OF SPITALFIELDS

Shoreditch | 020 7749 7650 | shoreditch@winkworth.co.uk

Winkworth

winkworth.co.uk

See things differently



DESCRIPTION:

Located on the second floor of a converted building, this is a neatly presented large one bedroom apartment situated right in the heart of Spitalfields. The property spans around 656 sq. ft. and is positioned to provide a peaceful living space.

The modern kitchen is separate and offers integrated appliances. The South-West facing living room is light, airy and offers enough space for working from home conditions. The large double bedroom is of generous size and offers a fitted wardrobe as well as a modern mirrored closet. The three-piece family bathroom comes with a bathtub. Given the positioning of the apartment, it is one of the quietest in the development.

Middlesex Street is within a stone's throw of London Liverpool Street (incl. Elizabeth Line), Fenchurch Street, Tower Hill, Aldgate, and Aldgate East stations that connect to The City, Canary Wharf, and all major London airports. You are a short walk from the famous Shoreditch, Spitalfields, and Columbia Flower Market with a wealth of boutique shops cafes and bars and restaurants.

Ground Rent = Peppercorn

Any associated charges including, but not limited to, service charge, ground rent and sinking funds outlined in the marketing material is an approximation calculated using information provided by and described by the client at the time of instruction. The actual cost may be subject to change and therefore we recommend all interested parties carry out their own enquiries.

Winkworth



Winkworth

SECOND FLOOR
656 sq.ft. (61.0 sq.m.) approx.

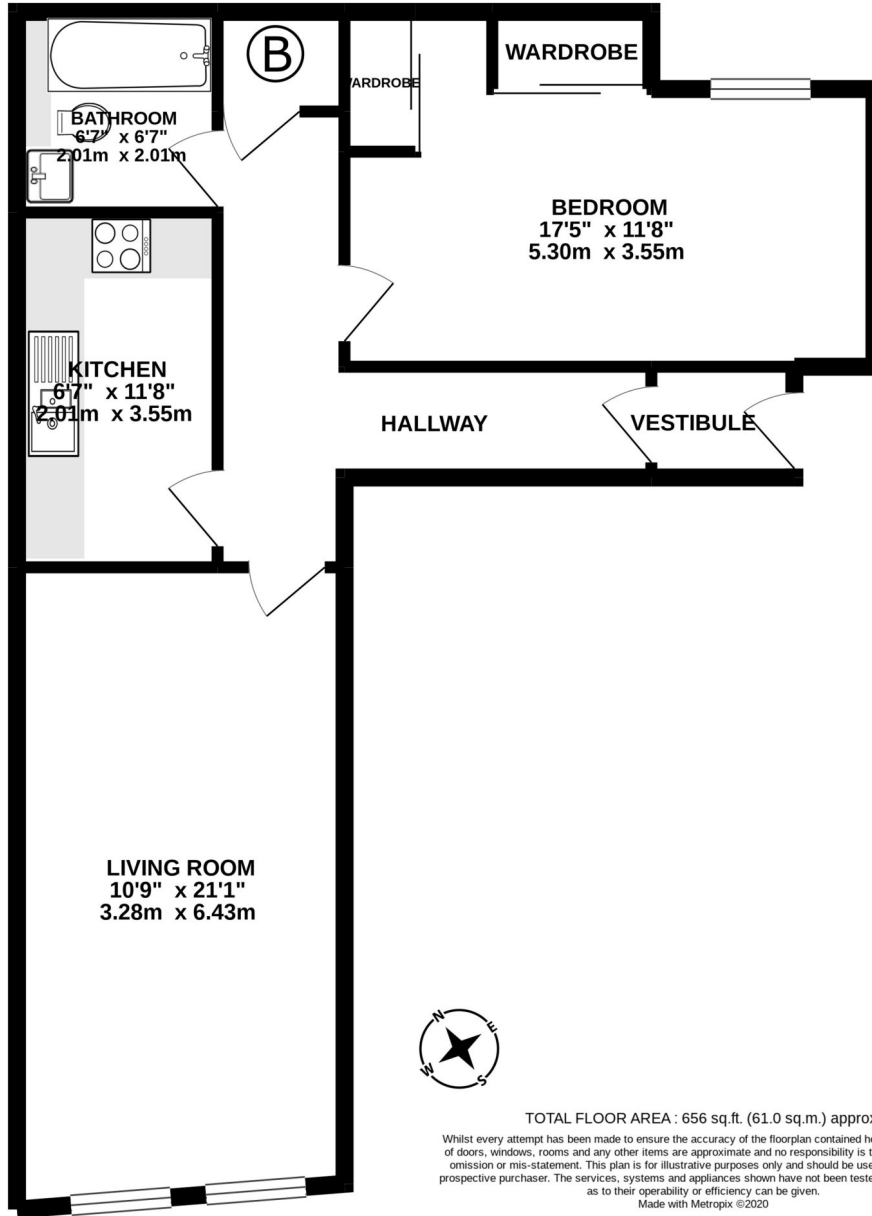

TOTAL FLOOR AREA : 656 sq.ft. (61.0 sq.m.) approx.

Whilst every attempt has been made to ensure the accuracy of the floorplan contained here, measurements of doors, windows, rooms and any other items are approximate and no responsibility is taken for any error, omission or mis-statement. This plan is for illustrative purposes only and should be used as such by any prospective purchaser. The services, systems and appliances shown have not been tested and no guarantee as to their operability or efficiency can be given.
Made with Metropix ©2020

This floorplan is for illustration purposes only and is not to scale. The position and size of doors, windows, appliances and other features are approximate.

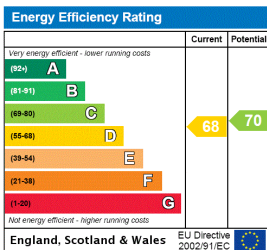

Shoreditch | 020 7749 7650 | shoreditch@winkworth.co.uk



winkworth.co.uk

See things differently

Winkworth wishes to inform prospective buyers and tenants that these particulars are a guide and act as information only. All our details are given in good faith and believed to be correct at the time of printing but they don't form part of an offer or contract. No Winkworth employee has authority to make or give any representation or warranty in relation to this property. All fixtures and fittings, whether fitted or not are deemed removable by the vendor unless stated otherwise and room sizes are measured between internal wall surfaces, including furnishings.