



Binfields Close

Chineham Basingstoke RG24 8TP

Description

This first floor maisonette for the over 55's is offered for sale with no onward chain and requires modernisation. It is set in a popular location close to the Chineham shopping centre.

The front door leads into a hallway with stairs to the first floor. There is a lounge/diner with a pleasant outlook to the front. The kitchen has wall and base mounted storage cupboards with space for appliances.

The bedroom is at the rear and has a built-in wardrobe. There is a shower room with a white suite and a large shower cubicle.

The parking spaces are communal and are on a 'first come, first served' basis and the gardens are also communal.

The property is leasehold with a 99 year term from June 1986 (approximately 61 years remaining). The ground rent is 'Peppercorn' (effectively zero) and the current service charge is £187.74 per month.



Winkworth

Accommodation

- Hallway
- Lounge/diner
- Kitchen
- Bedroom
- Shower room
- Outside store
- Electric heating
- Leasehold
- Requires modernisation

All details are given in good faith and are believed to be correct at time of printing. Winkworth give no representation as to their accuracy and potential purchasers or tenants must satisfy themselves by inspection or otherwise as to their correctness. No employee of Winkworth has authority to make or give any representation or warranty in relation to this property.

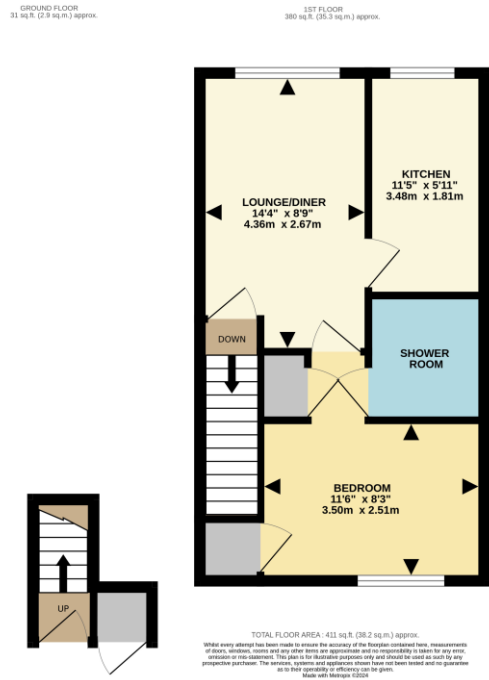

Energy Efficiency Rating		
	Current	Potential
Very energy efficient - lower running costs		
(92+) A		
(81-91) B		
(69-80) C		76
(55-68) D	61	
(39-54) E		
(21-38) F		
(1-20) G		
Not energy efficient - higher running costs		
England, Scotland & Wales	EU Directive 2002/91/EC	



Basingstoke Office

10B Church Street, Basingstoke, Hampshire, RG21 7QE
01256 811730 | basingstoke@winkworth.co.uk

winkworth.co.uk/Basingstoke



See things differently.