



WADHAM ROAD, SW15  
**£2,300 PER MONTH FURNISHED**

## An Architecturally Designed One Bedroom Terraced House with a Separate Study and Roof Terrace in East Putney

Putney | 020 8877 1000 | [putney@winkworth.co.uk](mailto:putney@winkworth.co.uk)

**Winkworth**

for every step...

[winkworth.co.uk](http://winkworth.co.uk)



## **SUMMARY:**

An exciting opportunity to rent an architecturally designed one bedroom house in Putney.

Arranged over three floors this unique property offers contemporary living and high specification finishes throughout. The master bedroom occupies the entire ground floor and boasts extensive built-in wardrobes, rainforest style shower and separate w/c.

On the first floor is an open-plan kitchen/reception room with wood flooring throughout, fully fitted kitchen, breakfast bar and spacious living area. Floor to ceiling windows provide an abundance of natural light.

A separate study area is found on the second floor, perfect for working from home. Off the study is a sunny roof terrace with plenty of space for a table and chairs.

Wadham Road is a quiet residential street, minutes away from East Putney Tube Station (District Line), Putney Mainline Station (Zone 2/3) and the shops, restaurants and bars of Putney High Street. Also close at hand is the wonderful Wandsworth Park and the River Thames Walk.

## **ACCOMMODATION**

Long Let, 1 Bedroom, 1 Reception Room, 1 Bathroom, House, Terraced, Roof Terrace, Study, Residents Parking, Modern, Town/City, Furnished, 580 Approx Sq Ft



## Wadham Road, SW15

Approx. Gross Internal Area 53.88 sq m / 580 sq ft

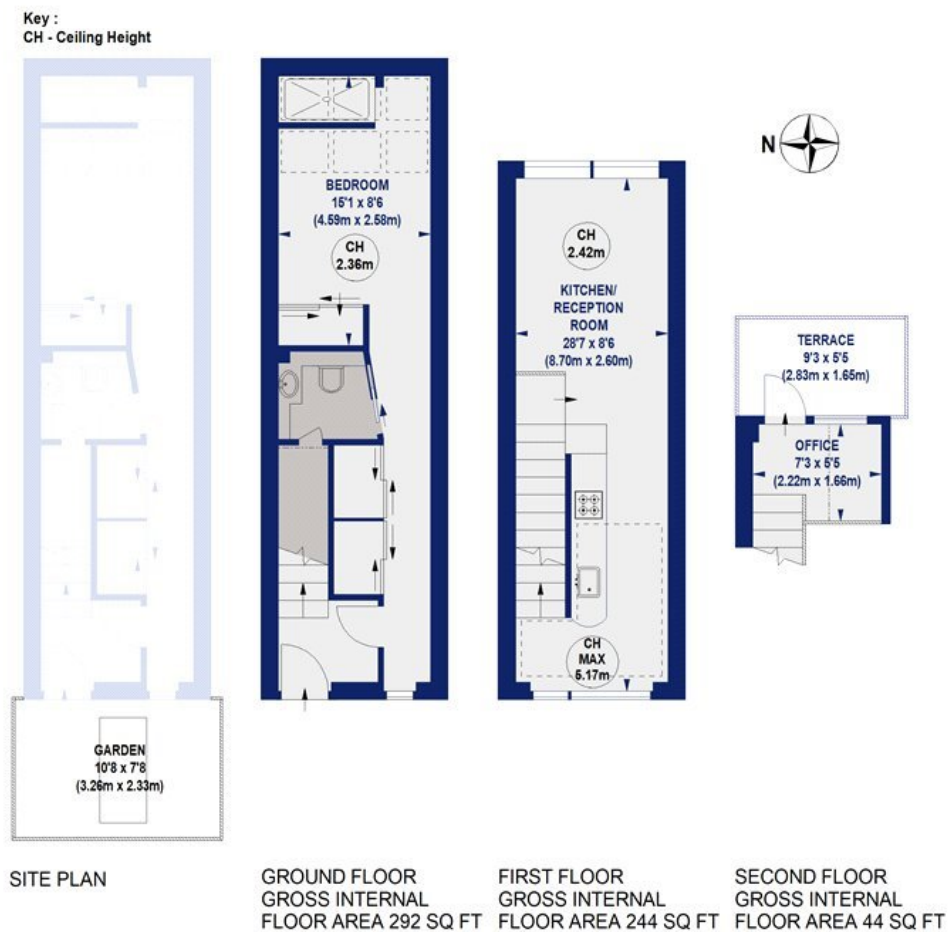

Not to scale, for guidance only and must not be relied upon as a statement of fact.  
All measurements and areas are approximate only

**Winkworth**

This floorplan is for illustration purposes only and is not to scale. The position and size of doors, windows, appliances and other features are approximate.

**Deposit:** 5 weeks' rent

**Holding Deposit:** 1 week's rent

**Council Tax Band:** TBC

Where no figures are shown, we have been unable to ascertain the information. All figures that are shown were correct at the time of printing.

Putney | 020 8877 1000 | [putney@winkworth.co.uk](mailto:putney@winkworth.co.uk)

**Winkworth**

for every step...

[winkworth.co.uk](http://winkworth.co.uk)

Winkworth wishes to inform prospective buyers and tenants that these particulars are a guide and act as information only. All our details are given in good faith and believed to be correct at the time of printing but they don't form part of an offer or contract. No Winkworth employee has authority to make or give any representation or warranty in relation to this property. All fixtures and fittings, whether fitted or not are deemed removable by the vendor unless stated otherwise and room sizes are measured between internal wall surfaces, including furnishings.