



BRIDEL MEWS, LONDON, N1
£1,295,000 FREEHOLD

A WONDERFUL TWO BEDROOM MEWS HOUSE IN THE HEART OF ANGEL WITH DRIVEWAY

Islington | 0207 354 2480 | islington@winkworth.co.uk

Winkworth

winkworth.co.uk

See things differently



DESCRIPTION:

Set moments from Upper Street is this fantastic two-bedroom freehold house in a secure, gated development with private driveway. Accommodation includes two double bedrooms with the master bedroom benefitting from an ensuite bathroom, a family bathroom, an office and open plan kitchen/living room that leads out to a private balcony.

Bridel Mews is exceptionally well located in the heart of Islington and is nestled amongst some of Islington's finest addresses. The property, whilst set amongst peaceful treelined roads, is just a stone's throw from Upper Street and the boutique shops and restaurants on Camden Passage as well as being within easy reach of Regents Canal. Transport links are exceptional with Angel station providing the closest underground links on the Northern line and various overground and underground services provided at Kings Cross.

Winkworth



Winkworth

Bridel Mews, N1

Approx. Gross Internal Floor Area 1012 sq. ft / 93.98 sq. m

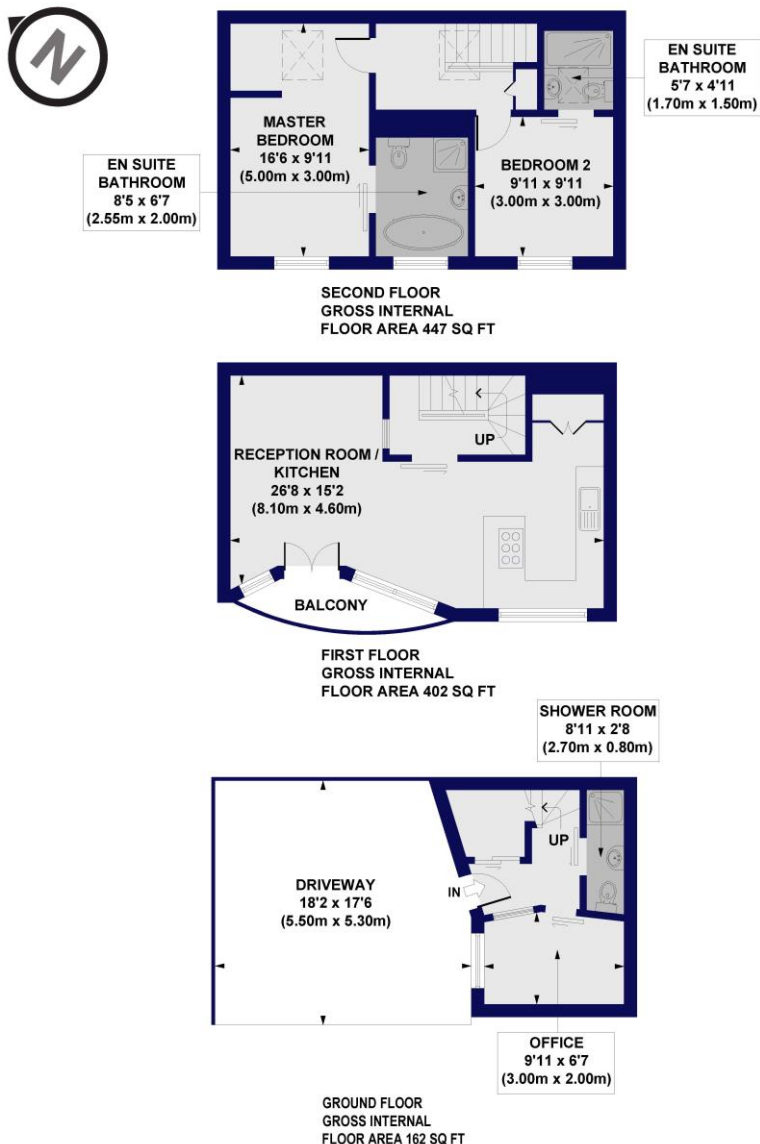

All measurements of walls, doors, windows, fittings and appliances, including their size and location, are shown as standard sizes and do not constitute any warranty or representation by the seller, their agent or CP Creative. Any intending purchaser must satisfy himself by inspection or otherwise as to the correctness of the information contained in these plans. This plan is for illustrative purposes only and should be used as such by any prospective purchasers.

Winkworth

This floorplan is for illustration purposes only and is not to scale. The position and size of doors, windows, appliances and other features are approximate.

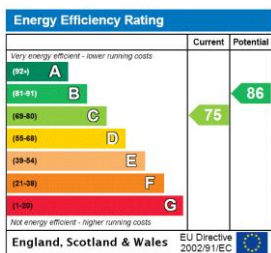

Islington | 0207 354 2480 | islington@winkworth.co.uk



winkworth.co.uk

See things differently

Winkworth wishes to inform prospective buyers and tenants that these particulars are a guide and act as information only. All our details are given in good faith and believed to be correct at the time of printing but they don't form part of an offer or contract. No Winkworth employee has authority to make or give any representation or warranty in relation to this property. All fixtures and fittings, whether fitted or not are deemed removable by the vendor unless stated otherwise and room sizes are measured between internal wall surfaces, including furnishings.