



ROWENA CRESCENT, SW11  
£585,000 SHARE OF FREEHOLD

## A FIRST AND SECOND FLOOR SPLIT LEVEL FLAT WITH TWO DOUBLE BEDROOM'S

Tooting | 020 8767 5221 | [tooting@winkworth.co.uk](mailto:tooting@winkworth.co.uk)

**Winkworth**

for every step...

[winkworth.co.uk](http://winkworth.co.uk)



## **DESCRIPTION:**

A bright top-floor two-bedroom flat on Rowena Crescent, Battersea. This property features two double bedrooms, with stairs leading to a landing that opens into a spacious reception room with a large bay window and fireplace. The fitted kitchen includes a range of base and eye-level units, and there is a bright bathroom.

The flat is offered for sale with a share of the freehold and no onward chain.

Rowena Crescent is ideally situated between Battersea Park and Clapham Junction. Battersea Park is a beautiful 200-acre Victorian park, offering a lake, ecological areas, and recreational facilities such as tennis courts, playgrounds, and cafés. The property is close to a variety of shops and restaurants and benefits from excellent schools and superb transport links. Clapham Junction, approximately 0.6 miles away, provides connections to London Victoria, London Waterloo, and Vauxhall.

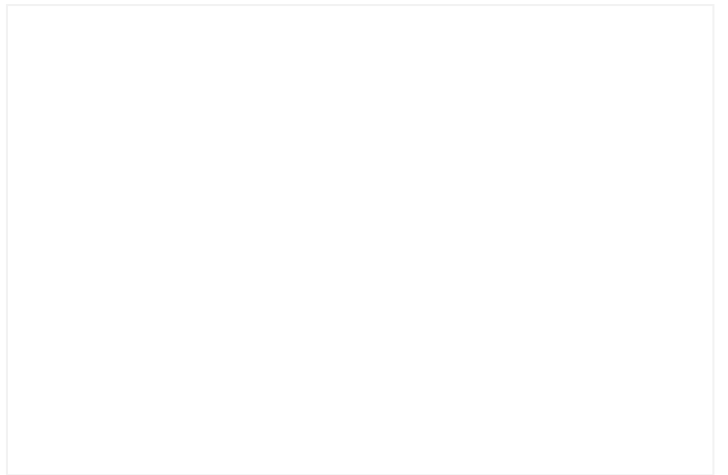

# Rowena Crescent, SW11

Approx. Gross Internal Floor Area 715 sq. ft / 66.41 sq. m (Including Restricted Height Area)  
 Approx. Gross Internal Floor Area 673 sq. ft / 62.54 sq. m (Excluding Restricted Height Area)

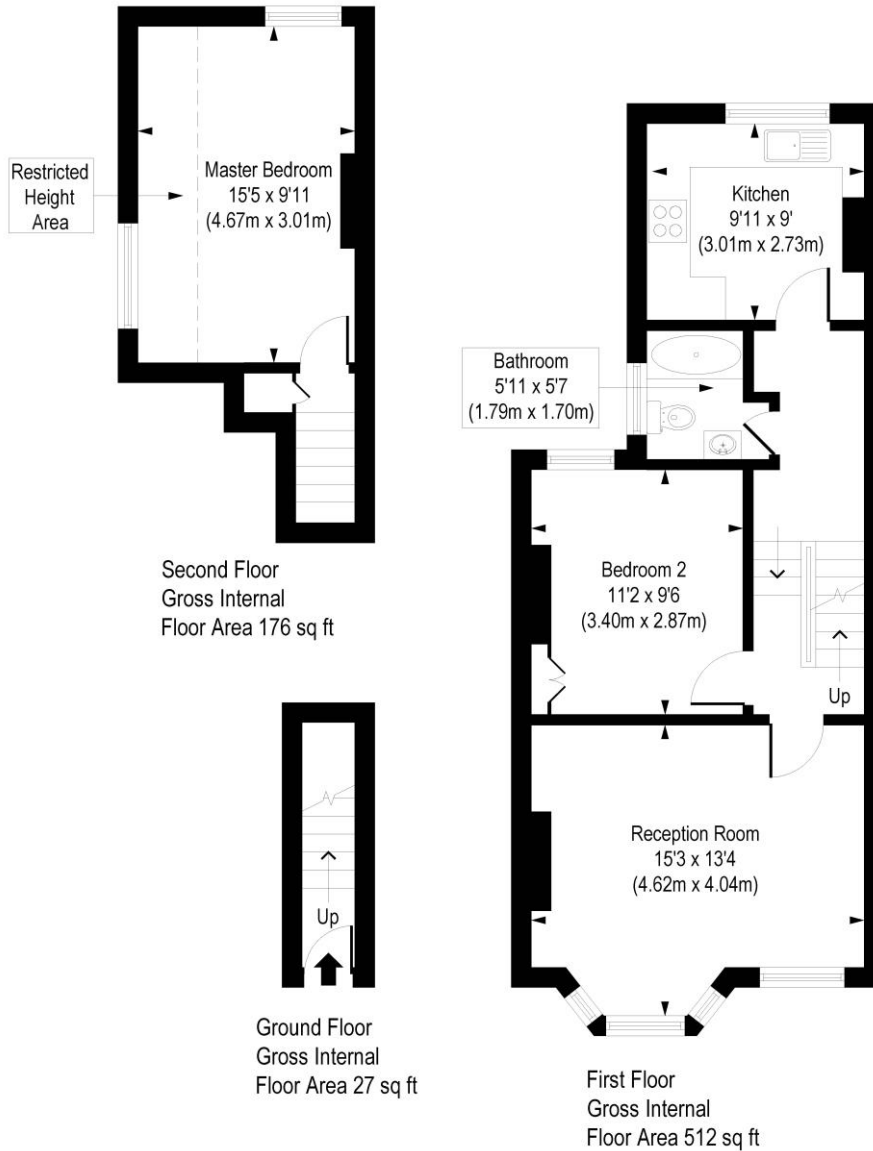

COMPLIANT WITH RICS CODE OF MEASURING PRACTICE. Floorplan is for illustrative purposes only and is not to scale. Every attempt has been made to ensure the accuracy of the floorplan shown, however all measurements, fixtures, fittings and data shown are an approximate interpretation for illustrative purposes only. Liability for errors, omissions or mis-statement through negligence or otherwise is hereby excluded.

This floorplan is for illustration purposes only and is not to scale. The position and size of doors, windows, appliances and other features are approximate.

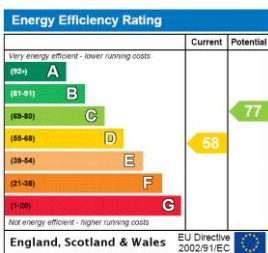

Tooting | 020 8767 5221 | tooting@winkworth.co.uk

for every step...

winkworth.co.uk

Winkworth wishes to inform prospective buyers and tenants that these particulars are a guide and act as information only. All our details are given in good faith and believed to be correct at the time of printing but they don't form part of an offer or contract. No Winkworth employee has authority to make or give any representation or warranty in relation to this property. All fixtures and fittings, whether fitted or not are deemed removable by the vendor unless stated otherwise and room sizes are measured between internal wall surfaces, including furnishings.