



IVYBRIDGE HOUSE, EAST DULWICH ESTATE, LONDON SE22
OIEO £425,000 LEASEHOLD

A LARGE, SPLIT LEVEL TWO DOUBLE-BEDROOM APARTMENT IN A PRIME EAST DULWICH LOCATION, CLOSE TO LOCAL AMENITIES.

Dulwich | 020 8299 2722 | dulwich@winkworth.co.uk

Tenure Leasehold New 117yr Lease | Council Tax Band B – London Borough of Southwark | Service Charge £1,161.64pa Ground Rent £200pa

Winkworth

winkworth.co.uk

See things differently



DESCRIPTION:

A large, split-level two double-bedroom apartment in a prime East Dulwich location, close to local amenities and just a short walk from East Dulwich train station and the vibrant shops, bars, and restaurants of Lordship Lane. The property boasts wood flooring in the main rooms and on the stairs, adding an elegant touch to the spacious lounge and modern, fully fitted kitchen on the entry floor. A shower room is also located on this level. Upstairs, the two double bedrooms offer generous space, with the second bedroom providing beautiful views across the neighborhood. The flat is finished to a high specification throughout, with large windows that allow natural light to flood the living spaces, creating a bright and airy atmosphere. Perfectly positioned for easy access to the shops, bars, and restaurants of Lordship Lane, Camberwell, and Peckham Rye. Transport links are excellent, with Denmark Hill station for the overground and East Dulwich station providing direct links to London Bridge. Early viewings are highly recommended.

AT A GLANCE

- Prime Location
- Modern and Spacious
- Two Double Bedrooms
- Light and Airy
- Excellent Transport Links





Ivybridge House

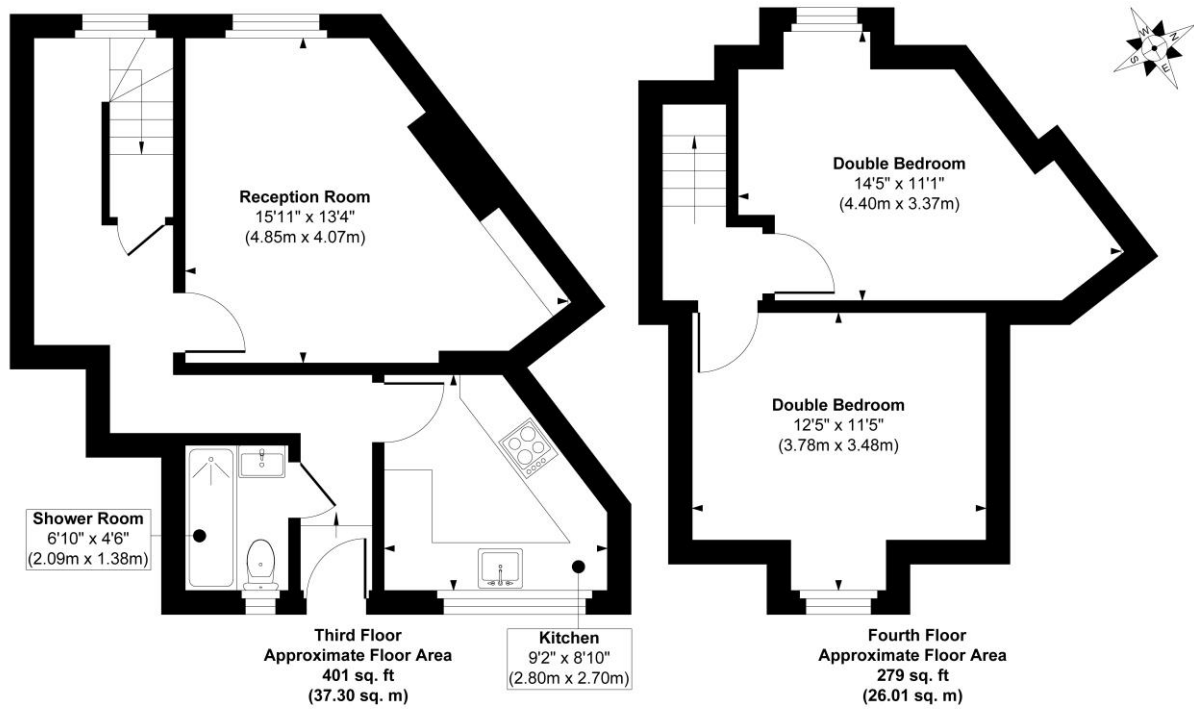

Approx. Gross Internal Floor Area 680 sq. ft / 63.31 sq. m

Illustration for identification purposes only, measurements are approximate, not to scale.

Produced by Elements Property

This floorplan is for illustration purposes only and is not to scale. The position and size of doors, windows, appliances and other features are approximate.

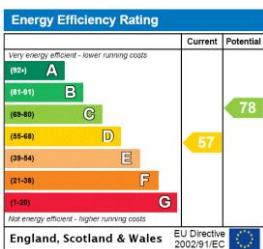

Dulwich | 020 8299 2722 | dulwich@winkworth.co.uk

Winkworth

winkworth.co.uk

See things differently

Winkworth wishes to inform prospective buyers and tenants that these particulars are a guide and act as information only. All our details are given in good faith and believed to be correct at the time of printing but they don't form part of an offer or contract. No Winkworth employee has authority to make or give any representation or warranty in relation to this property. All fixtures and fittings, whether fitted or not are deemed removable by the vendor unless stated otherwise and room sizes are measured between internal wall surfaces, including furnishings.