



12 GROVELANDS PARK, WINNERSH, WOKINGHAM, BERKSHIRE, RG41 5LD
£150,000 TO BE ADVISED

THIS EXTENDED THREE BEDROOM PARK HOME SITS ON A WONDERFUL DOUBLE PLOT AND IS CONVENIENTLY SITUATED ON THE FAMILY AND PET FRIENDLY GROVELANDS PARK IN WINNERSH WITHIN CLOSE PROXIMITY TO AMENITIES.



Wokingham | 01189 072777 | wokingham@winkworth.co.uk

for every step...

winkworth.co.uk



DESCRIPTION:

This extended three bedroom park home sits on a wonderful double plot and is conveniently situated on the family and pet friendly Grovelands Park in Winnersh within close proximity to amenities.

You enter this property into a porch area perfect for removing your shoes and coats. Inside the accommodation includes; main lounge, dining room/bedroom 3, kitchen, utility room with separate WC, family bathroom & two double bedrooms.

To the rear you'll find an magnificent garden space laid mainly to lawn with multiple sheds and a decking area. The whole property also benefits from an abundance of light coming through the many windows, gas central heating, multiple spaces for off road parking. private garden space.

Please note there is a charge of approximately £211.48 mth for ground rent which includes water bills.

AT A GLANCE

- No Onward Chain
- Pet Friendly
- No Age Restrictions
- Cash Buyers Only
- 3 Bedrooms
- Large Plot
- Driveway Parking
- Council Tax Band A



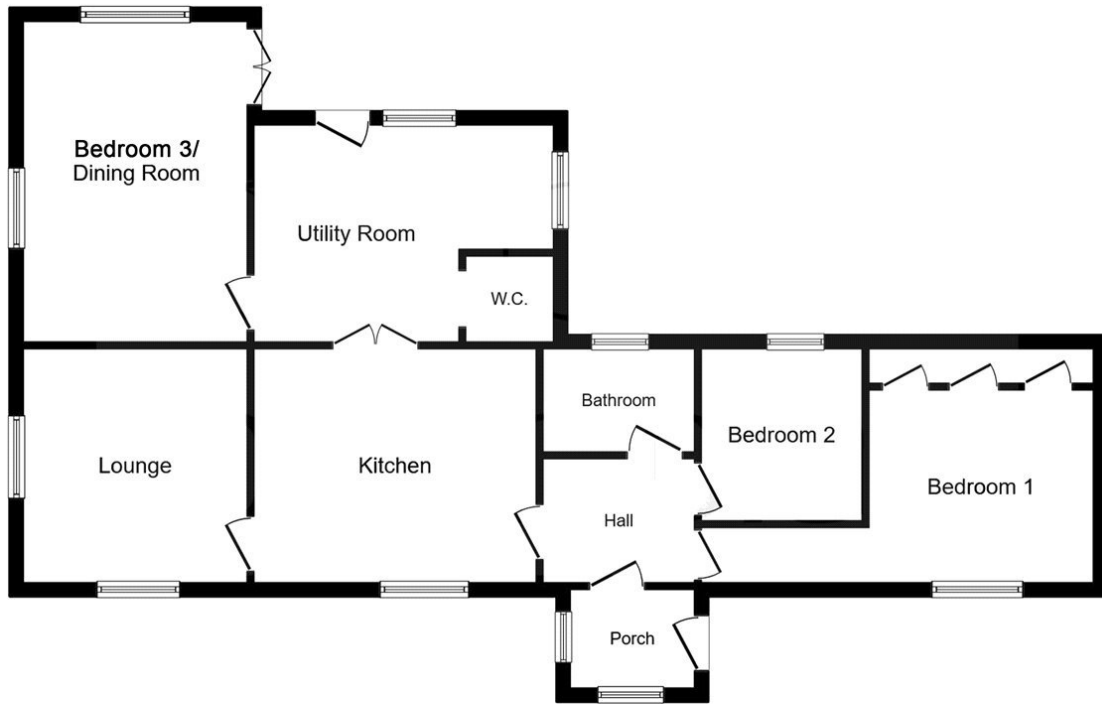

This floorplan is for illustration purposes only and is not to scale. The position and size of doors, windows, appliances and other features are approximate.

Wokingham | 01189 072777 | wokingham@winkworth.co.uk



for every step...

winkworth.co.uk

Winkworth wishes to inform prospective buyers and tenants that these particulars are a guide and act as information only. All our details are given in good faith and believed to be correct at the time of printing but they don't form part of an offer or contract. No Winkworth employee has authority to make or give any representation or warranty in relation to this property. All fixtures and fittings, whether fitted or not are deemed removable by the vendor unless stated otherwise and room sizes are measured between internal wall surfaces, including furnishings.