



SIAMESE MEWS, FINCHLEY, LONDON, N3
£339,000 FREEHOLD

FANTASTIC NEWLY DEVELOPED LIVE/WORK MEWS HOUSES

Finchley | 020 8349 3388 | finchley@winkworth.co.uk



DESCRIPTION:

We are pleased to offer for sale 3 newly developed live /work mews houses. These properties have been developed to a very high spec and include open plan kitchen/living/work areas, wc's, double bedrooms and shower rooms to the first floor, outside space and CAT 6 system ready for connection. These mews houses are ideally located in the heart of Finchley Central, within a stone's throw of the underground, amenities and transport links.

They truly are unique and quirky dwellings and internal viewings for FTB or INVESTORS is highly recommended. The property is being offered on a chain free basis with the freehold.

PLEASE NOTE: SPECIFIC MORTGAGE REQUIRED-CONSULTANT IN PLACE

AT A GLANCE

- Three brand new Mews live/work houses
- Two x 1 bedrooms and one x 2 bedroom available
- Modern fitted kitchens shower rooms & wc's
- Freehold
- Offered chain free
- Ideal purchase for a FTB OR BTL





Siamese Mews, N3
Approx. Gross Internal Floor Area 426 sq. ft / 39.60 sq. m

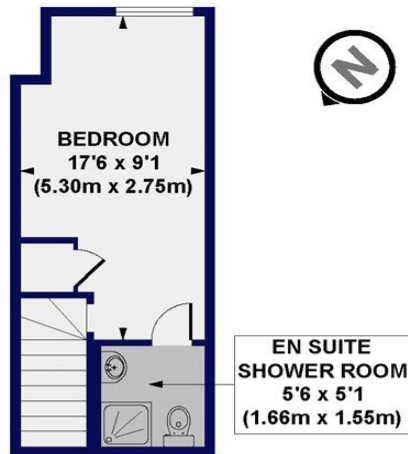

FIRST FLOOR
GROSS INTERNAL
FLOOR AREA 204 SQ FT

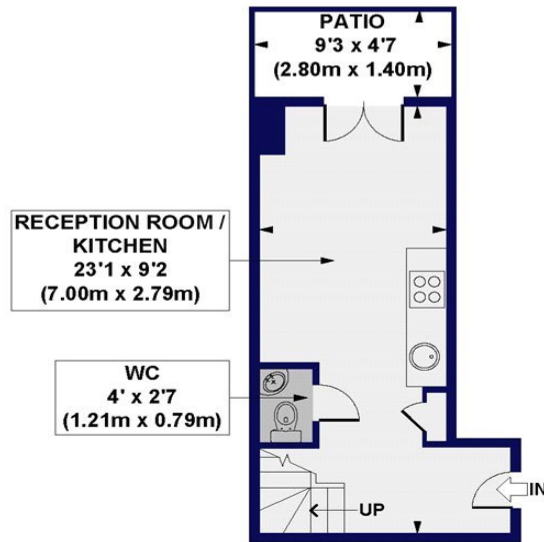

GROUND FLOOR
GROSS INTERNAL
FLOOR AREA 222 SQ FT

All measurements of walls, doors, windows, fittings and appliances including their size and location, are shown as standard sizes and do not constitute any warranty or representation by the seller, their agent or CP Creative. Any intending purchaser must satisfy himself by inspection or otherwise as to the correctness of the information contained in these plans. This plan is for illustrative purposes only and should be used as such by any prospective purchasers.

Winkworth