



CLYDESDALE CLOSE, WD6

£225,000 LEASEHOLD

CHAIN FREE ONE BEDROOM PURPOSE BUILT FLAT

Borehamwood | 020 8953 8899 | borehamwood@winkworth.co.uk



Winkworth

DESCRIPTION:

Winkworth are pleased to offer for Sale this one bedroom first floor flat on a Chain Free basis.

The property comprises lounge/diner with a separate kitchen, double bedroom with fitted wardrobes. and shower room. Property underwent a refurbishment approximately two years ago including new kitchen & bathroom.

The property has good access to the A1 and Furzehill Road, which will in turn lead to Borehamwood with its large array of shops, restaurants and transport links. Ideal purchase for a First Time Buyer or investors. Viewing highly recommended.

AT A GLANCE

- 1 Bedroom
- Entrance Hall
- Kitchen
- Shower Room
- Living Room



Winkworth



Winkworth



Winkworth

Approximate Gross Internal Area = 53.2 sq m / 573 sq ft

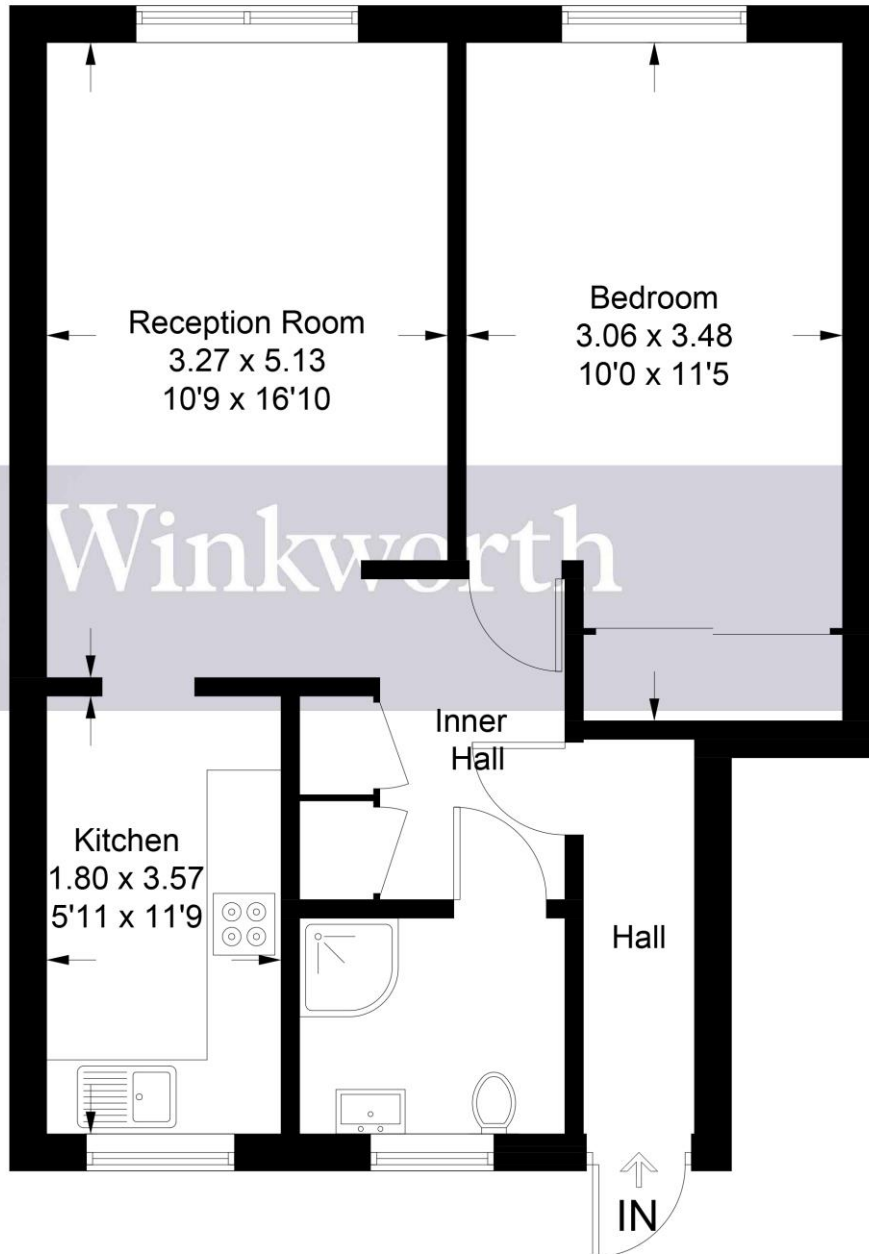

Illustration for identification purposes only, measurements are approximate, not to scale. Winkworth © 2024 (ID1135187)

This floorplan is for illustration purposes only and is not to scale. The position and size of doors, windows, appliances and other features are approximate.

Energy Efficiency Rating		
	Current	Potential
Very energy efficient - lower running costs		
(92-100) A		
(81-91) B		
(69-80) C	78	79
(55-68) D		
(39-54) E		
(21-38) F		
(1-20) G		
Not energy efficient - higher running costs		
England, Scotland & Wales	EU Directive 2002/91/EC	

Tenure: Leasehold

Term: 84 year and 4 months

Service Charge: £0 per annum

Ground Rent: £ 0 Annually (subject to increase)

Council Tax Band: B

Where no figures are shown, we have been unable to ascertain the information. All figures that are shown were correct at the time of printing.