



**SOUTHSTAND APARTMENTS, Highbury Stadium Square, London, N5
£525,000 LEASEHOLD**

**A MODERN TWO BEDROOM FLAT WITH PRIVATE
BALCONY LOCATED ON THE SECOND FLOOR OF
THIS ICONIC DEVELOPMENT**

Islington | 0207 354 2480 | islington@winkworth.co.uk

Winkworth

winkworth.co.uk

See things differently



DESCRIPTION:

This generous two-bedroom apartment is set over the second floor of this popular development which occupies the grounds of the old Arsenal Stadium. The property spans 721sqft of lateral living space with private balcony and offers beautifully presented and light filled rooms throughout. Accommodation consists of a bright, open plan living room and kitchen which provides a wonderfully social entertaining space and is flooded in light though large windows and east facing aspect. Both double bedrooms are of even proportions with the master benefitting from inbuilt storage and access to a peaceful private balcony. The family sized bathroom has been fully tiled in a contemporary style and ample storage is located off the hallway. The property benefits from access to stunning landscaped communal gardens as well as concierge and secure entry.

Highbury Stadium Square is perfectly situated for an array of local amenities, including independent shops, restaurants and coffee shops, as well as being in easy reach of three local parks and Gillespie nature reserve. Upper Street is only a short distance away and transport links are some of the best around, with Arsenal station providing the Piccadilly line and Finsbury Park offering overground services (including the Thameslink network serving the City and Gatwick Airport) and underground services including the Victoria line. Drayton Park also provides direct links to Moorgate, whilst numerous bus routes offer effortless transport to the City and West End.

Winkworth



Winkworth

Southstand Apartments, Highbury Stadium Square, N5
 Approx. Gross Internal Floor Area 721 sq. ft / 66.94 sq. m

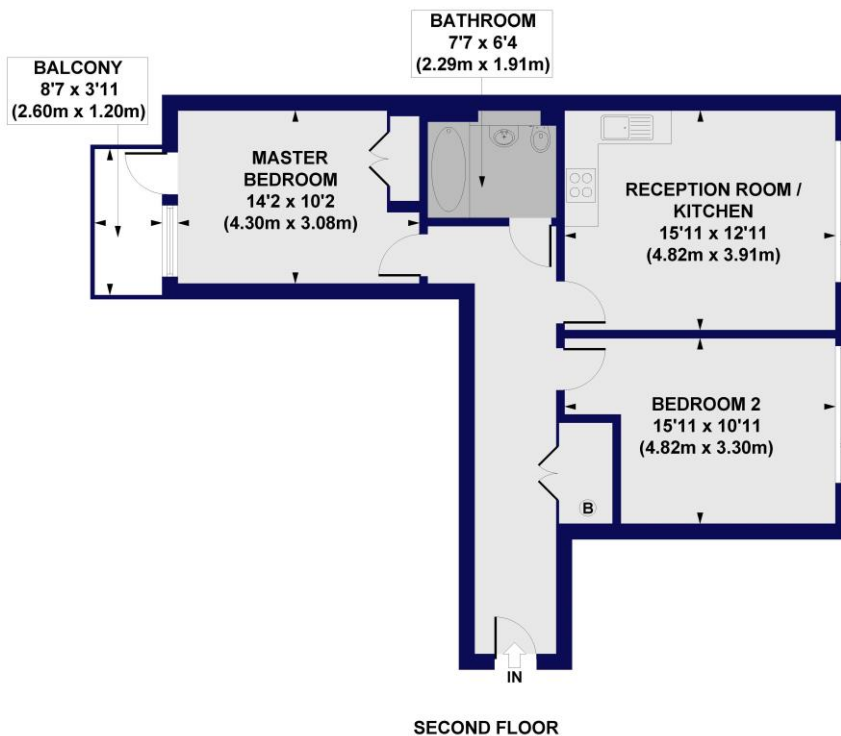

All measurements of walls, doors, windows, fittings and appliances, including their size and location, are shown as standard sizes and do not constitute any warranty or representation by the seller, their agent or CP Creative. Any intending purchaser must satisfy himself by inspection or otherwise as to the correctness of the information contained in these plans. This plan is for illustrative purposes only and should be used as such by any prospective purchasers.

Winkworth

This floorplan is for illustration purposes only and is not to scale. The position and size of doors, windows, appliances and other features are approximate.

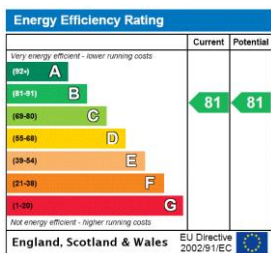

Islington | 0207 354 2480 | islington@winkworth.co.uk



winkworth.co.uk

See things differently

Winkworth wishes to inform prospective buyers and tenants that these particulars are a guide and act as information only. All our details are given in good faith and believed to be correct at the time of printing but they don't form part of an offer or contract. No Winkworth employee has authority to make or give any representation or warranty in relation to this property. All fixtures and fittings, whether fitted or not are deemed removable by the vendor unless stated otherwise and room sizes are measured between internal wall surfaces, including furnishings.