



LONG LANE, LONDON, N3  
£675,000 LEASEHOLD

## A SPACIOUS TWO BEDROOM GROUND FLOOR FLAT SET IN A PERIOD BUILDING

Finchley | 020 8349 3388 | [finchley@winkworth.co.uk](mailto:finchley@winkworth.co.uk)

**Winkworth**

for every step...

[winkworth.co.uk](http://winkworth.co.uk)



## DESCRIPTION:

A Must See!!

A beautifully presented and spacious two double bedroom ground floor Edwardian conversion flat with a private garden. Situated within walking distance to Finchley Central underground, Victoria Park, Outstanding Ofsted Rated schools and local amenities, this lovely property comprises of two double bedrooms, fitted wardrobes in the primary bedroom, a lovely modern fitted kitchen & bathroom, extended living / dining room leading out on to a private South facing garden with a wonderful outbuilding to the rear of the garden to accommodate a working from home life style or gym / games area with the full benefit of electricity and plumbing. The property is being offered with a long lease and an internal viewing is highly recommended.

## AT A GLANCE

- Period Conversion
- Ground Floor
- Two large bedrooms
- Spacious reception room
- Modern fitted Kitchen & Bathroom
- Private south facing garden
- Outbuilding with full power and plumbing
- Long Lease





## Long Lane, N3

Approx. Gross Internal Floor Area 1068 sq. ft / 99.23 sq. m (Including Studio)

Approx. Gross Internal Floor Area 909 sq. ft / 84.03 sq. m (Excluding Studio)

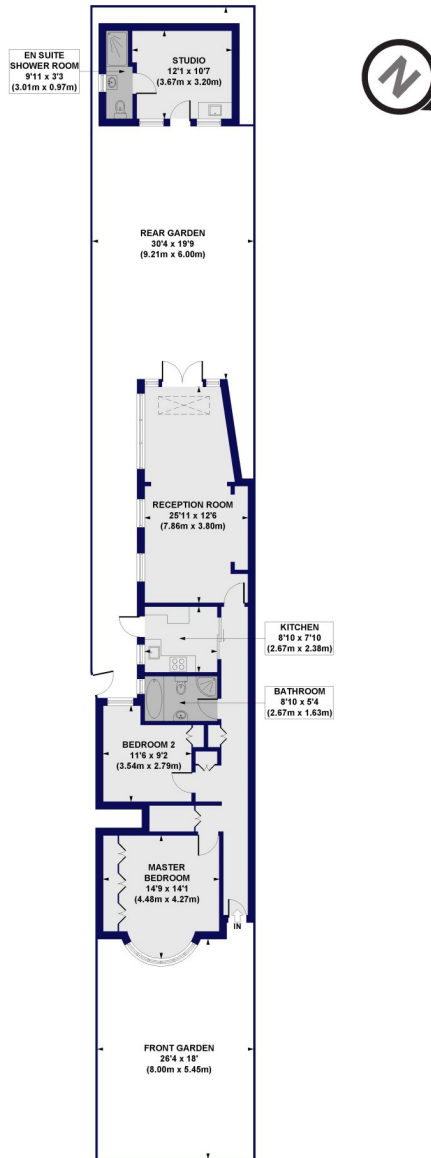

All measurements of walls, doors, windows, fittings and appliances, including their size and location, are shown as standard sizes and do not constitute any warranty or representation by the seller, their agent or CP Creative. Any intending purchaser must satisfy himself by inspection or otherwise as to the correctness of the information contained in these plans. This plan is for illustrative purposes only and should be used as such by any prospective purchasers.

**Winkworth**

This floorplan is for illustration purposes only and is not to scale. The position and size of doors, windows, appliances and other features are approximate.

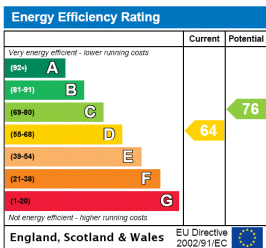

Finchley | 020 8349 3388 | finchley@winkworth.co.uk

**Winkworth**

for every step...

[winkworth.co.uk](http://winkworth.co.uk)

Winkworth wishes to inform prospective buyers and tenants that these particulars are a guide and act as information only. All our details are given in good faith and believed to be correct at the time of printing but they don't form part of an offer or contract. No Winkworth employee has authority to make or give any representation or warranty in relation to this property. All fixtures and fittings, whether fitted or not are deemed removable by the vendor unless stated otherwise and room sizes are measured between internal wall surfaces, including furnishings.