



BARING STREET, LONDON, N1
OFFERS IN EXCESS OF £318,500 SHARE OF FREEHOLD

A CHARMING STUDIO APARTMENT IN A PERIOD CONVERSION NEAR SHOREDITCH PARK

Islington | 0207 354 2480 | islington@winkworth.co.uk

Winkworth

winkworth.co.uk

See things differently



DESCRIPTION:

A charming studio apartment with separate kitchen in an Edwardian conversion perfectly located on a quiet residential street near the Shoreditch Park and the Regent's Canal.

The accommodation is well laid out, with the south-east-facing kitchen and the north-west-facing bedroom positioned on either side of the hallway. The three-piece bathroom, with a window and a bathtub is located at the end of the hallway. The property also offers the exciting potential to expand into the attic space, subject to planning permission and necessary consents.

The property is conveniently located moments from the popular of amenities on Southgate Road, whilst being well placed for access to Islington, Hoxton, and Shoreditch, with an array of trendy bars, restaurants, galleries, and boutique shops. Old Street Station (Northern line and Great Northern) is only 0.8 miles and provides easy access to the city. Nearby green spaces, including Rosemary Gardens and Shoreditch Park, along with the scenic Regent's Canal, are easily accessible for outdoor enjoyment.

Winkworth



Winkworth

Baring Street, N1

Approx. Gross Internal Floor Area 252 sq. ft / 23.41 sq. m

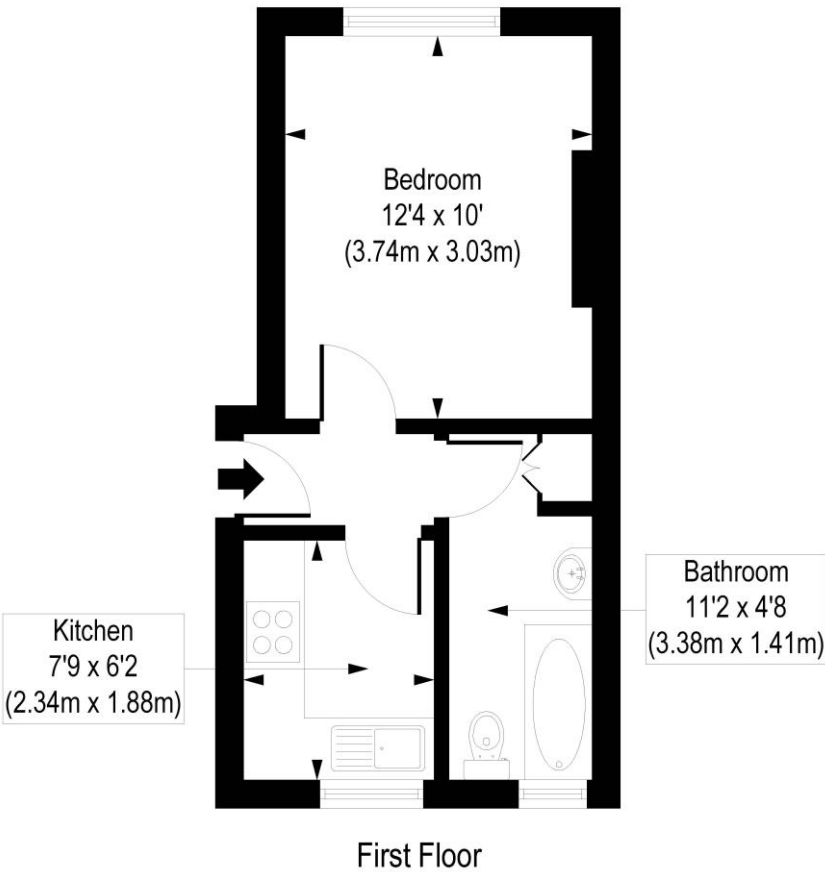

COMPLIANT WITH RICS CODE OF MEASURING PRACTICE. Floorplan is for illustrative purposes only and is not to scale. Every attempt has been made to ensure the accuracy of the floorplan shown, however all measurements, fixtures, fittings and data shown are an approximate interpretation for illustrative purposes only. Liability for errors, omissions or mis-statement through negligence or otherwise is hereby excluded.

This floorplan is for illustration purposes only and is not to scale. The position and size of doors, windows, appliances and other features are approximate.

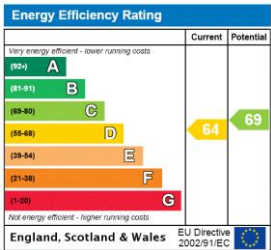

Islington | 0207 354 2480 | islington@winkworth.co.uk



winkworth.co.uk

See things differently

Winkworth wishes to inform prospective buyers and tenants that these particulars are a guide and act as information only. All our details are given in good faith and believed to be correct at the time of printing but they don't form part of an offer or contract. No Winkworth employee has authority to make or give any representation or warranty in relation to this property. All fixtures and fittings, whether fitted or not are deemed removable by the vendor unless stated otherwise and room sizes are measured between internal wall surfaces, including furnishings.