



PUTNEY HIGH STREET, SW15  
**£2,400 PER MONTH**

## A newly refurbished split-level two bedroom flat with a roof terrace in the heart of Putney

Putney | 020 8877 1000 | [putney@winkworth.co.uk](mailto:putney@winkworth.co.uk)

**Winkworth**

for every step...

[winkworth.co.uk](http://winkworth.co.uk)



### **DESCRIPTION:**

This bright and spacious property has just been refurbished to a high standard throughout.

Extending to 933 sq. ft and accessed via a large roof terrace there is an eat-in kitchen and separate reception room on the first floor. On the second floor there are two generous double bedrooms which are serviced by a modern bathroom with walk-in shower.

Accessed from Disraeli Road the flat is situated on Putney High Street, where there are a variety of coffee shops, restaurants and bars. The flat is a <0.1 miles from Putney Station (South Western Railway) and 0.4 miles from East Putney Station (District Line).



Putney High Street, SW15  
Approx. Gross Internal Floor Area 933 sq. ft / 86.70 sq. m

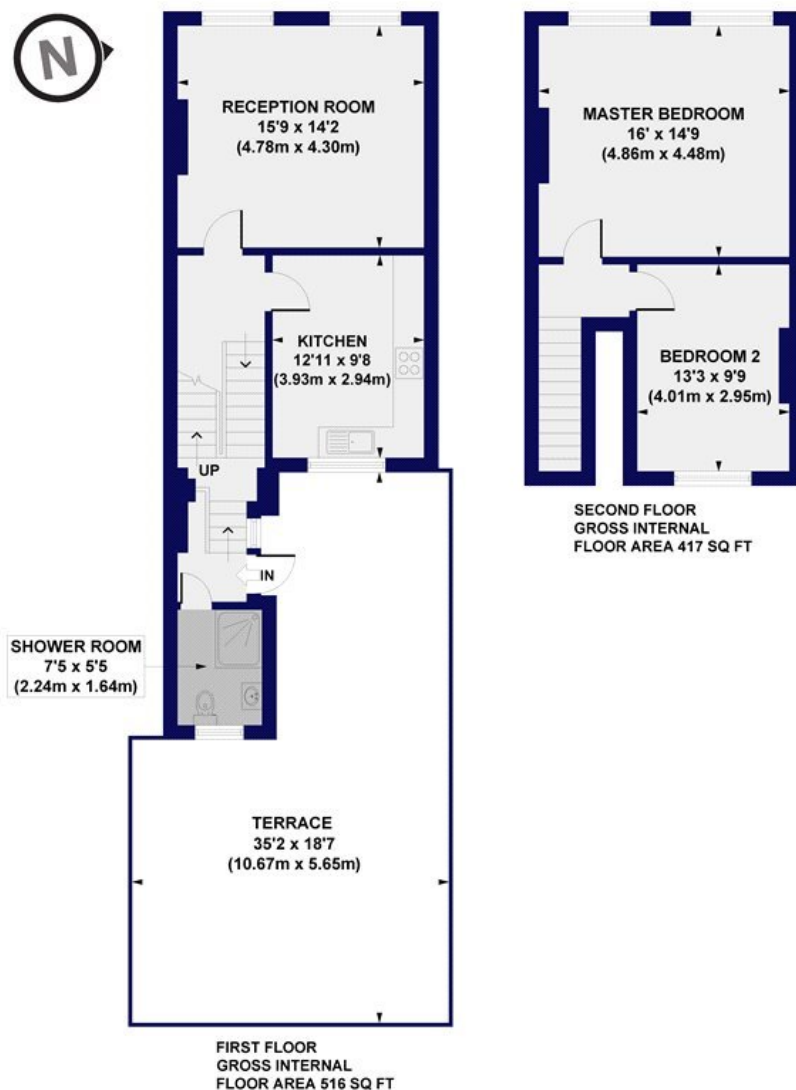

All measurements of walls, doors, windows, fittings and appliances, including their size and location, are shown as standard sizes and do not constitute any warranty or representation by the seller, their agent or CP Creative. Any intending purchaser must satisfy himself by inspection or otherwise as to the correctness of the information contained in these plans. This plan is for illustrative purposes only and should be used as such by any prospective purchasers.

**Winkworth**

This floorplan is for illustration purposes only and is not to scale. The position and size of doors, windows, appliances and other features are approximate.

**Deposit:** 5 weeks' rent

**Holding Deposit:** 1 week's rent

**Council Tax Band:** TBC

Where no figures are shown, we have been unable to ascertain the information. All figures that are shown were correct at the time of printing.

Putney | 020 8877 1000 | putney@winkworth.co.uk

**Winkworth**

for every step...

winkworth.co.uk

Winkworth wishes to inform prospective buyers and tenants that these particulars are a guide and act as information only. All our details are given in good faith and believed to be correct at the time of printing but they don't form part of an offer or contract. No Winkworth employee has authority to make or give any representation or warranty in relation to this property. All fixtures and fittings, whether fitted or not are deemed removable by the vendor unless stated otherwise and room sizes are measured between internal wall surfaces, including furnishings.