



ASHBURNHAM GROVE, GREENWICH, LONDON, SE10
£350,000 LEASEHOLD

A REALLY WELL PRESENTED STUDIO FLAT, FOUND ON THE LOWER GROUND FLOOR OF THIS PRETTY VICTORIAN HOUSE LOCATED IN WEST GREENWICH, ON THE ASHBURNHAM TRIANGLE. MEASURING CIRCA 456 SQ FT AND FEATURING A SMALL PRIVATE TERRACE TO THE REAR.

Greenwich | 02030533033 | greenwich@winkworth.co.uk

Winkworth

for every step...

winkworth.co.uk



DESCRIPTION:

A really well presented studio flat, which is found on the lower ground floor of this pretty Victorian house that is located in West Greenwich, on the Ashburnham Triangle. Measuring circa 456 sq. ft and featuring a small private terrace to the rear.

In good decorative order the property briefly comprises a 14ft studio room and a lovely 14ft kitchen breakfast room. Whilst this room is in good condition it's likely that any new owner may want to reconfigure. From here there are double doors opening onto a lovely private terraced area. To the rear is an inner lobby and then a lovely bathroom. It's worth mentioning too that the property has sole use of the front garden and a large under stairs storage area. The property is being offered chain free!

AT A GLANCE

- studio flat
- circa 456 sq. ft
- lower ground floor
- private front garden
- rear terrace
- West Greenwich location
- Ashburnham Tringle
- 14ft studio room
- 14ft kitchen breakfast room





Lower Ground Floor

Approx. 42.4 sq. metres (456.7 sq. feet)

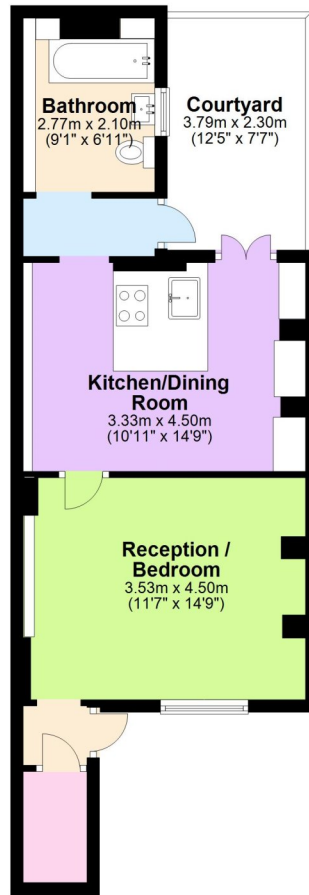

Total area: approx. 42.4 sq. metres (456.7 sq. feet)

This floorplan is for illustration purposes only and is not to scale. The position and size of doors, windows, appliances and other features are approximate.

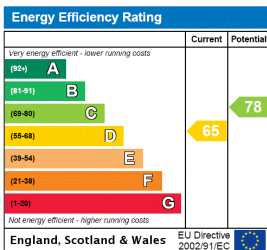

Tenure: Leasehold

Term: 90 year and 6 months

Service Charge: £600 per annum

Ground Rent: £ 0 Annually (subject to increase)

Council Tax Band: B

Where no figures are shown, we have been unable to ascertain the information. All figures that are shown were correct at the time of printing.

Greenwich | 02030533033 | greenwich@winkworth.co.uk

Winkworth

for every step...

winkworth.co.uk

Winkworth wishes to inform prospective buyers and tenants that these particulars are a guide and act as information only. All our details are given in good faith and believed to be correct at the time of printing but they don't form part of an offer or contract. No Winkworth employee has authority to make or give any representation or warranty in relation to this property. All fixtures and fittings, whether fitted or not are deemed removable by the vendor unless stated otherwise and room sizes are measured between internal wall surfaces, including furnishings.