



RIVERSIDE HOUSE, READING, BERKSHIRE, RG1 6BJ  
**£1,795 PER MONTH FURNISHED**

## FIRST FLOOR EXECUTIVE TWO DOUBLE BEDROOM APARTMENT WITH LARGE PRIVATE TERRACE

Reading | 0118 4022 300 | [reading@winkworth.co.uk](mailto:reading@winkworth.co.uk)

**Winkworth**

for every step...

[winkworth.co.uk](http://winkworth.co.uk)





## DESCRIPTION:

First floor executive two double bedroom apartment in this popular riverside development in Reading Town Centre. Offering excellent access to the mainline train station, bus routes and major transport links via the A329 and M4. Accommodation is well presented and comprises; an open plan living space with a modern fitted kitchen, master bedroom with en-suite shower room, an additional bedroom and a bathroom. The property further benefits from a large private terrace overlooking the Kennet & Avon canal, secure undercroft parking, intercom entry and lift access. Available now. Furnished.

## AT A GLANCE

- Large private terrace
- Two double bedrooms
- Two bathrooms
- Council tax band D
- Allocated undercroft parking
- Available now
- Furnished



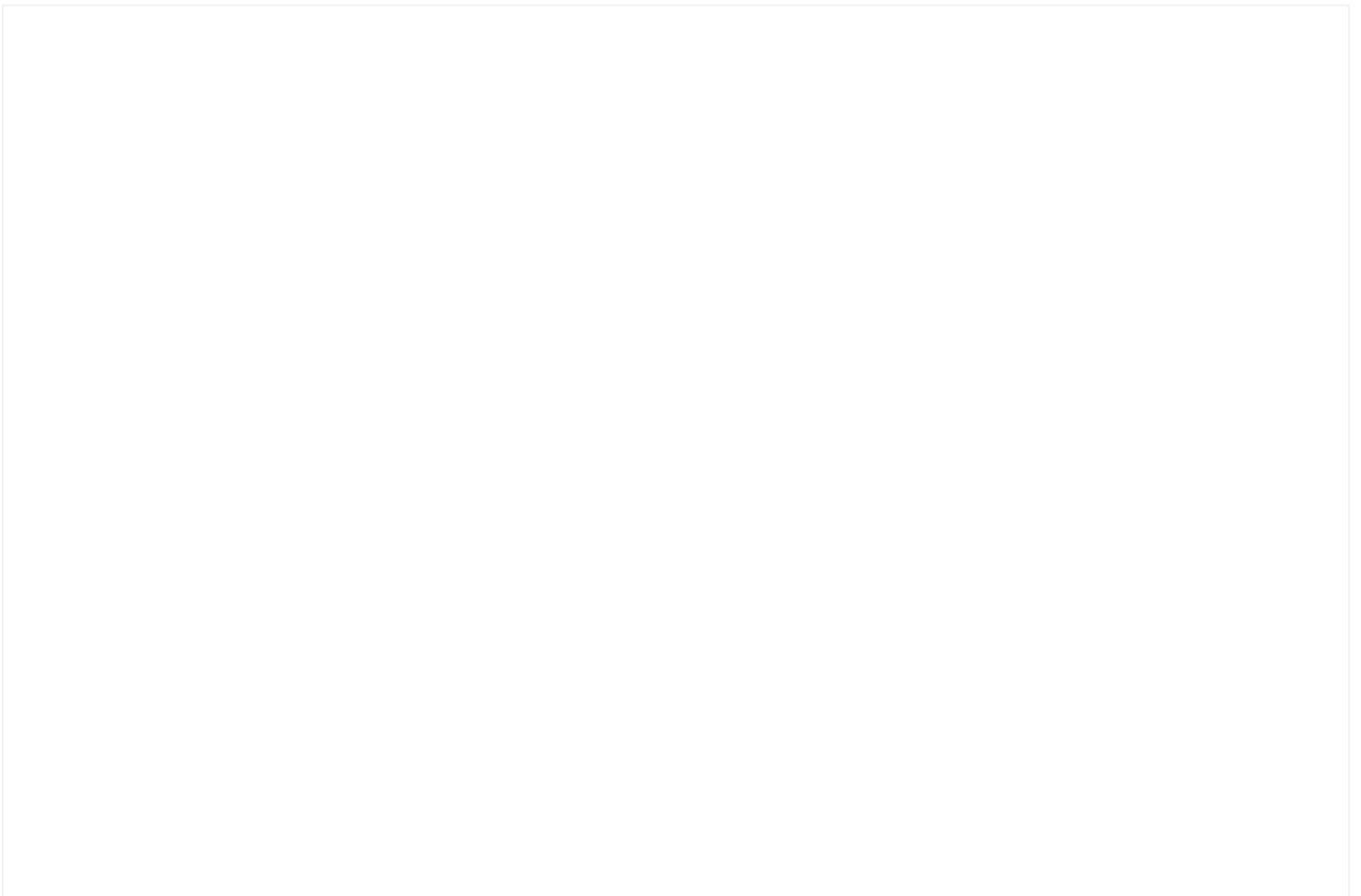



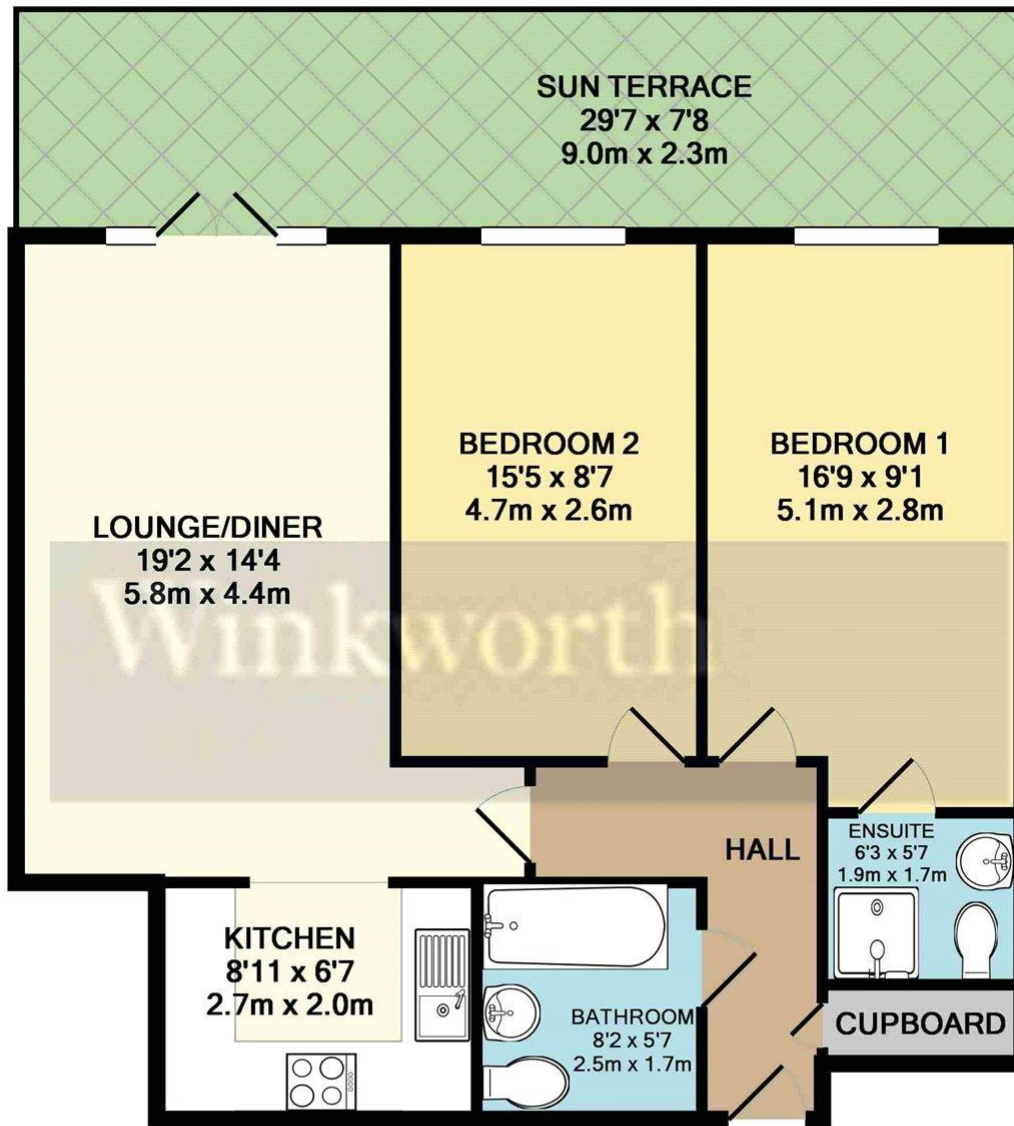

TOTAL APPROX. FLOOR AREA 675 SQ.FT. (62.7 SQ.M.)

Whilst every attempt has been made to ensure the accuracy of the floor plan contained here, measurements of doors, windows, rooms and any other items are approximate and no responsibility is taken for any error, omission, or mis-statement. This plan is for illustrative purposes only and should be used as such by any prospective purchaser. The services, systems and appliances shown have not been tested and no guarantee as to their operability or efficiency can be given  
 Made with Metropix ©2018

This floorplan is for illustration purposes only and is not to scale. The position and size of doors, windows, appliances and other features are approximate.

**Deposit:** £2,071.15

**Holding Deposit:** £414.23

**Council Tax Band:** D

Where no figures are shown, we have been unable to ascertain the information. All figures that are shown were correct at the time of printing.

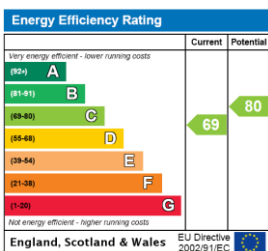

Reading | 0118 4022 300 | [reading@winkworth.co.uk](mailto:reading@winkworth.co.uk)



for every step...

[winkworth.co.uk](http://winkworth.co.uk)

Winkworth wishes to inform prospective buyers and tenants that these particulars are a guide and act as information only. All our details are given in good faith and believed to be correct at the time of printing but they don't form part of an offer or contract. No Winkworth employee has authority to make or give any representation or warranty in relation to this property. All fixtures and fittings, whether fitted or not are deemed removable by the vendor unless stated otherwise and room sizes are measured between internal wall surfaces, including furnishings.