



CHURCHILL GARDENS, SW1V

£499,950

LEASEHOLD

At a glance...

- 3 Bedrooms
- Large Reception
- Balcony
- Own Front Door
- In Need of Refurbishment
- Council Tax Band: D

Winkworth

for every step...



Energy Efficiency Rating		
	Current	Potential
Very energy efficient - lower running costs		
(92+) A		
(81-91) B		
(69-80) C		75
(55-68) D	58	
(39-54) E		
(21-38) F		
(1-20) G		
Not energy efficient - higher running costs		
England, Scotland & Wales	EU Directive 2002/91/EC	

CHURCHILL GARDENS, SW1V

£499,950

LEASEHOLD

A large, bright 3 bedroom duplex flat in need of complete refurbishment. The flat is accessed via its own front door and the accommodation is over the 2nd and 3rd floors. Currently configured with 3 good bedrooms, bathroom and cloakroom upstairs and separate kitchen and large reception room with balcony downstairs.

Covering some 849 square feet the flat also includes heating and hot water within its service charges.

Gifford House is located close to the amenities on Lupus Street, Pimlico tube station and the River Thames.

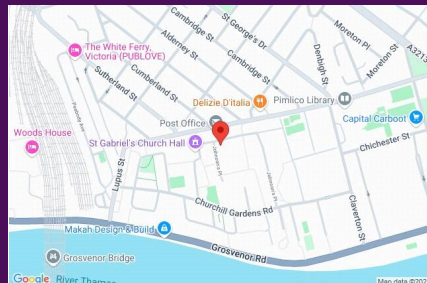

winkworth wishes to inform prospective buyers and tenants that these particulars are a guide and act as information only. All our details are given in good faith and believed to be correct at the time of printing but they don't form part of an offer or contract. No winkworth employee has authority to make or give any representation or warranty in relation to this property. All fixtures and fittings, whether fitted or not are deemed removable by the vendor unless stated otherwise and room sizes are measured between internal wall surfaces - including fire-chimneys.

Gifford House, SW1

Approx. Gross Internal Area
849 Sq Ft - 78.87 Sq M

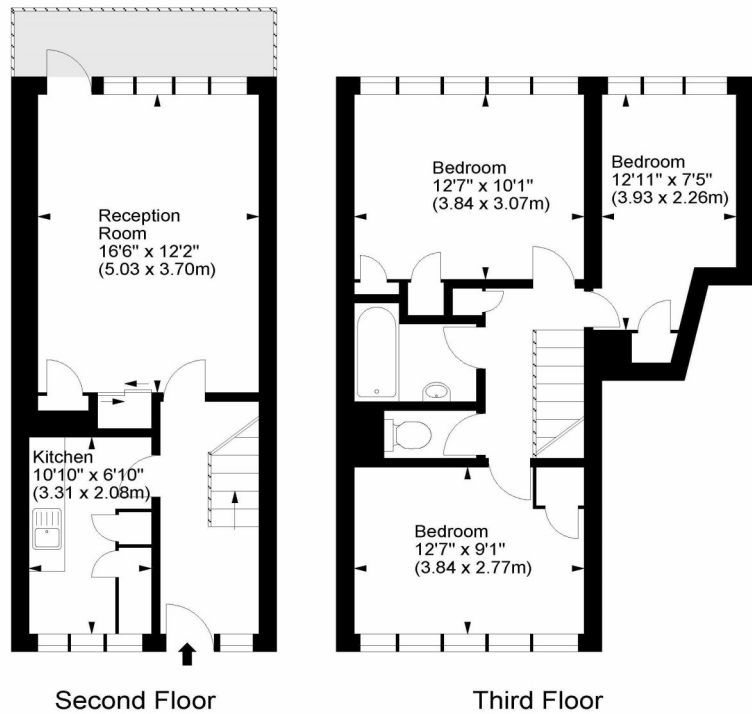

For illustration purposes only. Not to scale.
All measurements are taken and shown at floor level.
www.r3photography.co.uk © Photography / Floor Plans / Lease Plans / EPCs



Pimlico & Westminster

020 7828 1786

pimlico@winkworth.co.uk

winkworth.co.uk/pimlico-westminster

Winkworth

for every step...