



HAYWARD GARDENS, SW15
£3,250 PER MONTH FURNISHED

A beautifully presented four bedroom apartment benefiting from a wide entrance hall, reception room with west facing balcony, modern kitchen and bathroom and four double bedrooms

Southfields | 020 8877 1000 | southfields@winkworth.co.uk

Winkworth

for every step...

winkworth.co.uk



DESCRIPTION:

A beautifully presented four bedroom apartment benefiting from a wide entrance hall, reception room with west facing balcony, modern kitchen and bathroom and four double bedrooms.

The property is located on the top floor of a low rise building and offers spacious bright accommodation with generous built in storage.

Hayward Gardens is situated within a quiet cul-de-sac. The green open spaces of Putney Heath leading onto Wimbledon Common and Richmond Park are just a short walk away. Local bus routes, Putney High Street, Mainline Station, and East Putney Tube are also close by.

ACCOMMODATION

Long Let, 4 Bedrooms, 1 Reception Rooms, 1 Bathrooms, Flat/Apartment, Upper Floor without Lift, Balcony, Communal Gardens, Residents Parking, Purpose Built, Sharers, Furnished, 865 Approx Sq Ft



Hayward Gardens, SW15
Approx. Gross Internal Floor Area 865 sq. ft / 80.38 sq. m

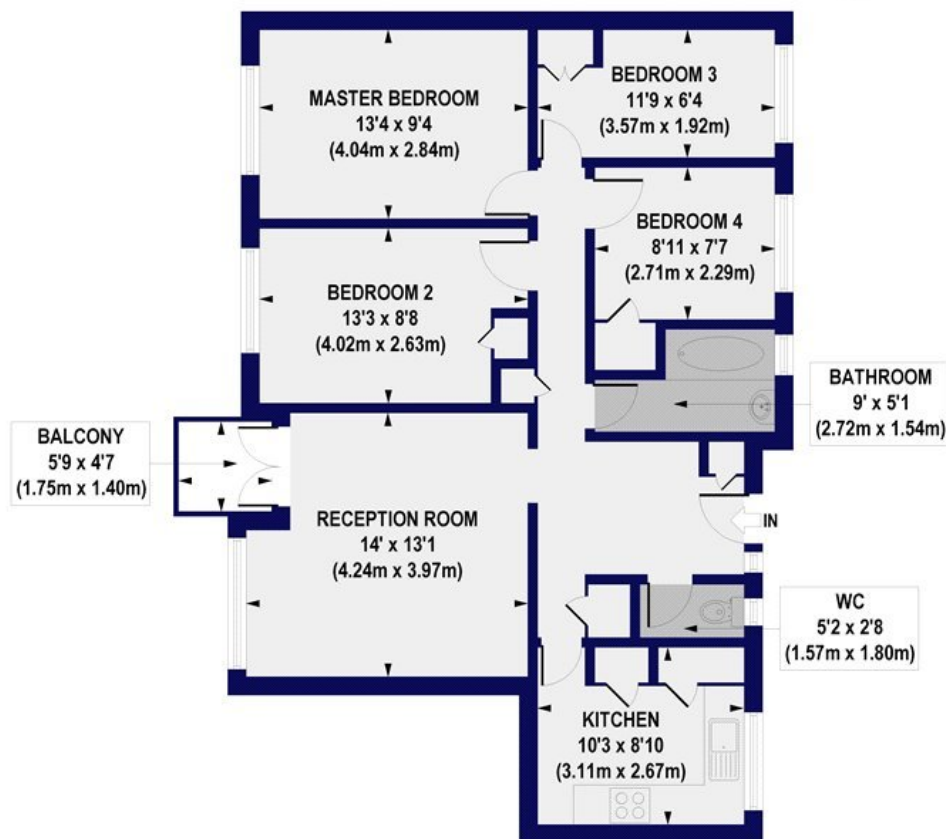

SECOND FLOOR

All measurements of walls, doors, windows, fittings and appliances, including their size and location, are shown as standard sizes and do not constitute any warranty or representation by the seller, their agent or CP Creative. Any intending purchaser must satisfy himself by inspection or otherwise as to the correctness of the information contained in these plans. This plan is for illustrative purposes only and should be used as such by any prospective purchasers.

Winkworth

This floorplan is for illustration purposes only and is not to scale. The position and size of doors, windows, appliances and other features are approximate.

Southfields | 020 8877 1000 | southfields@winkworth.co.uk

Winkworth

for every step...

winkworth.co.uk

Winkworth wishes to inform prospective buyers and tenants that these particulars are a guide and act as information only. All our details are given in good faith and believed to be correct at the time of printing but they don't form part of an offer or contract. No Winkworth employee has authority to make or give any representation or warranty in relation to this property. All fixtures and fittings, whether fitted or not are deemed removable by the vendor unless stated otherwise and room sizes are measured between internal wall surfaces, including furnishings.