



LADBROKE GROVE, W10  
£425,000 LEASEHOLD

**A CHARMING WELL PROPORTIONED STUDIO FLAT  
IN A FANTASTIC LOCATION CLOSE TO LADBROKE  
GROVE AND PORTOBELLO ROAD**

North Kensington, 020 7792 5000, northkensington@winkworth.co.uk

**Winkworth**

for every step...

*winkworth.co.uk*

## DESCRIPTION:

Located moments from Portobello Road and Golborne Road, lies this fantastic studio flat situated on the lower ground floor. The property comprises of a sizable studio room with a large bay window, separate kitchen and bathroom. Ladbroke Grove is ideally located for the fashionable restaurants, shops and bars of North Kensington and Notting Hill and the ever - famous Portobello Market and a short walk to Ladbroke Grove underground.

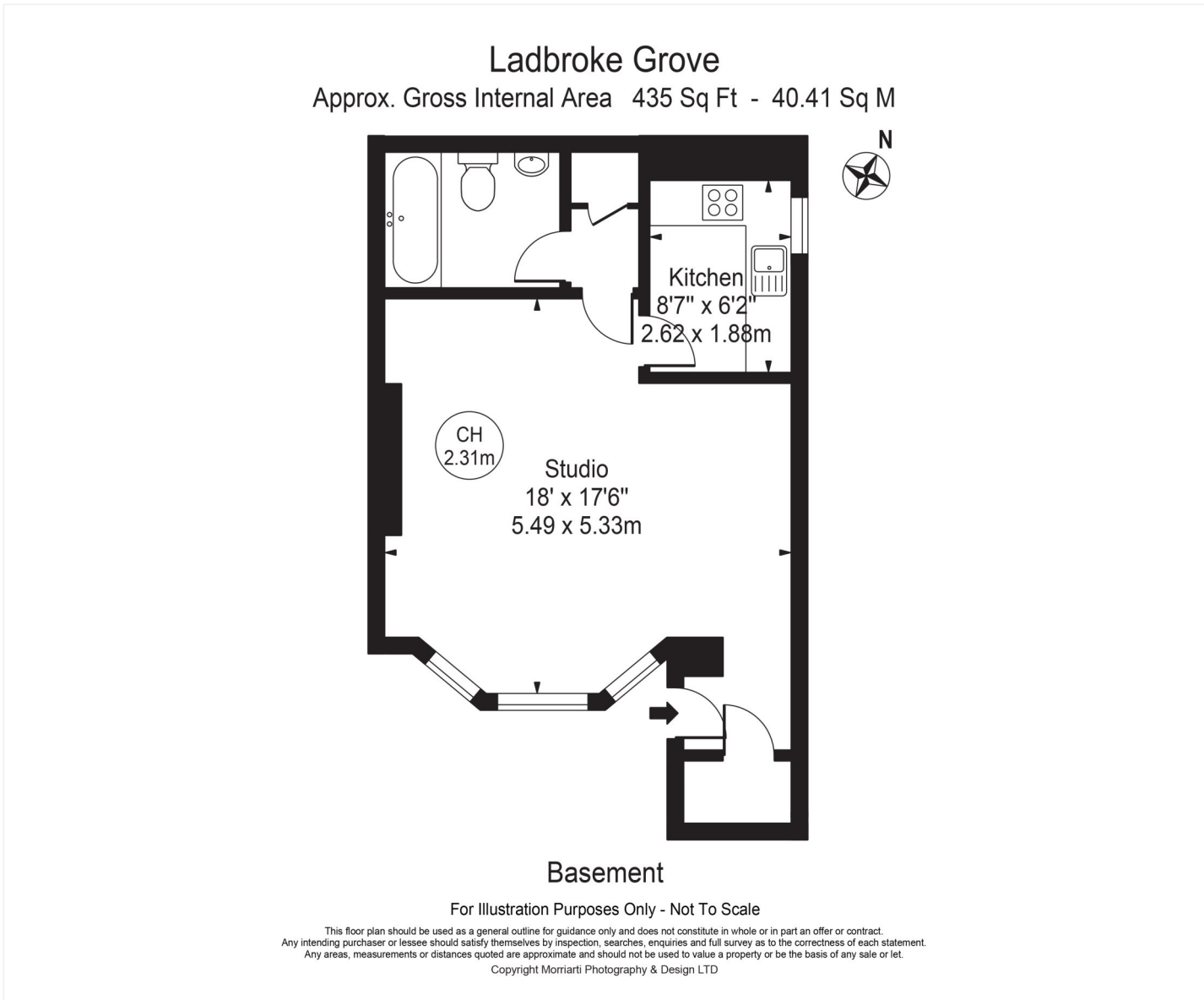

This floorplan is for illustration purposes only and is not to scale. The position and size of doors, windows, appliances and other features are approximate.

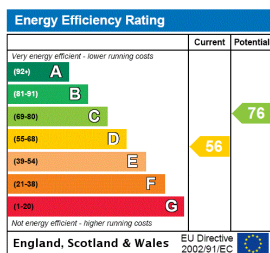

**Tenure:** Leasehold

**Term:** 87 year and 11 months

**Service Charge:** £1501 per annum

**Ground Rent:** £ 100 Annually

**Council Tax Band:** RBKC Band B

Where no figures are shown, we have been unable to ascertain the information. All figures that are shown were correct at the time of printing.

North Kensington | 020 7792 5000 | northkensington@winkworth.co.uk



for every step...

winkworth.co.uk

Winkworth wishes to inform prospective buyers and tenants that these particulars are a guide and act as information only. All our details are given in good faith and believed to be correct at the time of printing but they don't form part of an offer or contract. No Winkworth employee has authority to make or give any representation or warranty in relation to this property. All fixtures and fittings, whether fitted or not are deemed removable by the vendor unless stated otherwise and room sizes are measured between internal wall surfaces, including furnishings.