



DEACONS HILL ROAD, BOREHAMWOOD, HERTFORDSHIRE, WD6

**£330,000 LEASEHOLD**

## TWO DOUBLE BEDROOM FIRST FLOOR FLAT WITH BALCONY IN ELSTREE

Borehamwood | 020 8953 8899 | borehamwood@winkworth.co.uk





Winkworth

**DESCRIPTION:**

Located at the beginning of the highly sought after Deacons Hill Road, within walking distance of the Thameslink station and Borehamwood high street is this two double bedroom first floor purpose built flat.

Offered for sale "Chain Free" the property offers approaching 700 square feet of bright and well-proportioned accommodation and would be ideal for downsizers, first time buyers or buy to let investors alike.

**AT A GLANCE**

- Two Double Bedrooms
- Chain Free
- Westerly Facing Balcony
- Residents Parking
- 989 Year Lease
- Gas Central Heating
- Double Glazed
- 682 Square Feet



Winkworth



Winkworth





Winkworth



Winkworth



Winkworth



Winkworth



Winkworth

Approximate Gross Internal Area = 63.4 sq m / 682 sq ft

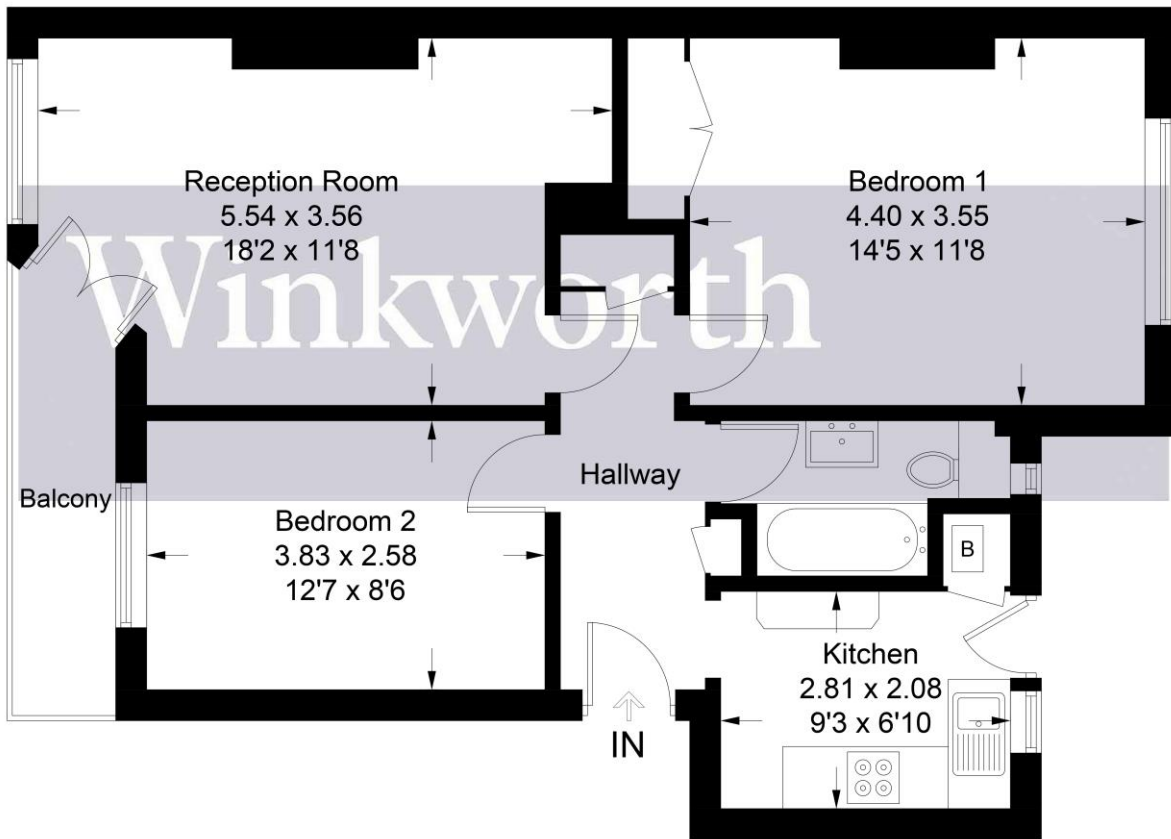
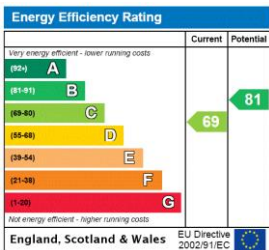

Illustration for identification purposes only, measurements are approximate, not to scale. Winkworth © 2024 (ID1105927)

This floorplan is for illustration purposes only and is not to scale. The position and size of doors, windows, appliances and other features are approximate.



**Tenure:** Leasehold

**Term:** 988 year and 10 months

**Service Charge:** £0 per annum

**Ground Rent:** £ 0 Annually (subject to increase)

**Council Tax Band:** D

Where no figures are shown, we have been unable to ascertain the information. All figures that are shown were correct at the time of printing.