



LONSDALE ROAD, W11
£595 PER WEEK (£2,578.33 PCM) UNFURNISHED

AN IMMACULATE AND VERY CHARMING ONE GARDEN FLAT ON THE FIRST FLOOR OF THIS WELL MAINTAINED AND PRETTY PERIOD CONVERSION ON THIS SOUGHT-AFTER LOCATION

Notting Hill Lettings | 0207 727 3227 | nottinghill@winkworth.co.uk

Winkworth

for every step...

winkworth.co.uk



DESCRIPTION:

An immaculate and very charming one garden flat on the first floor of this well maintained and pretty period conversion on this sought after location. The property comprises: Hallway - South facing reception room with French doors leading out to fantastic south facing private garden, separate fitted kitchen, spacious double bedroom, and bathroom - The property benefits from wood floors throughout. Available unfurnished or part furnished.

Utilities:

Electricity – Mains

Water – Mains

Sewerage – Mains

Heating – Gas

Broadband <https://checker.ofcom.org.uk/en-gb/broadband-coverage>

Mobile Coverage <https://checker.ofcom.org.uk/en-gb/mobile-coverage>

LOCATION:

Lonsdale Road is an attractive residential street of colourfully painted houses, perfectly located directly behind Westbourne Grove's most fashionable stretch, running from Ledbury Road to Portobello with many of Notting Hill's most popular restaurants, boutiques and bars just seconds away and within easy walking distance of Notting Hill Gate.



LONSDALE ROAD, W11

Approx. gross internal area
533 Sq Ft. / 49.5 Sq M.

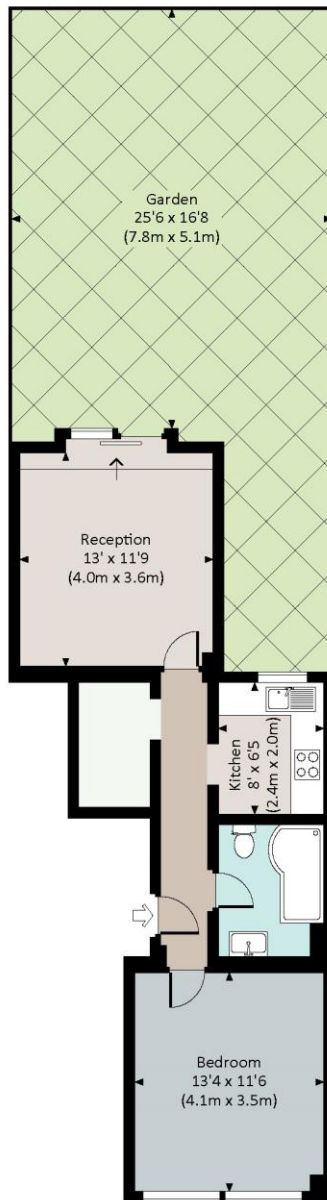

GROUND FLOOR



All measurements have been made in accordance with RICS Code of Measuring Practice which are approximate only and only for illustrative purposes. For the avoidance of doubt, Dowling Jones Design shall not be liable for any reliance on these measurements. © 2017 www.dowlingjones.com 020 7610 9933

This floorplan is for illustration purposes only and is not to scale. The position and size of doors, windows, appliances and other features are approximate.

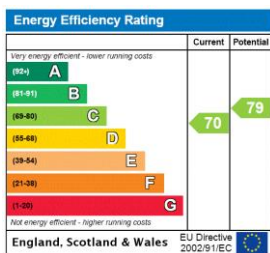

Deposit: £2,975

Holding Deposit: £595

Council Tax Band: D (RBKC)

Where no figures are shown, we have been unable to ascertain the information. All figures that are shown were correct at the time of printing.

Notting Hill Lettings | 0207 727 3227 | nottinghill@winkworth.co.uk



for every step...

winkworth.co.uk

Winkworth wishes to inform prospective buyers and tenants that these particulars are a guide and act as information only. All our details are given in good faith and believed to be correct at the time of printing but they don't form part of an offer or contract. No Winkworth employee has authority to make or give any representation or warranty in relation to this property. All fixtures and fittings, whether fitted or not are deemed removable by the vendor unless stated otherwise and room sizes are measured between internal wall surfaces, including furnishings.