



FLAT 127, QUEENSLAND ROAD, LONDON, N7
£599,995 LEASEHOLD

A STUNNING, TWO DOUBLE BEDROOMS,
TWO-BATHROOM MODERN APARTMENT SET
ON THE NINTH FLOOR OF THIS POPULAR

Highbury | 0207 989 7000 | highbury@winkworth.co.uk

Winkworth

winkworth.co.uk

See things differently



DESCRIPTION:

A stunning, two double bedrooms, two-bathroom modern apartment set on the ninth floor of this popular development in Islington, N7. Standing at an impressive 792 sqft, the property has been kept in excellent condition by the current owners. Both bedrooms are generous double bedrooms, the master includes built in storage and an ensuite. There is the beautifully presented open plan living, kitchen/dining room with the tastefully designed family bathroom which completes the internal accommodation.

This development also includes a gym, 24-7 concierge, lift access and communal gardens.

Located in the heart of N7, the property offers access to a fabulous array of amenities on Holloway Road, Upper Street, and the village-like amenities of Highbury Barn. The beautiful green open spaces of Highbury Fields are close by further adding to the appeal.

Queensland Road is a prestigious development adjacent to the Emirates Stadium on the borders of Holloway and Highbury. Transport links are exceptional, with Holloway Road (Piccadilly Line), Arsenal (Piccadilly Line), Highbury and Islington (Victoria Line, London Overground & National Rail) and Drayton

Winkworth



Winkworth

Queensland Road, N7
Approx. Gross Internal Floor Area 792 sq. ft / 73.60 sq. m

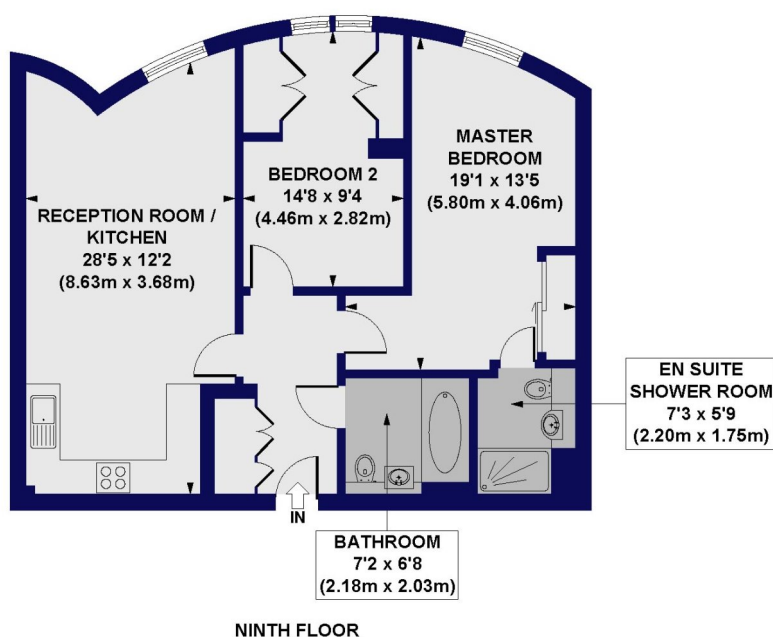

All measurements of walls, doors, windows, fittings and appliances, including their size and location, are shown as standard sizes and do not constitute any warranty or representation by the seller, their agent or CP Creative. Any intending purchaser must satisfy himself by inspection or otherwise as to the correctness of the information contained in these plans. This plan is for illustrative purposes only and should be used as such by any prospective purchasers.

Winkworth

This floorplan is for illustration purposes only and is not to scale. The position and size of doors, windows, appliances and other features are approximate.

Highbury | 0207 989 7000 | highbury@winkworth.co.uk

Winkworth

winkworth.co.uk

See things differently

Winkworth wishes to inform prospective buyers and tenants that these particulars are a guide and act as information only. All our details are given in good faith and believed to be correct at the time of printing but they don't form part of an offer or contract. No Winkworth employee has authority to make or give any representation or warranty in relation to this property. All fixtures and fittings, whether fitted or not are deemed removable by the vendor unless stated otherwise and room sizes are measured between internal wall surfaces, including furnishings.