



NORWOOD ROAD, LONDON, SE24
OFFERS IN EXCESS OF: £350,000 LEASEHOLD

A BEAUTIFULLY PRESENTED ONE-BEDROOM FLAT IN THE HEART OF HERNE HILL

Herne Hill | 0207 501 8950 | hernehill@winkworth.co.uk

Winkworth

for every step...

winkworth.co.uk



DESCRIPTION:

Situated in a charming Victorian conversion, this one-bedroom first-floor flat is flooded with natural light and offers an ideal blend of period charm and modern living. The property features a spacious reception room with elegant bay windows, a modern fitted kitchen, and a contemporary shower room. The bedroom is bright and generously proportioned, creating a tranquil retreat.

Perfectly located in central Herne Hill, you're just moments away from a vibrant array of restaurants, independent shops, and excellent transport links, including Herne Hill railway station (Victoria, Thameslink, Blackfriars). For outdoor enthusiasts, the stunning Brockwell Park and its iconic Lido are just a short stroll away.

Offered with no onward chain, this property is perfect for first-time buyers or investors seeking a quick and seamless purchase.





Norwood Road, SE24
 Approx. Gross Internal Floor Area 481 sq. ft / 44.65 sq. m

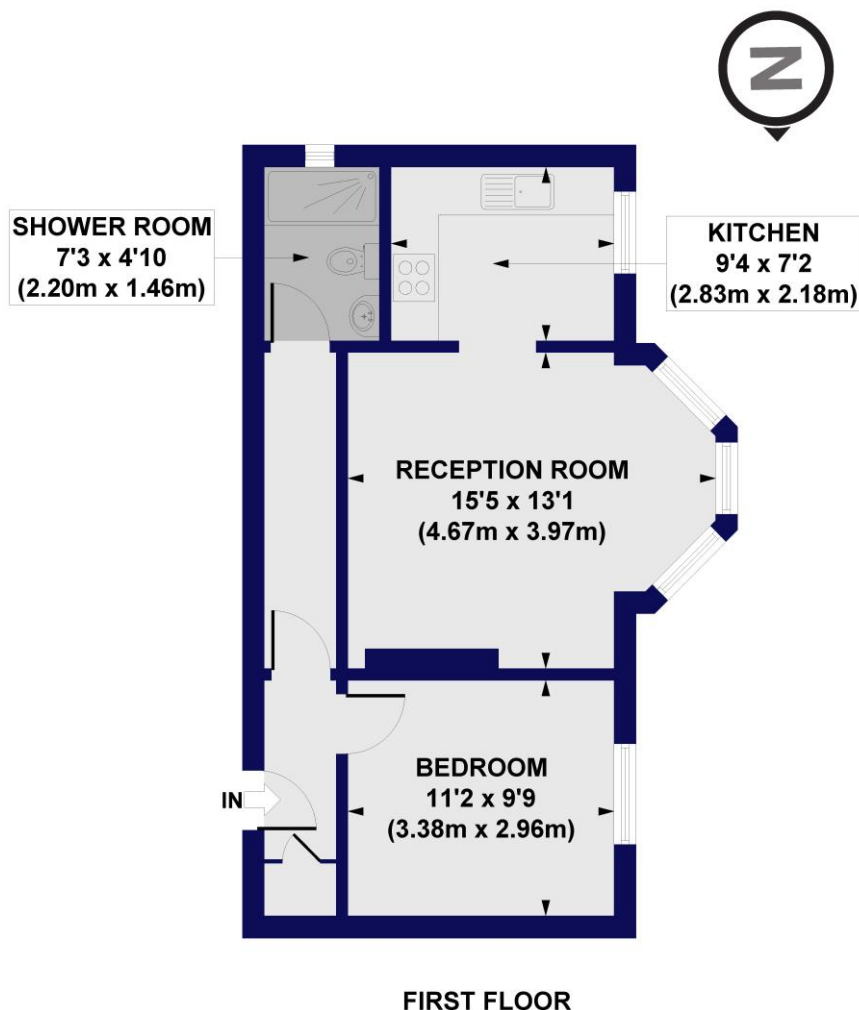

All measurements of walls, doors, windows, fittings and appliances, including their size and location, are shown as standard sizes and do not constitute any warranty or representation by the seller, their agent or CP Creative. Any intending purchaser must satisfy himself by inspection or otherwise as to the correctness of the information contained in these plans. This plan is for illustrative purposes only and should be used as such by any prospective purchasers.

Winkworth

This floorplan is for illustration purposes only and is not to scale. The position and size of doors, windows, appliances and other features are approximate.

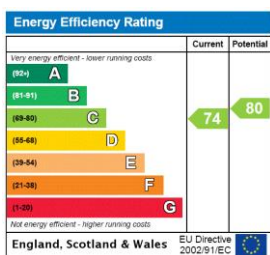

Tenure: Leasehold

Term: 158 year and 11 months

Service Charge: £2178 per annum

Council Tax Band: B

Where no figures are shown, we have been unable to ascertain the information. All figures that are shown were correct at the time of printing.

Herne Hill | 0207 501 8950 | hernehill@winkworth.co.uk



for every step...

winkworth.co.uk

Winkworth wishes to inform prospective buyers and tenants that these particulars are a guide and act as information only. All our details are given in good faith and believed to be correct at the time of printing but they don't form part of an offer or contract. No Winkworth employee has authority to make or give any representation or warranty in relation to this property. All fixtures and fittings, whether fitted or not are deemed removable by the vendor unless stated otherwise and room sizes are measured between internal wall surfaces, including furnishings.