



ROE LANE, ROE GREEN VILLAGE, KINGSBURY, LONDON, NW9  
**£360,000 LEASEHOLD - APPROX 52 YEARS REMAINING**

## 2 BEDROOM GROUND FLOOR MAISONETTE

Kingsbury | 020 8204 0000 | [kingsbury@winkworth.co.uk](mailto:kingsbury@winkworth.co.uk)

**Winkworth**

for every step...

[winkworth.co.uk](http://winkworth.co.uk)





**DESCRIPTION:** A charming ground-floor maisonette, offering a perfect blank canvas for first-time buyers, investors, or downsizers. This delightful home features two double bedrooms, a cosy reception room & kitchen, with a standout feature being the lush 100ft garden—a serene oasis ideal for relaxation or outdoor enjoyment. Nestled within a conservation area, it effortlessly blends period charm with modern character. A variety of acclaimed schools, transport links, and amenities are all a comfortable stroll away, whilst residents and their visitors will benefit from ample on street parking options. An internal viewing is highly recommended.



for every step...





**Winkworth**

for every step...

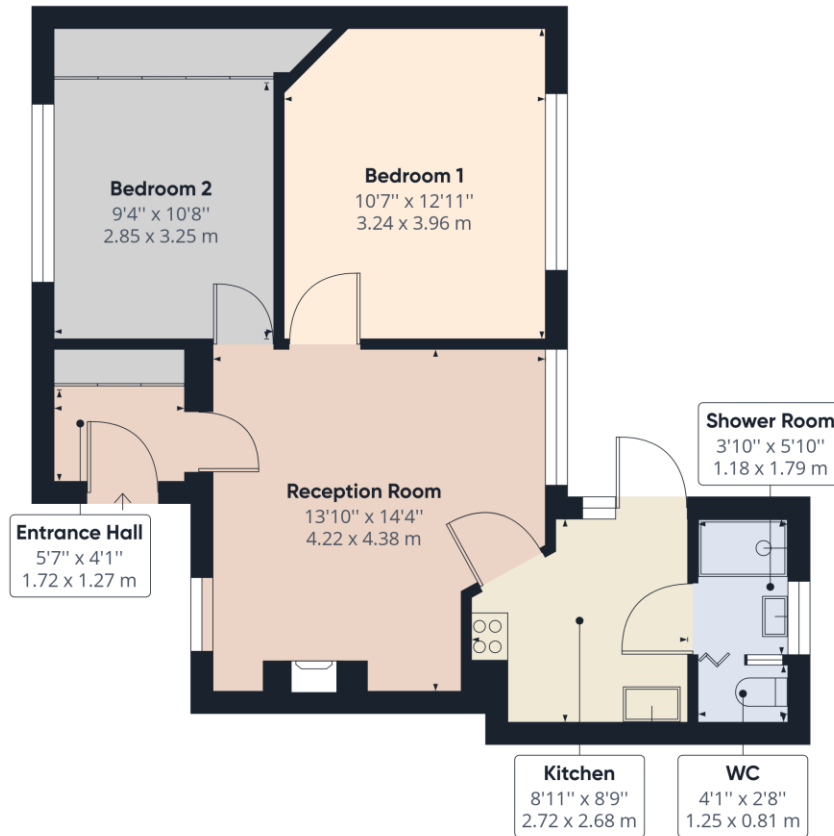

Approximate total area<sup>(1)</sup>  
576.52 ft<sup>2</sup>  
53.56 m<sup>2</sup>

(1) Excluding balconies and terraces

While every attempt has been made to ensure accuracy, all measurements are approximate, not to scale. This floor plan is for illustrative purposes only.

GIRAFFE360

This floorplan is for illustration purposes only and is not to scale. The position and size of doors, windows, appliances and other features are approximate.

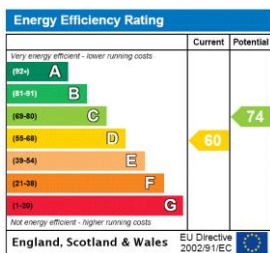

**Tenure:** Leasehold

**Term:** 52 year and 6 months

**Service Charge:** £0

**Ground Rent:** £ 75 Annually approx.

**Council Tax Band:** C - Brent

Where no figures are shown, we have been unable to ascertain the information. All figures that are shown were correct at the time of printing.

Winkworth

Kingsbury | 020 8204 0000 | kingsbury@winkworth.co.uk

for every step...

winkworth.co.uk

Winkworth wishes to inform prospective buyers and tenants that these particulars are a guide and act as information only. All our details are given in good faith and believed to be correct at the time of printing but they don't form part of an offer or contract. No Winkworth employee has authority to make or give any representation or warranty in relation to this property. All fixtures and fittings, whether fitted or not are deemed removable by the vendor unless stated otherwise and room sizes are measured between internal wall surfaces, including furnishings.